

Caster

높은이조절용
page 476 ~ 495



EPP SERIES

A 40-100 SERIES

A 120-150 SERIES

AR SERIES

AS SERIES



AD SERIES



AF SERIES



CT-F SERIES



CT-S SERIES

저상형
page 494 ~ 495



LGP1F SERIES

컴팩트 이동형
page 496 ~ 503



LGD 60.75



LGD 100



LGP1 SERIES



JS SERIES

정전기 방지용
page 504 ~ 505



WEU SERIES

기동성이동용
page 506 ~ 507



MPH SERIES

Y K C T

경하중용
page 508 ~ 511



SL SERIES



SM SERIES

중하중용
page 512 ~ 517



SH SERIES



G80 SERIES



CK SERIES

고하중용
page 518 ~ 525



PH-80-100



PH-125-200



PH40 SERIES



PH40T SERIES

회전형
page 526 ~ 526



GTAS4-AF

기타
page 527 ~ 527



PHLS40

2차전지용
page 528 ~ 541



A 40-100



A 120-150



LGD 60.75 SERIES



JS SERIES



MPH SERIES



PH-80-100



PH-125-200

CASTER

YEUNG KWANG TECH

산업용 YK캐스터



높낮이조절용캐스터

충격흡수용캐스터

회전,고정,브레이크

경.중.고하중 물류용

회전/고정/브레이크/경중고하중 물류용 캐스터

응용 소프트웨어 엔지니어는 고객에게 맞는 솔루션을 제공
 사용자는 모든 표준 제품의 3D 솔리드 모델 및 2D 도면을 다운로드 가능
 고객의 엄격한 요구 사항을 충족시키기 위해 전문적인 엔지니어링 설계 및 지원을 제공
 신제품 프로토타입 디자인 서비스 제공
 공장 및 고객의 특정 표준을 충족시키기 위해 제품에 대한 표준 테스트 제공

YK캐스터 고객지원서비스

솔루션 제공

도면 다운로드

표준 테스트제공



제품특징 DISTINCTION

제품은 알루미늄 주조로 제작된 몸체, 단조 및 프레스로 제작한 상판, 특수 혼합한 사출 휠, 내부식성 및 방진성이 뛰어난 합성 고무, 그리고 높낮이 조절이 편리한 핸들로 구성됩니다.
장점 : 상판과 몸체 사이에 볼베어링을 상하로 삽입하여 마찰력을 최소화 하였으며 360° 회전이 가능하여 아주 좁은 공간에서도 사용이 편리하며 방향성, 이동성, 높낮이 조절 및 방진성을 포함한 멀티 기능을 일체화 시켰습니다.



제품성능 FUNCTION

사용상의 편리를 위하여 기능을 개선함으로써 손과 스패너를 자유자재로 사용하여 높낮이를 손쉽게 조절할 수 있습니다.



영광테크는 고객의 요구에 빠르게 대응하겠습니다.

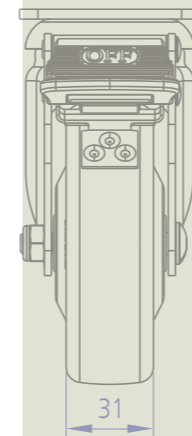

낙하충격시험기 Falling Weight Impact Testing Machine

캐스터의 충격 저항성능이 품질 요구 사항을 충족하는지 테스트합니다.

염수분무부식시험기 Salt Spray Corrosion Testing Machine

금속 부품 표면처리의 내부식성이 품질 기준을 충족하는지 테스트합니다.

저항시험기 Resistance Measuring Instrument

폴리우레탄, 나일론, 고무, 플라스틱 및 기타 절연 재료를 사용한 휠의 전도성을 효과적으로 측정합니다.

캐스터 복합시험기 Caster Test Integrated Machine

제품의 실제 사용 상황을 시뮬레이션하여 캐스터의 하중 주행, 브레이크 장치, 조향성과 같은 지표가, 품질 요구 사항을 충족시키는지 테스트 합니다.



낙하충격시험기
Falling Weight Impact Testing Machine



염수분무부식시험기
Salt Spray Corrosion Testing Machine



저항시험기
Resistance Measuring Instrument



캐스터 복합시험기
Caster Test Integrated Machine



2d, 3d 및 상세한 내용은 홈페이지(www.yktec.co.kr) 참조

높낮이 조절용
YKCT-EPP SERIES

제품특징 FEATURES

- 손쉬운 이동과 고정 높낮이 조절, 방진 및 360도 회전 기능 일체화.
- Easy moving, fixing, adjustable height, anti-vibration and 360°rotation all-in-one.

적용범위 APPLICATION

- 경량 알루미늄 프로파일로 제작된 프레임
- 자동 판매기, ATM기
- 전기 콘트롤 패널 하부 받침대
- 스탠딩& 캐비닛& 오락기
- 기타 경량 프레임 사용
- A frame made of lightweight aluminum profiles.
- Vending machine, ATM machine.
- Electric control panel bottom support.
- Standing & Cabinet & Game console.
- Use for other lightweight frames.

모델설명 ORDERING CODE

YKCT - EPP 40 F/S

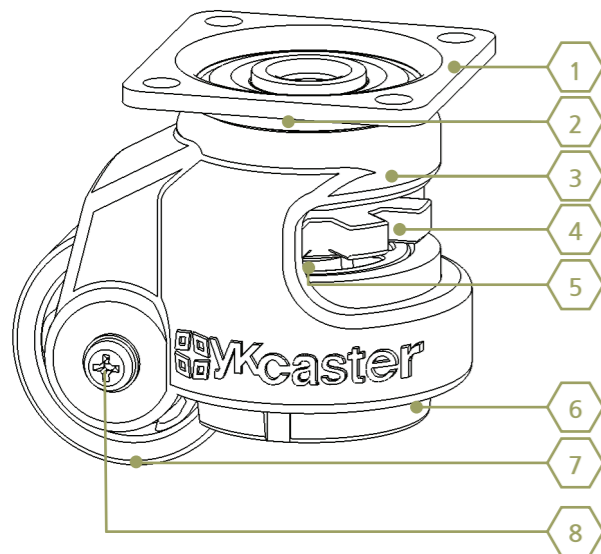
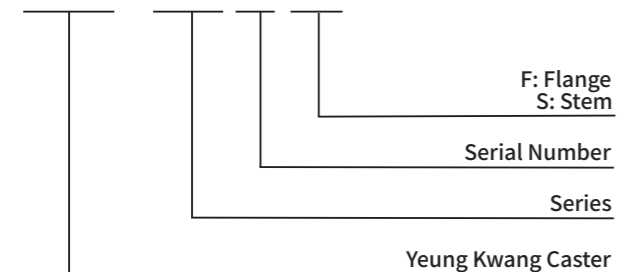

재질 MATERIAL & TREATMENT INFORMATION

No.	재질	표면처리
1	SPC & S45C	Black Coated
2	STB2	Ni-Cr
3	EPP	Black
4	PA6	Red
5	Swrch10A	Zn Galvanized
6	EPP	Black
7	PA6	Black
8	S10C	Zn Galvanized

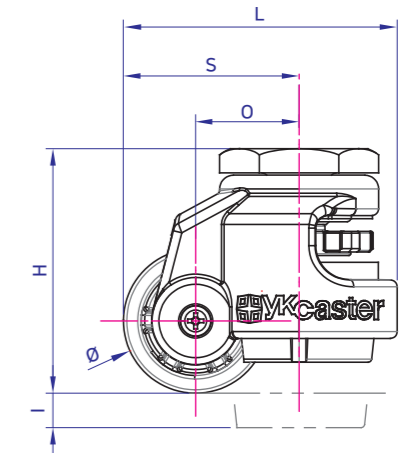
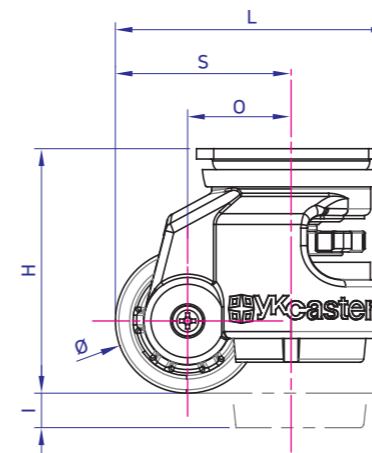
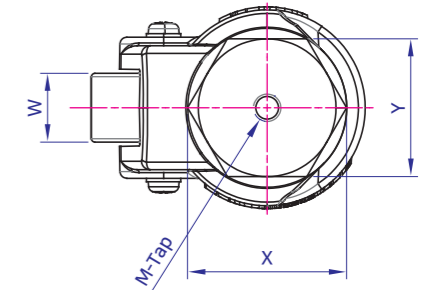
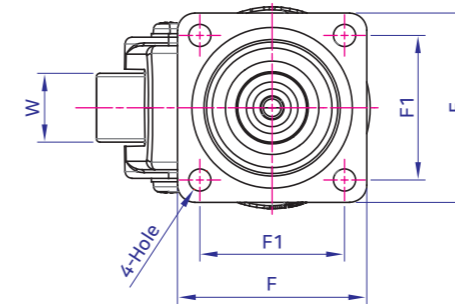

규격 DIMENSION

Code	자중 (Net weight) kg	Kg		Ø	W	F	F1	Hole	Tap (Order)	X	Y	H+H	L	S	O
		1EA	4EA												
YKCT-EPP40F	0.26	40	80	Ø40	19	55x55	42x42	Ø6.5	-	-	-	71+10	79.5	51	30
YKCT-EPP40S	0.24	40	80	-	-	-	-	-	M8	46	40	-	-	-	-

높낮이 조절용
YKCT-A 40~100

제품특징 FEATURES

- 손쉬운 이동과 고정 높낮이 조절, 방진 및 360도 회전 기능 일체화.
- 휠 커버 사용으로 오염이 적음.
- Easy moving, fixing, adjustable height, anti-vibration and 360°rotation all-in-one.
- Less contamination due to wheel cover use.

적용범위 APPLICATION

- 알루미늄 프로파일로 제작된 프레임, 자동화장비, 반도체 / 디스플레이 제조장비, 컨베이어등.
- Aluminium frames with profile, Automation equipment, Semiconductor / Display manufacturing. Conveyors, etc.

모델설명 ORDERING CODE

YKCT - A 40 F/S

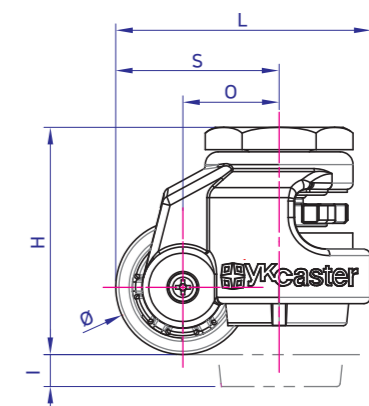
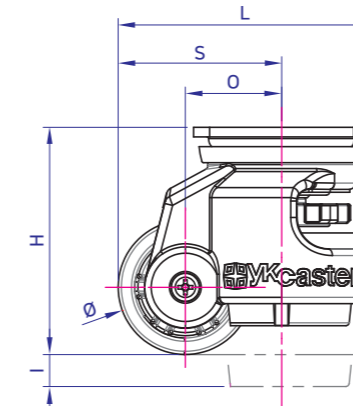
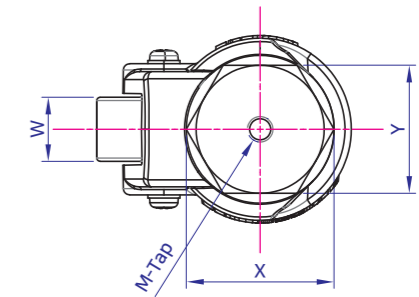
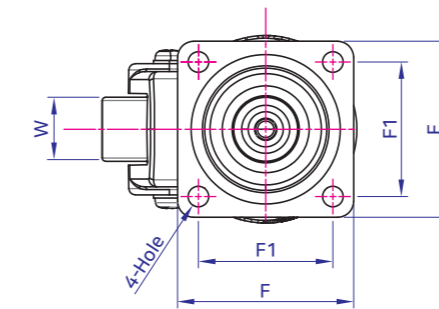
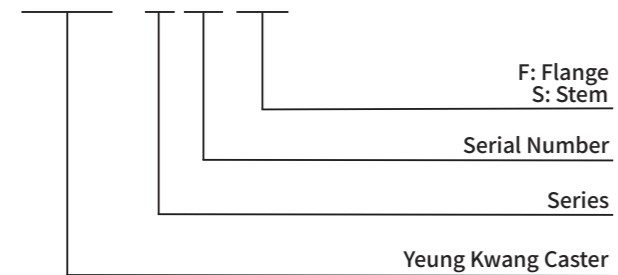

F

S

재질 MATERIAL & TREATMENT INFORMATION

No.	재질	표면처리
1	SPC & S45C	Black Coated / Zn Galvanized
2	STB2	Ni-Cr
3	ALDC12	Ivory / Powder Coated
4	PA6	Red
5	Swrch10A	Zn Galvanized
6	NBR	Black
7	PA6	Black
8	S10C	Zn Galvanized

※ Option: Wheel: Antistatic Poly Urethane

규격 DIMENSION

Code	자중 (Net weight) kg	Kg		Ø	W	F	F1	Hole	Tap (Order)	X	Y	H+H	L	S	O
		1EA	4EA												
YKCT-A40F	0.36	50	100	Ø40	19	55x55	42x42	Ø6.5	-	-	-	71+10	79.5	51	30
YKCT-A40S	0.37								M8 (M12)	46	40				
YKCT-A60F	0.67	250	500	Ø50	25	73x73	58x58	Ø7 (Ø8.5)	-	-	-	82+10	97	60.5	35.5
YKCT-A60S	0.62								M12 (M16)	52	45				
YKCT-A80F	1.19	500	1000	Ø62	29	90x90	70x70	Ø9	-	-	-	103+10	121.6	76.6	45
YKCT-A80S	1.11								M12 (M16)	70	65				
YKCT-A100F	1.65	750	1500	Ø75	30	95x95	70x70	Ø11	-	-	-	120+12	141	90	53
YKCT-A100S	1.55								M16	70	65				

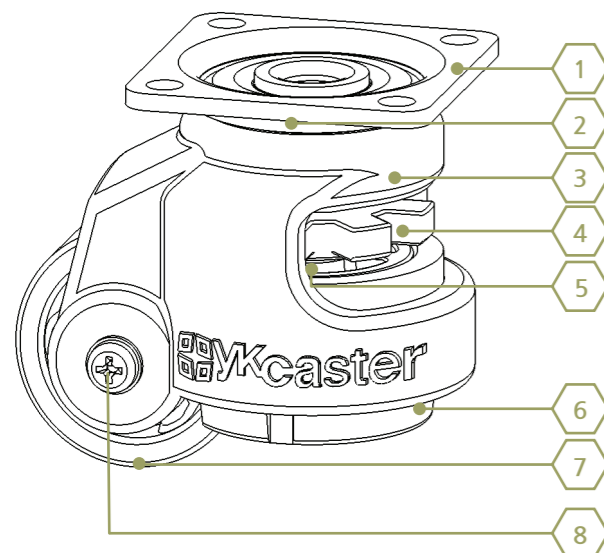

높낮이 조절용
YKCT-A 120~150

제품특징 FEATURES

- 손쉬운 이동과 고정 높낮이 조절, 방진 및 360도 회전 기능 일체화.
- 휠 커버 사용으로 오염이 적음.
- Easy moving, fixing, adjustable height, anti-vibration and 360°rotation all-in-one.
- Less contamination due to wheel cover use.

적용범위 APPLICATION

- 알루미늄 프로파일로 제작된 프레임, 자동화장비, 반도체 / 디스플레이 제조장비, 컨베이어등.
- Aluminium frames with profile, Automation equipment, Semiconductor / Display manufacturing, Conveyors, etc.

모델설명 ORDERING CODE

YKCT - A 120 F/S

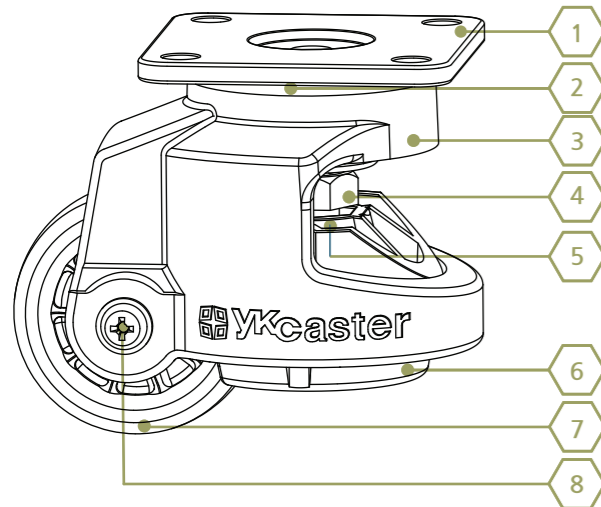
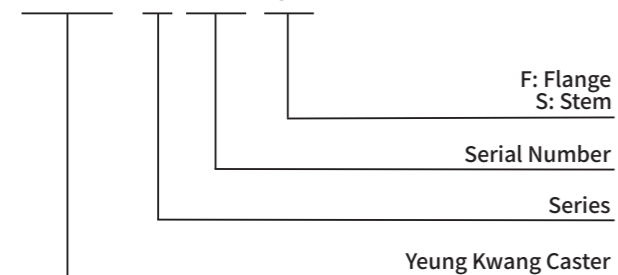

재질 MATERIAL & TREATMENT INFORMATION

No.	재질	표면처리
1	SPC & S45C	Black Coated
2	STB2	Ni-Cr
3	ALDC12	Hammertone
4	S45C	Zn Galvanized
5	Swrch10A	Zn Galvanized
6	120 PA6	Black
	150 ALDC12	Black
7	120 PA6	Black
	150 Mc Nylon	BLUE
8	S10C	Zn Galvanized

* Option: Wheel: Antistatic Poly Urethane
YKA-150F : SUS Bearing Type



120F



150FM



120S



120S



150FM

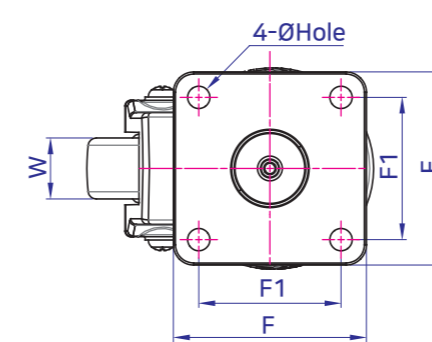

120F

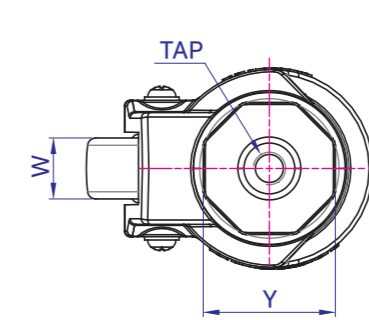

120S

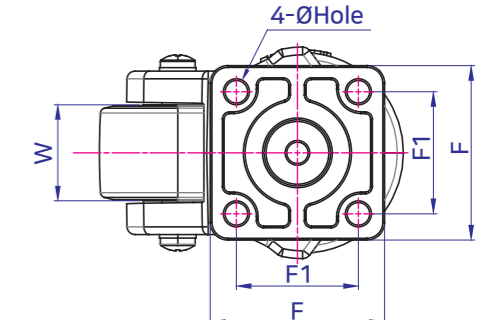

150F-M

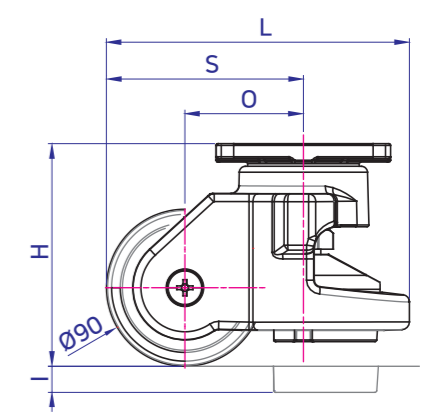
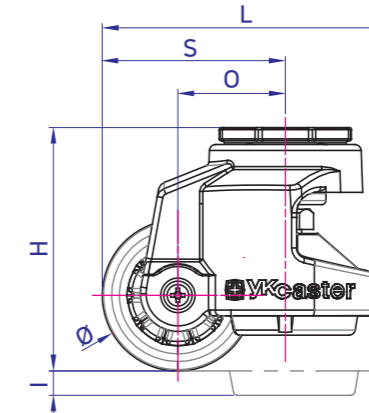
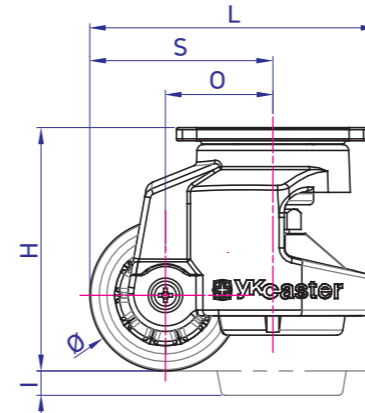

규격 DIMENSION

Code	자중 (Net weight) Kg	1EA	4EA	Ø	W	HOLE			TAP (Order)	X	Y	H+H	L	S	O
						F	F1	Hole							
YKCT-A120F	1.54	1.000	2.000	Ø75	30	95x95	70x70	Ø11	-	-	-	120+12	141	90	53
YKCT-A120S	1.55	-	-	-	-	-	-	-	M16	70	65	-	-	-	-
YKCT-A150FM	3.34	1.500	3.000	Ø90	55	100x100	70x70	Ø13	-	-	-	132+15	174	113	68

높낮이 조절용
YKCT-AR SERIES

제품특징 FEATURES

- 손쉬운 이동과 고정 높낮이 조절, 방진 및 360도 회전 기능 일체화.
- 휠 커버 사용으로 오염이 적음.
- Easy moving, fixing, adjustable height, anti-vibration and 360°rotation all-in-one.
- Less contamination due to wheel cover use.

적용범위 APPLICATION

- 알루미늄 프로파일로 제작된 프레임, 자동화장비, 반도체 / 디스플레이 제조장비, 컨베이어등.
- Aluminium frames with profile, Automation equipment, Semiconductor / Display manufacturing, Conveyors, etc.

모델설명 ORDERING CODE

YKCT - AR 60 F/S

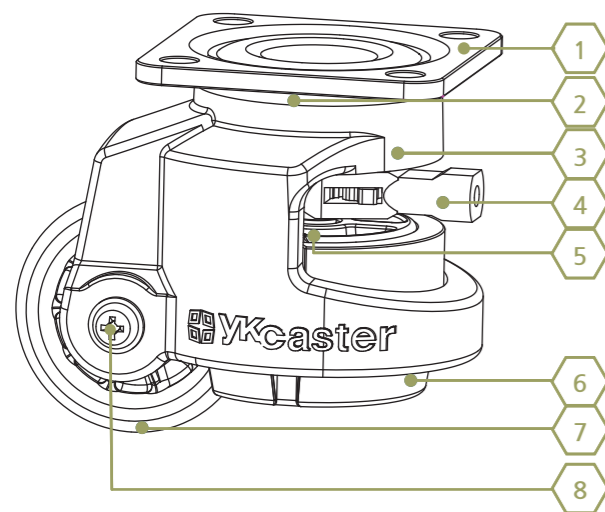
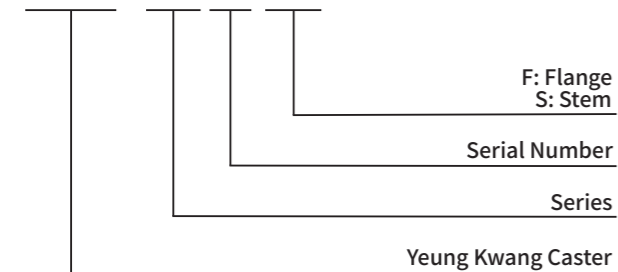

재질 MATERIAL & TREATMENT INFORMATION

No.	재질	표면처리
1	Caster seat	SPC & S45C Black Coated
2	Ball	STB2 Ni-Cr
3	Body	ALDC12 Hammerstone
4	Handle	ALDC12 Red Coating
5	Rod	Swrch10A Zn Galvanized
6	Pad	NBR Black
7	Wheel	PA6 Black
8	Pin	S10C Zn Galvanized

* Option: Wheel: Antistatic Poly Urethane



60F~100F



60S~100S

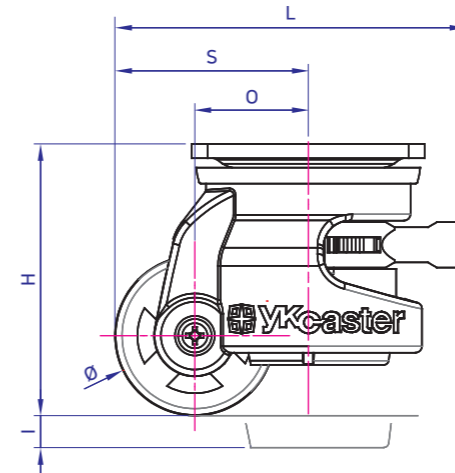
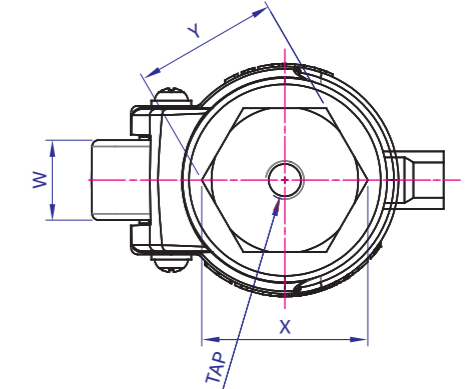
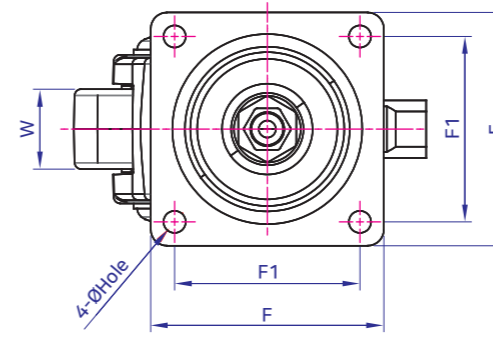

F

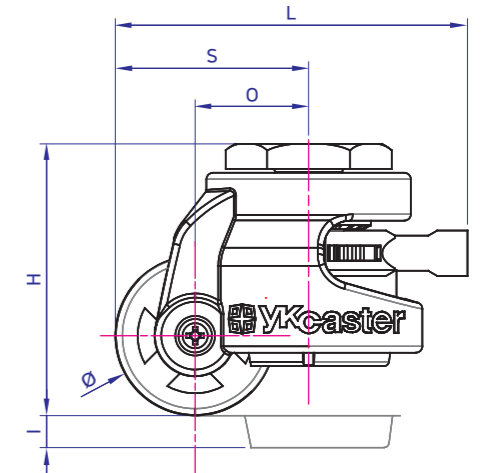

S

규격 DIMENSION

Code	자중 (Net weight) kg	Kg		Ø	W	F		Hole (Ø8.5)	Tap (Order) (M12/M16)	X	Y	H+I	L	S	O
		1EA	4EA			F	F1								
YKCT-AR60F	1.2	250	500	Ø50	25	73x73	58x58	Ø7 (Ø8.5)	-	-	-	82+10	110.2	60.5	35.5
YKCT-AR60S	1.02					-	-								
YKCT-AR80F	2.02	750	1500	Ø62	29	90x90	70x70	Ø9	-	-	-	103+12	126.3	76.6	45
YKCT-AR80S	1.8					-	-								
YKCT-AR100F	1.65	750	1500	Ø75	30	95x95	70x70	Ø11	-	-	-	120+12	141	90	53
YKCT-AR100S	1.55					-	-								

높낮이 조절용
YKCT-AS SERIES

제품특징 FEATURES

- 손쉬운 이동과 고정 높낮이 조절, 방진 및 360도 회전 기능 일체화.
- 휠 커버 사용으로 오염이 적음.
- Easy moving, fixing, adjustable height, anti-vibration and 360°rotation all-in-one.
- Less contamination due to wheel cover use.

적용범위 APPLICATION

- 식품, 주류 장비.
- 이화학 기기.
- 수분 염분이 있는 부식 방지 장비.
- 기타 각종 전용기.
- Food and liquor equipment.
- Physical and chemical appliances.
- Anti-corrosion equipment with moisture and salt.
- Other Various machines.

모델설명 ORDERING CODE

YKCT - AS 60 F/S

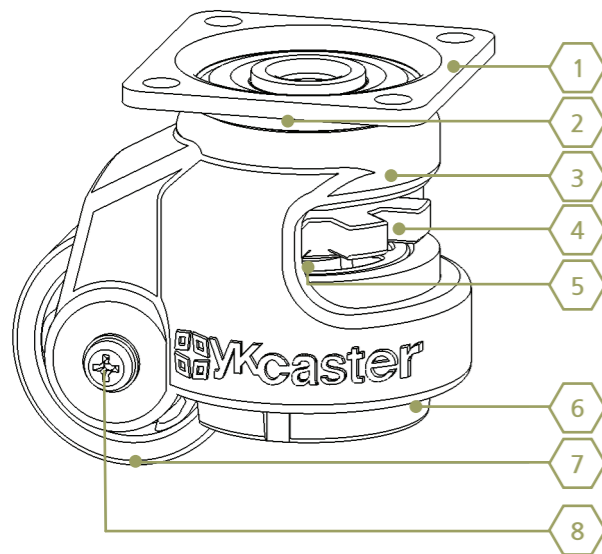
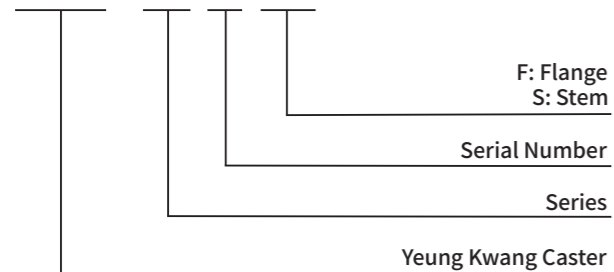

재질 MATERIAL & TREATMENT INFORMATION

No.	재질	표면처리	
1	Caster seat	SUS	-
2	Ball	SUS	-
3	Body	SUS	-
4	Handle	PA6	Red
5	Rod	SUS	-
6	Pad	NBR	Black
7	Wheel	PA6	Black
8	Pin	SUS	-

* Option: Wheel: Antistatic Poly Urethane

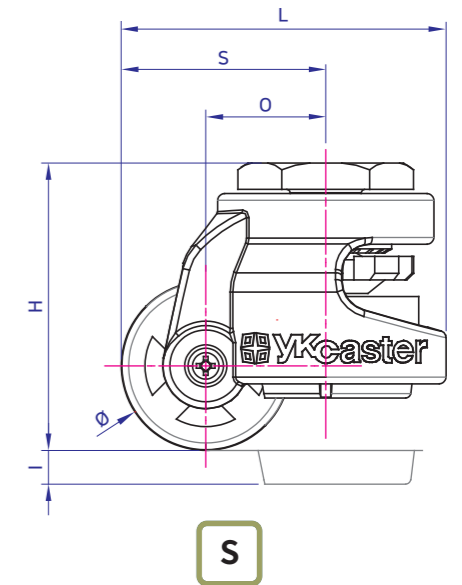
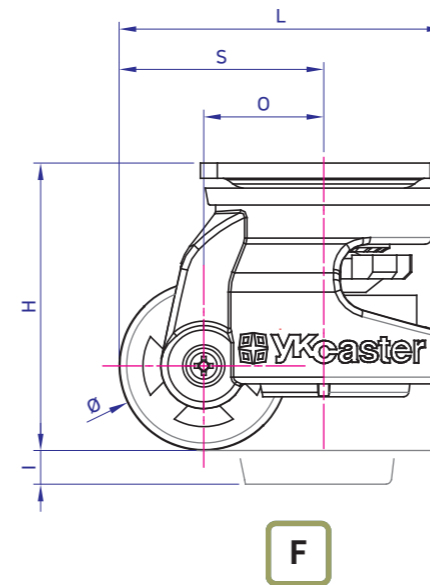
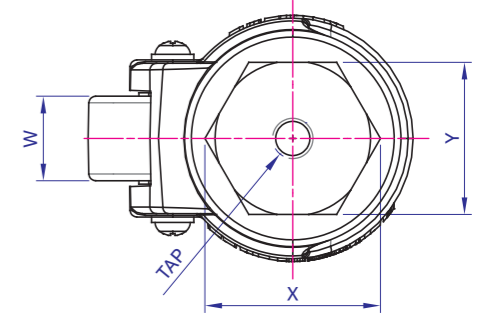
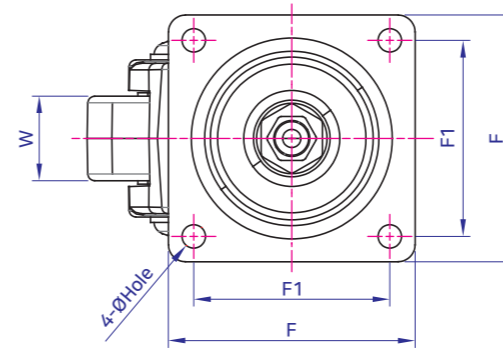

규격 DIMENSION

Code	자중 (Net weight) kg	Kg		Ø	W	F	F1	Hole	Tap (Order)	X	Y	H+H	L	S	O
		1EA	4EA												
YKCT-AS60F	1.2	250	500	Ø50	25	73x73	58x58	Ø6.5	-	-	-	82+10	97	60.5	35.5
YKCT-AS60S	1.02					-	-	-	M12 (M16)	52	45	-	-	-	-
YKCT-AS80F	2.02	500	1.000	Ø62	29	90x90	70x70	Ø9	-	-	-	103+10	121.6	76.6	45
YKCT-AS80S	1.8					-	-	-	M12 (M16)	70	65	-	-	-	-

높낮이 조절용
YKCT-AD SERIES

제품특징 FEATURES

- 손쉬운 이동과 고정 높낮이 조절, 방진 및 360도 회전 기능 일체화.
- 휠 커버 사용으로 오염이 적음.
- 높낮이 대폭 조절 가능.
- Easy moving, fixing, adjustable height, 360°rotation all-in-one.
- Less contamination due to wheel cover use.
- Being available for adjusting equipment with a wide height.

적용범위 APPLICATION

- 알루미늄 프로파일로 제작된 프레임, 자동화장비, 반도체 / 디스플레이 제조장비, 컨베이어 등.
- Aluminium frames with profile, Automation equipment, Semiconductor / Display manufacturing, Conveyors, etc.

모델설명 ORDERING CODE

YKCT - AD 200 F/FB

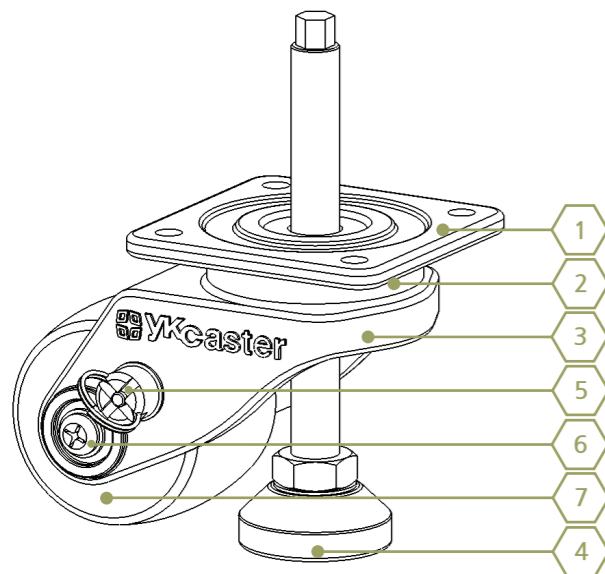
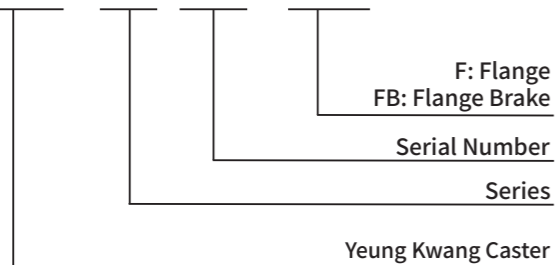

재질 MATERIAL & TREATMENT INFORMATION

No.	재질	표면처리
1	Caster seat	SPC Black Coated / Zn Galvanized
2	Ball	STB2 Ni-Cr
3	Body	ALDC12 Hammetone
4	Cup	SPC/ALDC12 Ni
5	Brake(1000FB)	S45C Zn Galvanized
6	Pin	S10C Zn Galvanized
7	Wheel	PA6 Black

* Option: Wheel: Antistatic Poly Urethane

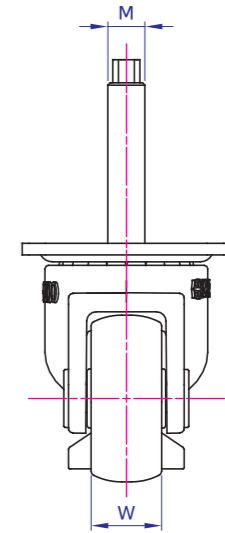
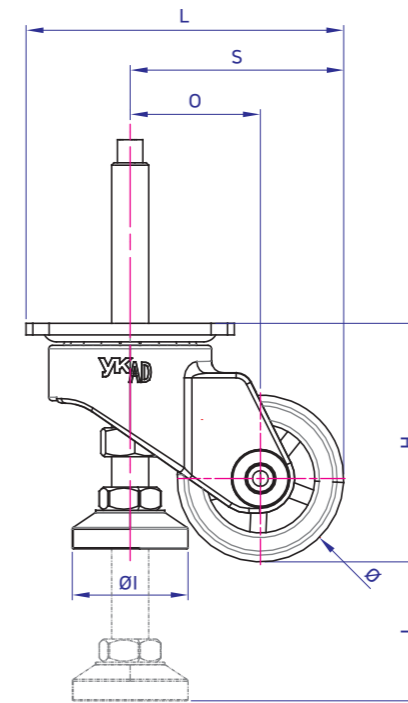
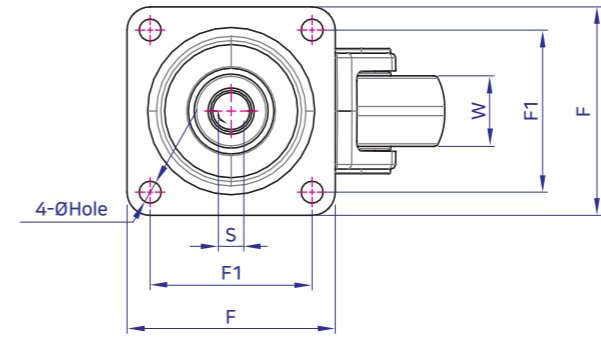

규격 DIMENSION

Code	자중 (Net weight) kg	Kg		Ø	W	F	F1	Hole	H+H	L	O	S	ØI	M	S
		1EA	4EA												
YKCT-AD200F	0.69	150	450	Ø50	25	73x73	58x58	Ø7	72+50	109.5	48	73	38	10	7
YKCT-AD700F	1.44	600	1800	Ø62	29	90x90	70x70	Ø9.5	99+60	140	64	95	50	16	11
YKCT-AD1000F	1.85	800	2400	Ø75	55	90x90	70x70	Ø9.5	110+60	153	70	107.5	50	16	11
YKCT-AD1000FB	1.94	800	2400	Ø75	55	90x90	70x70	Ø9.5	110+60	153	70	107.5	50	16	11
YKCT-ADT1000F	1.85	800	2400	Ø72	26x2	90x90	70x70	Ø9.5	108+60	151.5	70	106	50	16	11

높낮이 조절용
YKCT-AF SERIES

제품특징 FEATURES

- 손쉬운 이동과 고정 높낮이 조절, 방진 및 360도 회전 기능 일체화.
- Easy moving, fixing, adjustable height, 360° rotation all-in-one.

적용범위 APPLICATION

- 알루미늄 프로파일 프레임, 알루미늄 프로파일 30용 및 40용 공용, 자동화장비, 반도체 / 디스플레이 제조장비 세척기, PCB장비 전용 기계 등.
- Aluminium frames with Profile, 30 Series or 40 Series Common, Automation equipment, Semiconductor/Display manufacturing equipment washer, PCB device special machine, etc.

모델설명 ORDERING CODE

YKCT - AF 304063

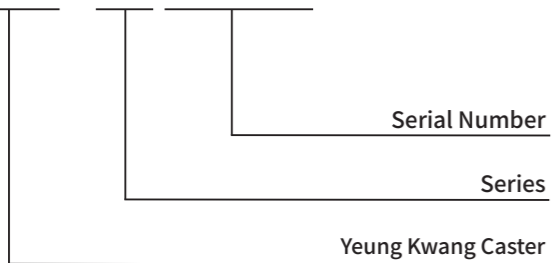

재질 MATERIAL & TREATMENT INFORMATION

No.	재질	표면처리
1	Caster seat	ALDC12
2	Body	SPC
3	Wheel	HDP
4	Bolt	S45C
5	Foot	ALDC12

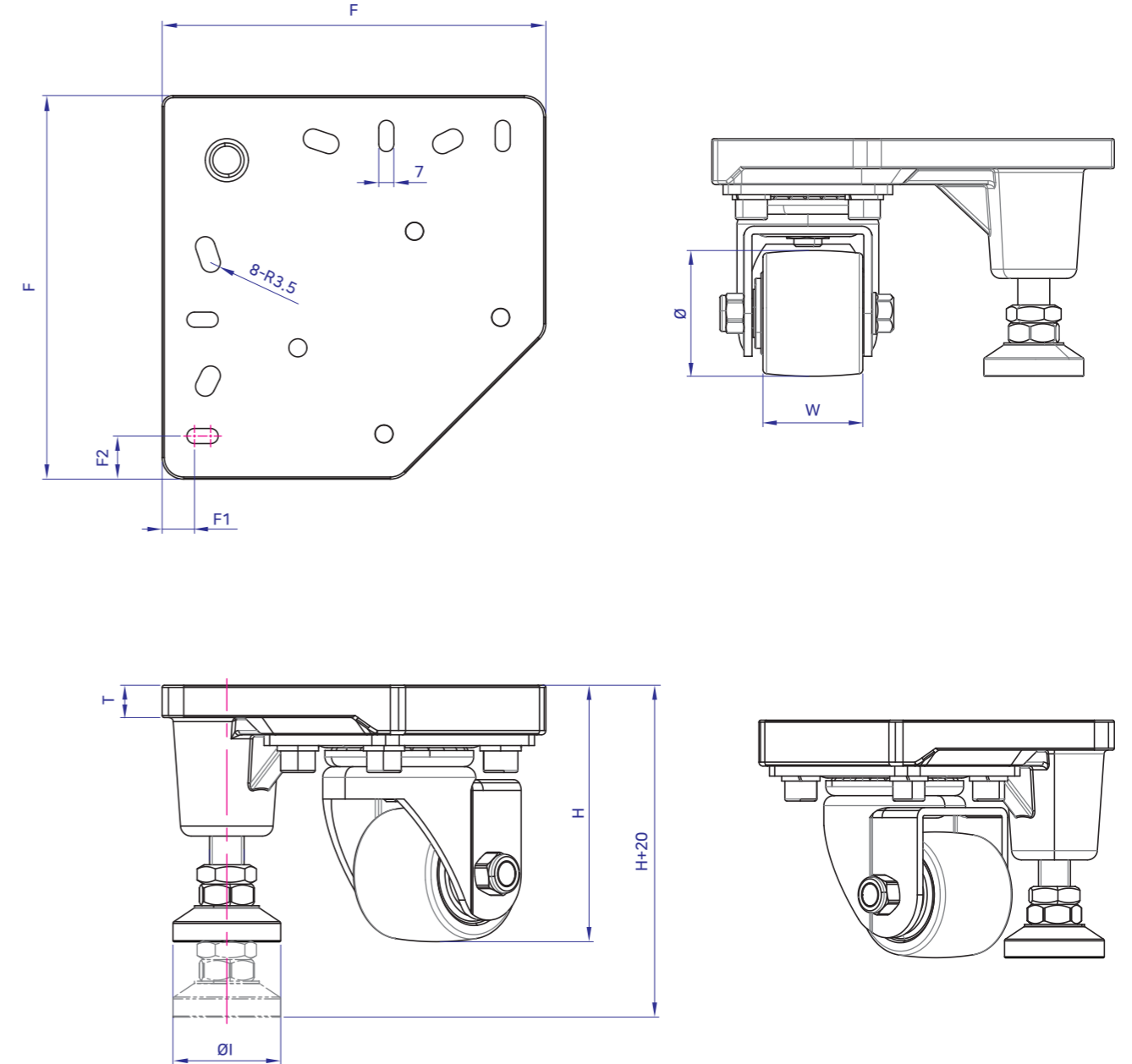
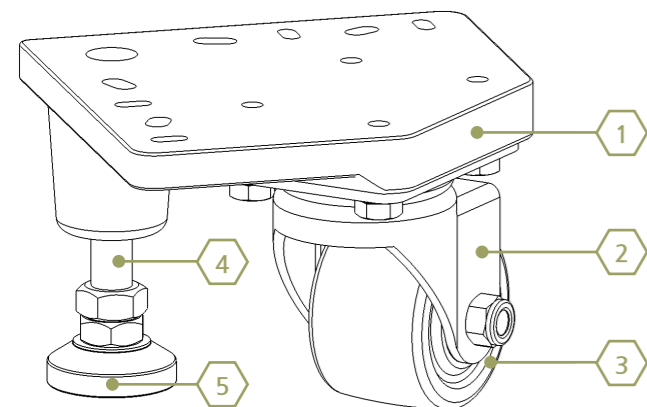

규격 DIMENSION

Code	자중 (Net weight)	Kg		Ø	W	F	F1	F2	H	T	ØI
	kg	1EA	4EA								
YKCT-AF304063	3.22	600	1800	Ø63	50	178	20	15	119+20	12	Ø50 (M16)
YKCT-AF304075	3.53	700	2100	Ø75					131+20		

높낮이 조절용
YKCT-CT-F SERIES

제품특징 FEATURES

- 사용장비의 안정된 고정을 위한 높낮이 조절가능
- 사용장비에 진동과 충격방지를 위한 방진 기능
- 저상형 / 이동과 고정이 용이함
- Height adjustable for stable fixation of equipment.
- Dust-proof function to prevent vibration and impact on the equipment used
- Low floor type / Easy to move and fix

적용범위 APPLICATION

- 정보통신 기기
- 소형 시험설비 / 반도체 제조설비
- 2차전지 설비 / 의료기기
- Information and communication equipment
- Small testing equipment / semiconductor manufacturing equipment
- Secondary battery equipment/medical devices

모델설명 ORDERING CODE

YKCT - CT 900F

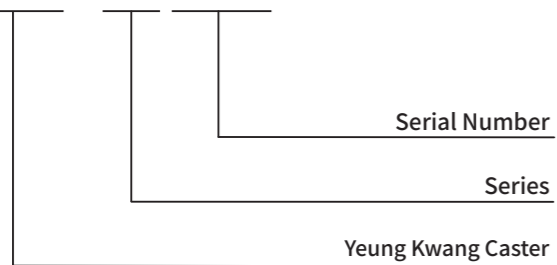

재질 MATERIAL & TREATMENT INFORMATION

No.	재질	표면처리
①	Caster seat	SHPC Zn Galvanized
②	Shaft	S10C Zn Galvanized
③	Body	ALDC12 Zn Galvanized
④	Leveler	S10C Zn Galvanized
⑤	Cup	SPHC Zn Galvanized
⑥	Foot	NBR & Urethane Black & Yellow
⑦	pin	S10C Zn Galvanized
⑧	Wheel	PA6 Black

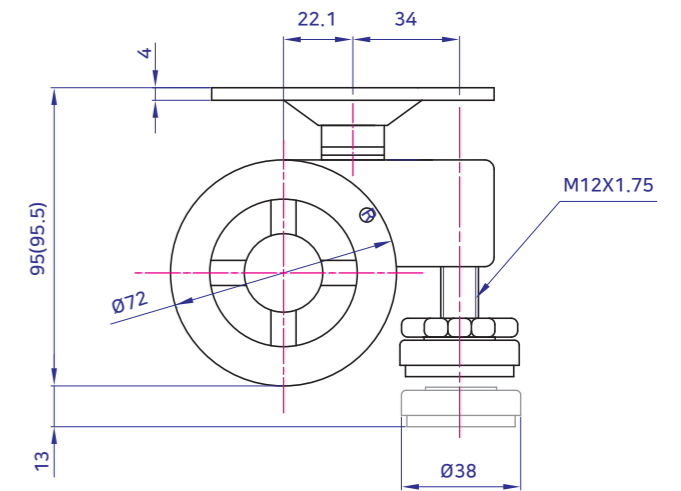
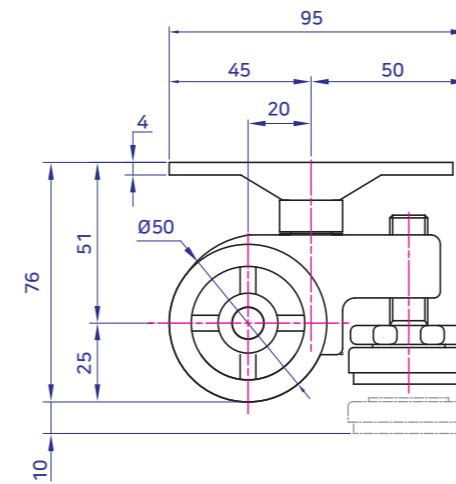
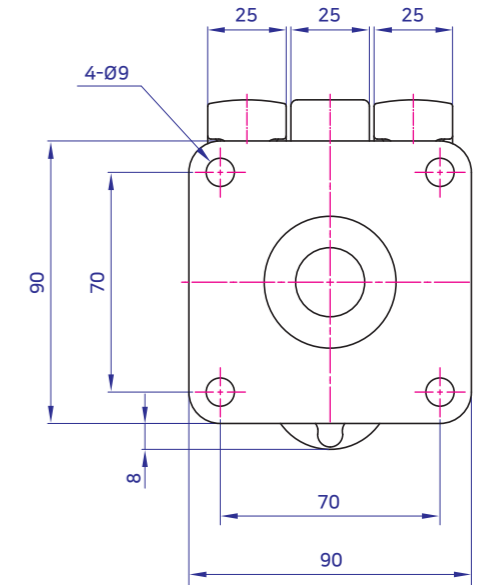
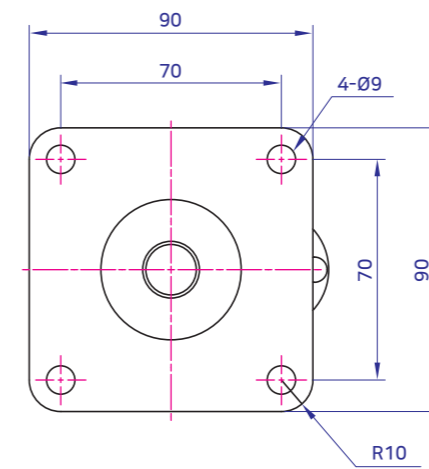
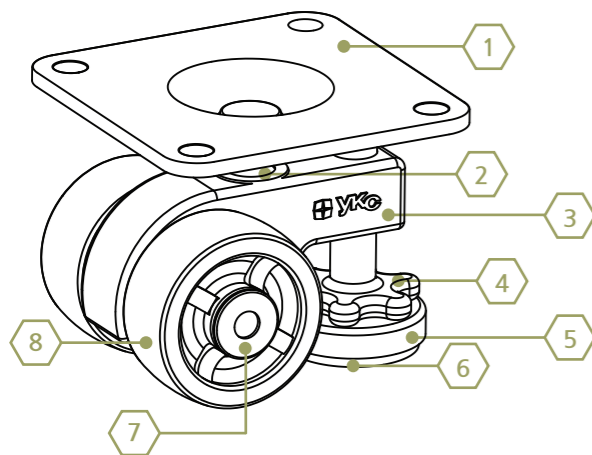

F 500

F 900

규격 DIMENSION

Code	자중 (Net weight) kg	Kg		W		F		Hole	H	I	L	O
		1EA	4EA	Ø	W	F	F1					
YKCT-500F	0.62	140	400	Ø50	25x2	90x90	70x70	Ø9	76	10	95	20
YKCT-900F	0.88	270	800	Ø72	25x2	90x90	70x70	Ø9	96	13	111	22

높낮이 조절용
YKCT-CT-S SERIES

제품특징 FEATURES

- 사용장비의 안정된 고정을 위한 높낮이 조절가능
- 사용장비에 진동과 충격방지를 위한 방진 기능
- 저상형 / 이동과 고정이 용이함
- Height adjustable for stable fixation of equipment.
- Dust-proof function to prevent vibration and impact on the equipment used
- Low floor type / Easy to move and fix

적용범위 APPLICATION

- 정보통신 기기
- 소형 시험설비 / 반도체 제조설비
- 2차전지 설비 / 의료기기
- Information and communication equipment
- Small testing equipment / semiconductor manufacturing equipment
- Secondary battery equipment/medical devices

모델설명 ORDERING CODE

YKCT - CT 500S

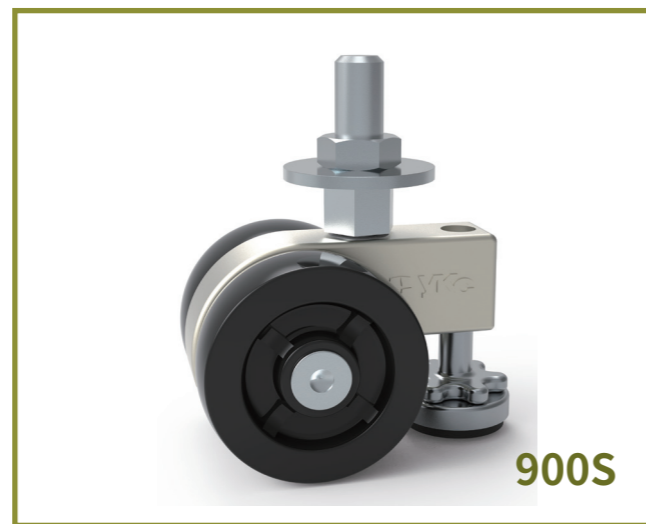
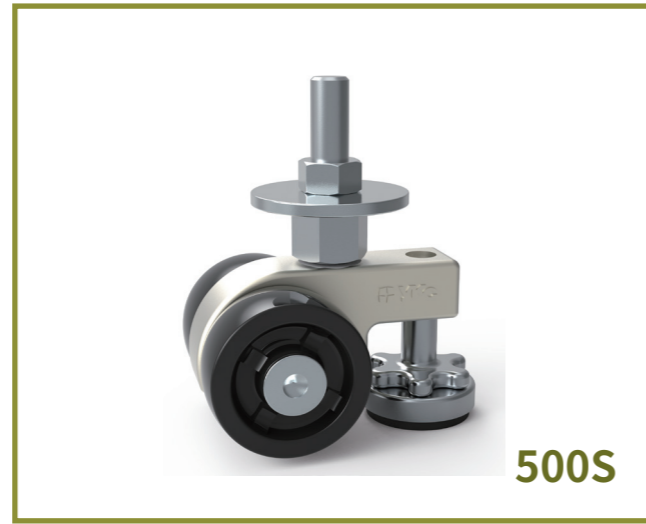
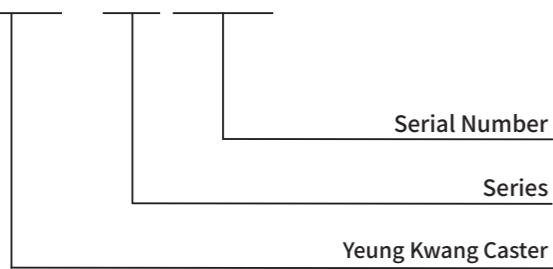

재질 MATERIAL & TREATMENT INFORMATION

No.	재질	표면처리
1 2	Bolt & Nut	S10C Zn Galvanized
3	Washer	SPHC Zn Galvanized
4	Body	ALDC12 Zn Galvanized
5	Leveler	S10C Zn Galvanized
6	Cup	SPHC Zn Galvanized
7	Foot	NBR & Urethane Black & Yellow
8	pin	S10C Zn Galvanized
9	Wheel	PA6 / EPP Black

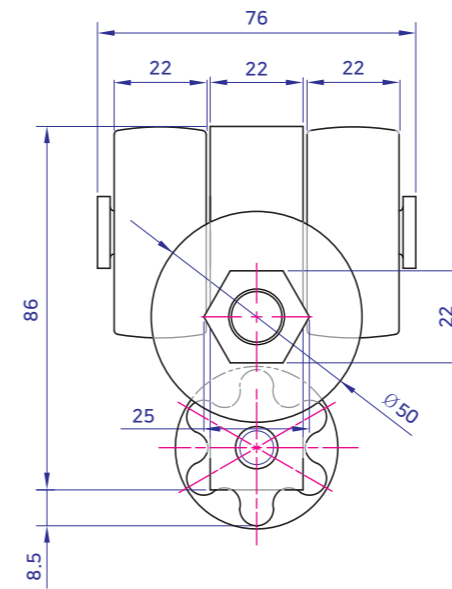
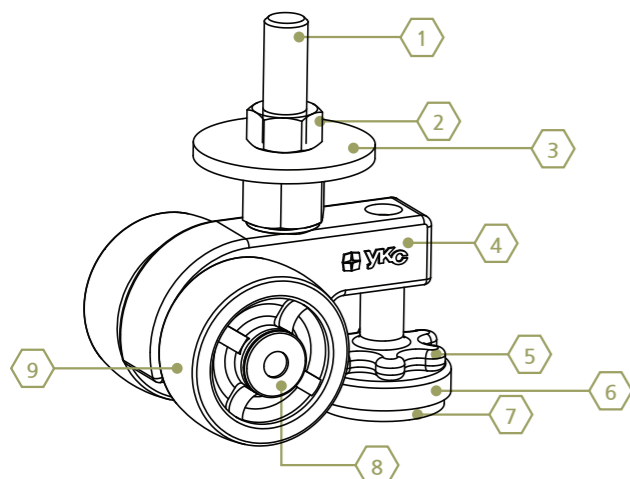

S 500

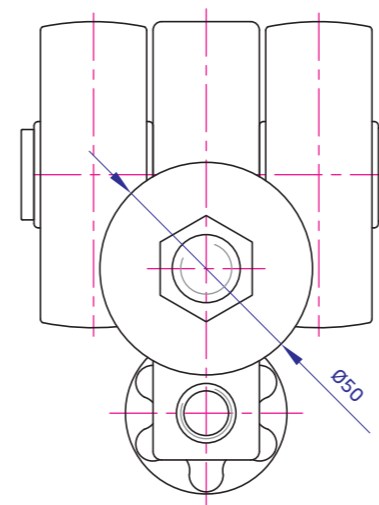

S 900

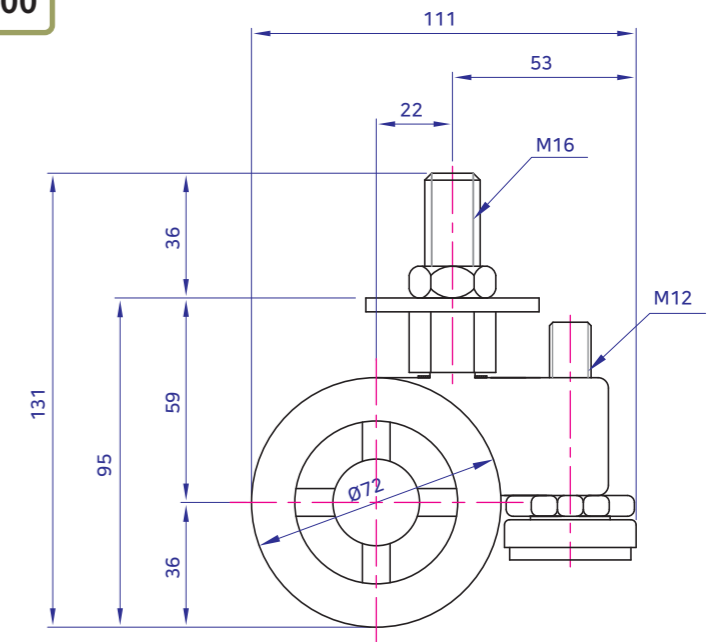
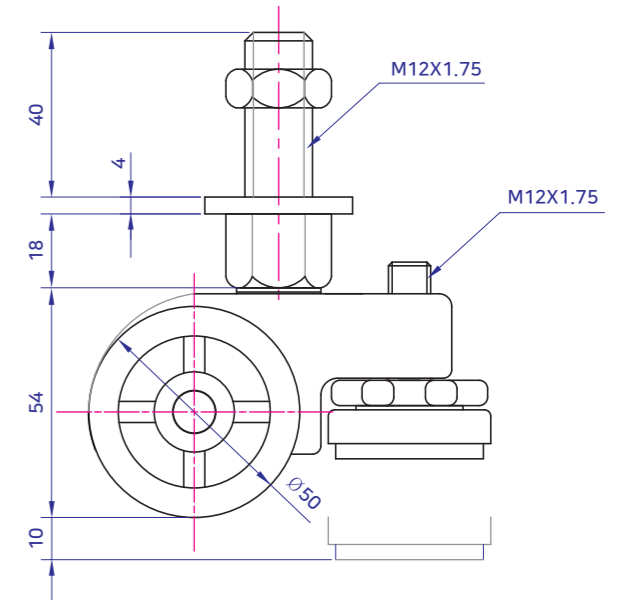

규격 DIMENSION

Code	자중 (Net weight)	Kg		Ø		H		L		M	
	kg	1EA	4EA	Ø	W	H	I	L	O	M	Y
YKCT-500S	0.44	140	400	Ø50	25x2	76	10	95	20	M12	36
YKCT-900S	0.72	270	800	Ø72	25x2	95	13	111	22	M16	36

높낮이 조절용 (저상형)
YKCT--LGP1F SERIES

제품특징 FEATURES

- 저상용이며, 선회력이 우수.
- 장시간 하중에도 휠의 변형이 없으며 휠 커버 사용으로 오염이 적음.
- 구름 과 동시에 고정 기능.
- For low-phase use and has excellent turning skills.
- No deformation of the wheel even with a long-term load, and less contaminated because of the wheel cover.
- Rolling and fixing at the same.

적용범위 APPLICATION

- 금융 기기.
- 통신 장비.
- 캐비닛 등 전장 박스.
- Financial machin.
- Communication equipment.
- Cabinet and other electronic boxes.

모델설명 ORDERING CODE

YKCT - LGP1F 63 RF/SF

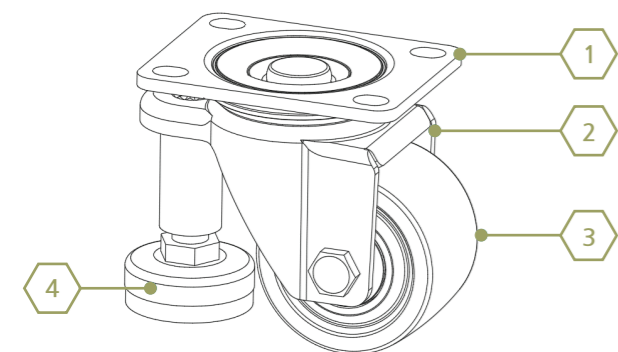
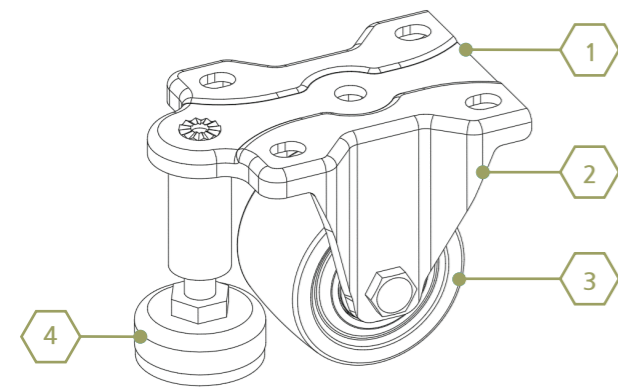
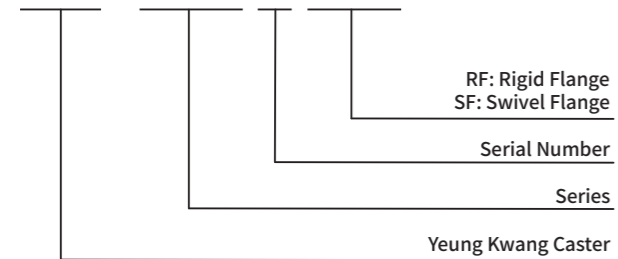

재질 MATERIAL & TREATMENT INFORMATION

No.	재질	표면처리
1	Caster seat	SPC Black Coated
2	Body	SPC Black Coated
3	Wheel	HDP Black
4	Foot	S45C Ni

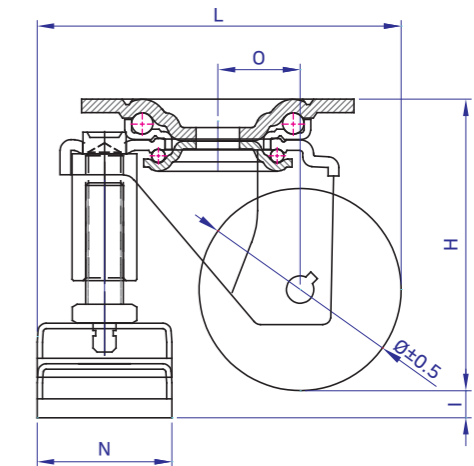
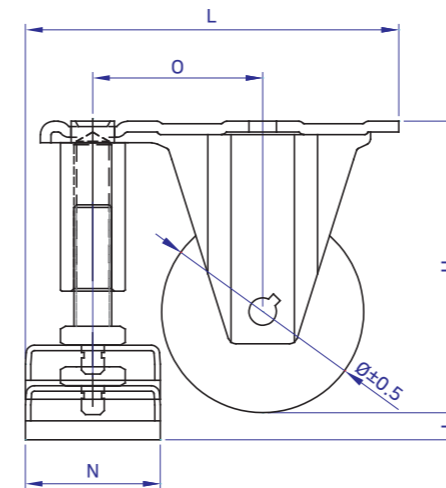
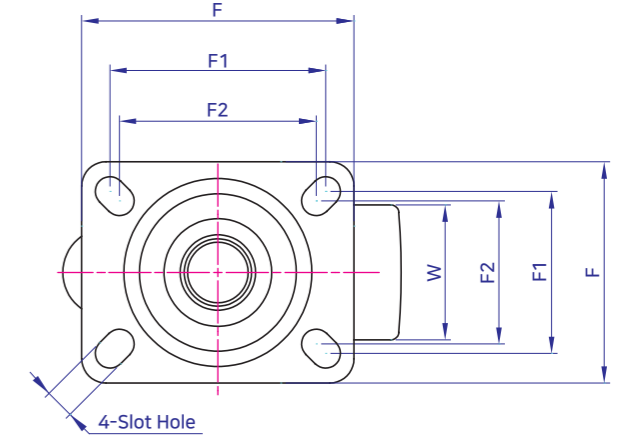
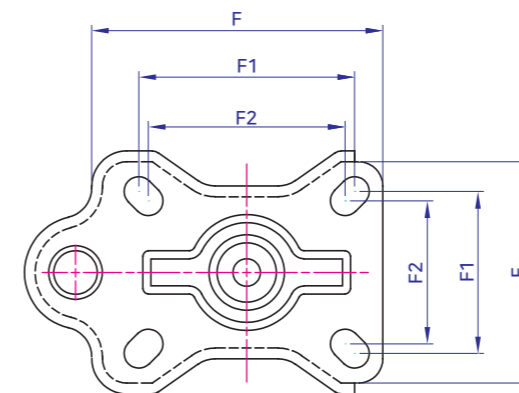

RF

SF

규격 DIMENSION

Code	자중 (Net weight) kg	Kg		Ø	W	F	F1	F2	Slot Hole	H + I	L(최대)	O	N
		1EA	4EA										
YKCT-LGP1F63RF	1.19	400	1200	Ø63	50	107x82	80x60	73x53	Ø11x16L	96+10	125	-	Ø50
YKCT-LGP1F63SF	1.53										138.5	26.5	
YKCT-LGP1F75RF	1.26	500	1500	Ø75	50					108+10	125	-	Ø50
YKCT-LGP1F75SF	1.59										138.5	30.5	

컴팩트 이동형
YKCT-LGD 60. 75 SERIES

제품특징 FEATURES

- 중하중용 저상 캐스터로 손쉬운 이동과 360도 회전 기능 일체화
- Low-phase caster for heavy load integrates easy movement and 360 degree rotation.

적용범위 APPLICATION

- 알루미늄 프로파일 프레임, 반도체 장비, 의료 장비, 중하중 장비 및 운반 대차
- Aluminum profile frames, semiconductor equipment, medical equipment, heavy load equipment and transportation trucks.

모델설명 ORDERING CODE

YKCT - LGD 60 F/FB

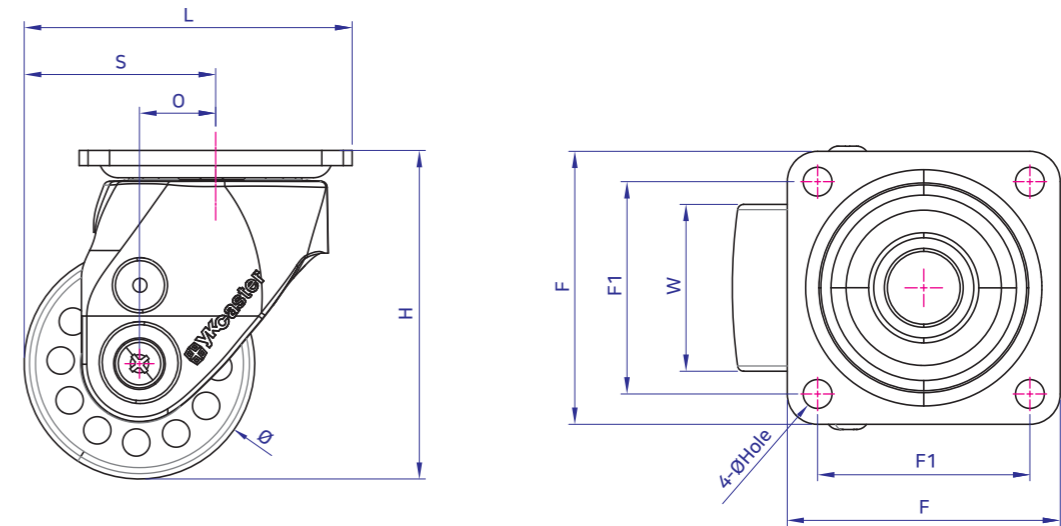
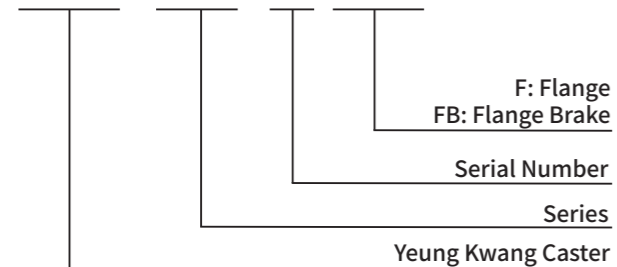

규격 DIMENSION

Code	자중 (Net weight)	Kg		Ø		F		Hole	H	L	S	O
	kg	1EA	4EA	W	F	F1						
YKCT-LGD60F	0.78	550	1700	Ø60	55	90x90	70x70	Ø9.5	90	100	55	25
YKCT-LGD60FB	0.92	550	1700	Ø60	55	90x90	70x70	Ø9.5	90	100	55	25
YKCT-LGD60FU	1	550	1700	Ø60	55	90x90	70x70	Ø9.5	90	100	55	25
YKCT-LGD75F	1.06	700	2100	Ø75	55	90x90	70x70	Ø9.5	108	108	63	25
YKCT-LGD75FB	1.2	700	2100	Ø75	55	90x90	70x70	Ø9.5	108	108	63	25
YKCT-LGD75FU	1.28	700	2100	Ø75	55	90x90	70x70	Ø9.5	108	108	63	25
YKCT-LGD75F-1	1.08	700	2100	Ø75	26x4	95x95	70x70	Ø11	106	106	61.5	25
YKCT-LGDT60F	0.92	550	1700	Ø50	26x2	90x90	70x70	Ø9.5	85	100	55	25
YKCT-LGDT60S	0.92	550	1700	Ø50	26x2	-	-	-	85	95	55	25
YKCT-LGDT75F	1.06	700	2100	Ø72	26x2	90x90	70x70	Ø9.5	106	108	63	25
YKCT-LGDT75S	1.06	700	2100	Ø72	26x2	-	-	-	106	101	63	25

재질 MATERIAL & TREATMENT INFORMATION

No.	재질	표면처리
1	Caster seat	SPC/SM45C Black Coated / Zn Galvanized
2	Ball	STB2 Ni-Cr
3	Body	ALDC12 Ivory / Powder Coated
4	Brake(B)	S45C Zn Galvanized
5	Pin	S10C/SM45C Zn Galvanized
6	Wheel	EPP Black

* Option: Wheel: Antistatic Poly Urethane

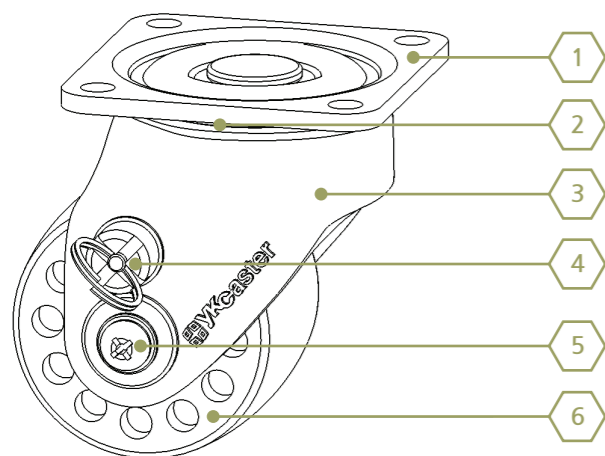

컴팩트 이동형
YKCT-LGD 100

제품특징 FEATURES

- 고하중용 저상 캐스터로 손쉬운 이동과 360도 회전 기능일체화
- Integrated 360 degree rotation and easy movement with a high load and low-phase caster.

적용범위 APPLICATION

- 알루미늄 프로파일 프레임, 반도체 장비, 의료 장비, 고하중 장비 및 운반 대차
- Aluminum profile frames, semiconductor equipment, medical equipment, High-load equipment and transportation trucks.

모델설명 ORDERING CODE

YKCT - LGD 100 F-M/U

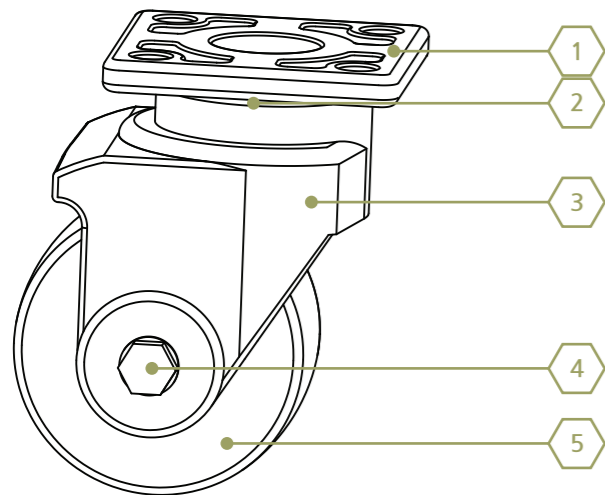
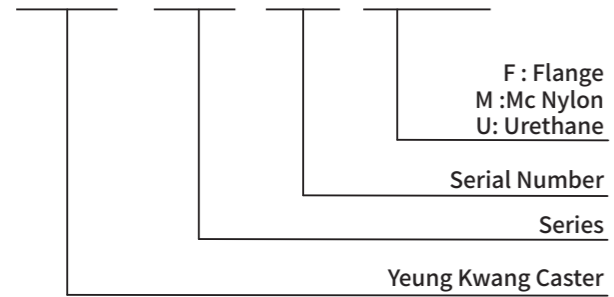

재질 MATERIAL & TREATMENT INFORMATION

No.	재질	표면처리
1	Caster seat	SPC/SM45C Black Coated
2	Ball	STB2 Ni-Cr
3	Body	ALDC12 Hammerstone
4	Pin	S10C/SM45C Zn Galvanized
5	Wheel	Mc Nylon Blue or Ivory

※ Option: Wheel: Antistatic Poly Urethane

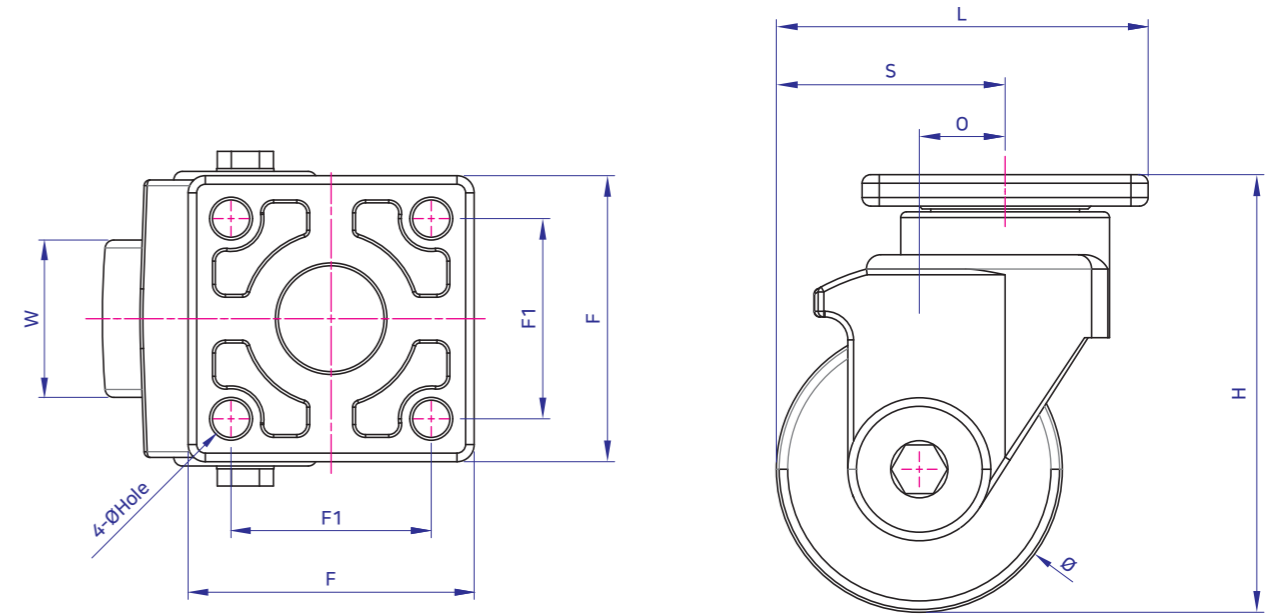

규격 DIMENSION

Code	자중 (Net weight) kg	Kg		∅	W	F	F1	Hole	H	L	S	O
		1EA	4EA									
YKCT-LGD100FM	2.75	1000	3000	∅100	50	100x100	70x70	∅13	150	130	80	30
YKCT-LGD100FU	2.97	1000	3000	∅100	50				150	130	80	30

컴팩트 이동형
YKCT-LGP1 SERIES

제품특징 FEATURES

- 저상용이며, 선회력이 우수.
- 장시간 하중에도 휠의 변형이 없으며 휠 커버 사용으로 오염이 적음.
- For low-phase use and has excellent turning skills.
- No deformation of the wheel even with a long-term load, and less contaminated because of the wheel cover.

적용범위 APPLICATION

- 금융 기기.
- 통신 장비.
- 캐비닛 등 전장 박스.
- Financial machin.
- Communication equipment.
- Cabinet and other electronic boxes.

모델설명 ORDERING CODE

YKCT - LGP1 63 RF/SF/SFB

RF: Rigid Flange
SF: Swivel Flange
SFB: Swivel Flange Brake

Serial Number

Series

Yeung Kwang Caster

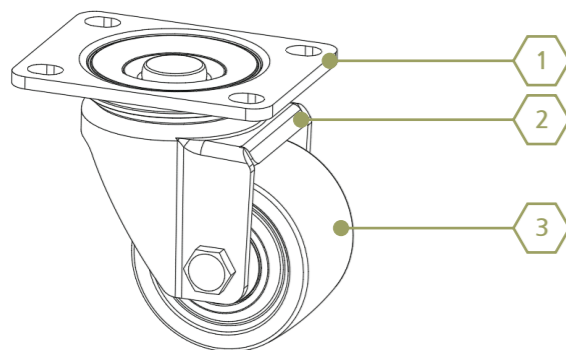
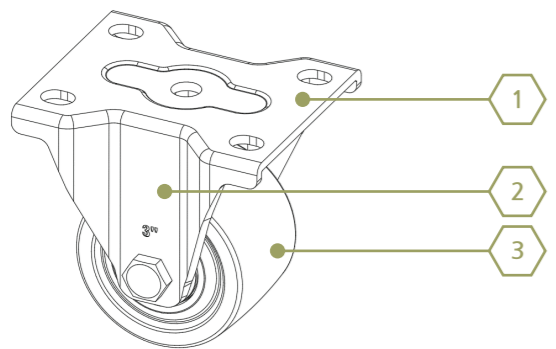

재질 MATERIAL & TREATMENT INFORMATION

No.	재질	표면처리
1	Caster seat	SPC Black Coated
2	Body	SPC Black Coated
3	Wheel	HDP Black
4	Brake	ABS Black Coated

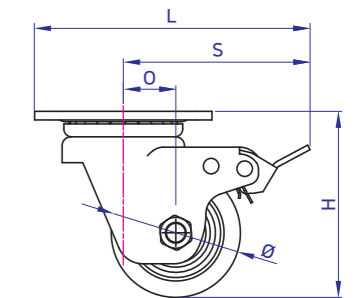
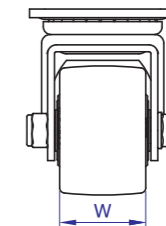
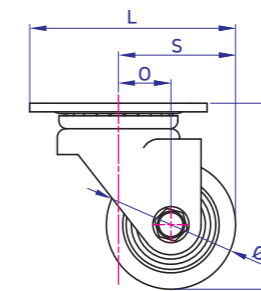
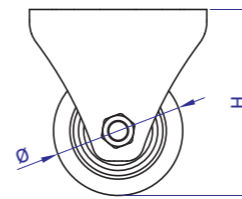
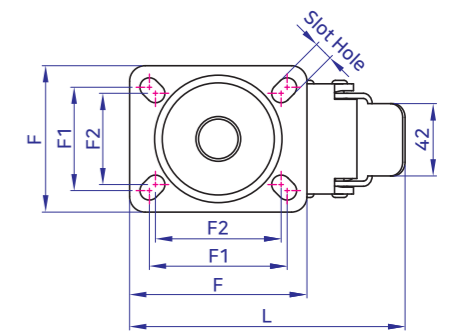
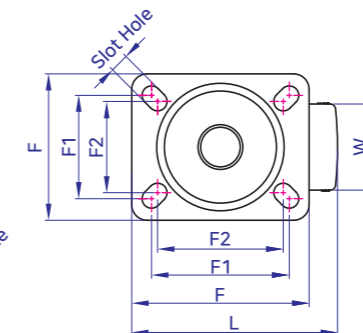
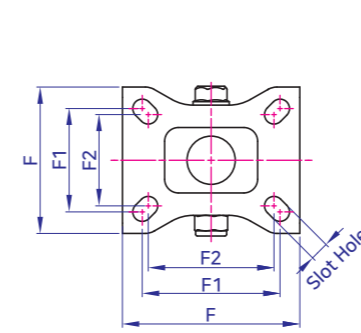
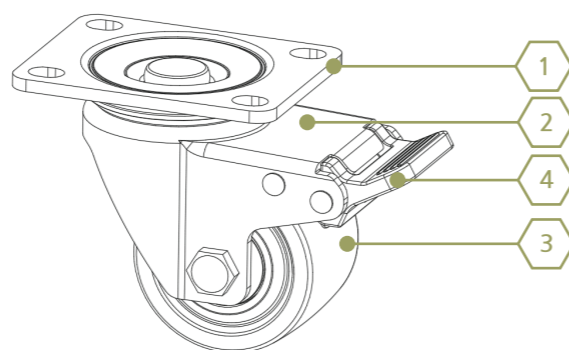

규격 DIMENSION

Code	자중 (Net weight) Kg	Kg		mm		mm				mm			
		1EA	4EA	Ø	W	F	F1	F2	Slot Hole	H	L	S	O
YKCT-LGP163RF	0.96										103	-	-
YKCT-LGP163SF	1.2	400	1200	Ø63		103x85	80x60	73x53		96	109.5	58	26.5
YKCT-LGP163SFB	1.5										150	98.5	26.5
YKCT-LGP175RF	1.03				50				Ø11x16L		103	-	-
YKCT-LGP175SF	1.36	500	1500	Ø75		103x85	80x60	73x53		108	119.5	68	30.5
YKCT-LGP175SFB	1.66										160	108.5	30.5

컴팩트 이동형 (저상형)
YKCT-JS SERIES

제품특징 FEATURES

- 무소음, 무유격, 회전력 극대화
- 장시간 하중에도 휠의 변형이 없으며 휠 커버 사용으로 오염이 적음.
- Noise-free, no gaps, maximum rotational power.
- No deformation of the wheel even with a long-term load, and less contaminated because of the wheel cover.

적용범위 APPLICATION

- 고하중 장비.
- 각종 고하중용 운반구.
- High load equipment.
- Various high load carriers.

모델설명 ORDERING CODE

YKCT - JS 60 RF/SF/SS

RF: Rigid Flange
SF: Swivel Flange
SS: Swivel Stem
Serial Number
Series
Yeung Kwang Caster

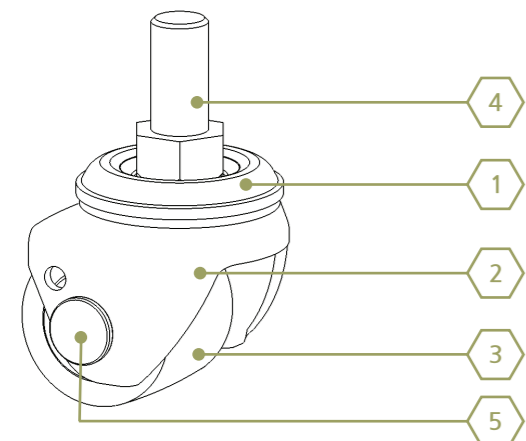
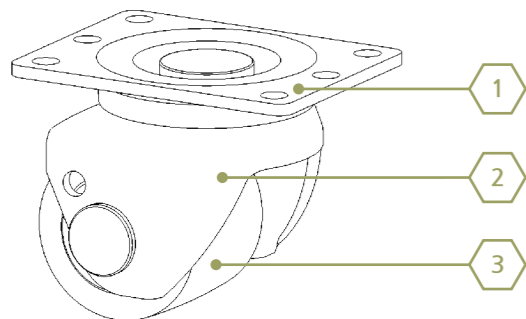

재질 MATERIAL & TREATMENT INFORMATION

No.	재질	표면처리
1	Caster seat	SPC Zn Galvanized
2	FRAME	SPC Zn Galvanized
3	Wheel	EPP Black
4	Bolt	S45C Zn Galvanized
5	Pin	S45C Zn Galvanized

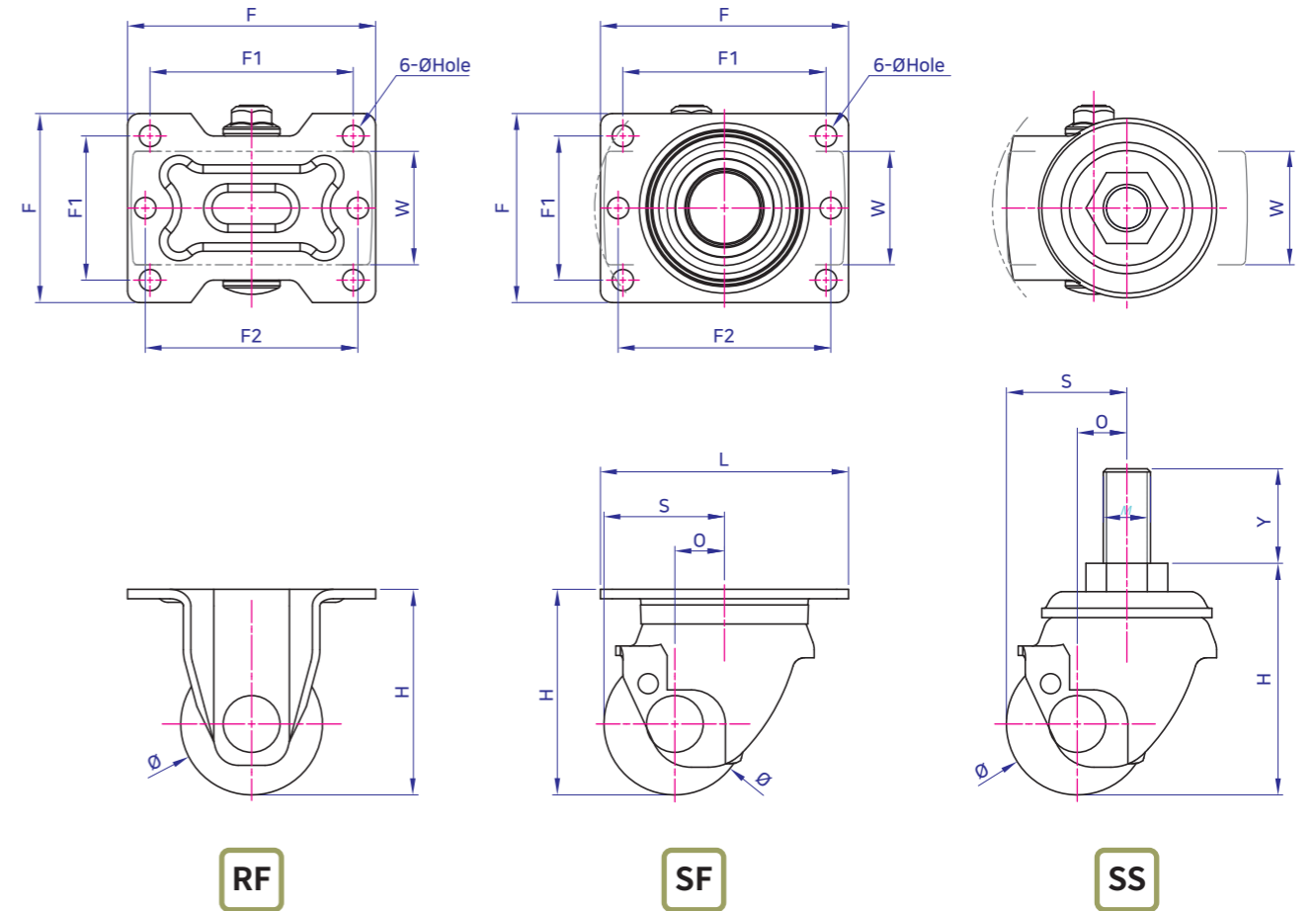

규격 DIMENSION

Code	자중 (Net weight) Kg	1EA	4EA	Ø	W	RF/SF				SS					
						F	F1	F2	Hole	H	L	S	O	M	Y
YKCT-JS60RFN	0.66	500	1500	Ø60	48	105×80	86×61	90	Ø9	87	105	-	-	-	-
YKCT-JS60SFN	1.1	500	1500			-	-	-	-	98	89	51	21	M20	40
YKCT-JS60SSN	1.2	500	1500	Ø70	48	105×80	86×61	90	Ø9	97	105	-	-	-	-
YKCT-JS70RFN	0.7	600	1800			-	-	-	-	108.5	56	21	-	-	-
YKCT-JS70SFN	1.2	600	1800			-	-	-	-	108	94	56	21	M20	40
YKCT-JS70SSN	1.3	600	1800	-	-	-	-	-	-	-	-	-	-	-	

정전기 방지용
YKCT-WEU SERIES

제품특징 FEATURES

- 도전 NBR(표면 저항 10E, 5-6Ω)적용하여 완벽한 제전 기능으로 전자부품 보호 등 우수한 내마모성 내약품성을 갖는다.
- By applying a conductive NBR (surface resistance of 10E, 5-6Ω), it has excellent wear resistance, such as protecting electronic components, with a perfect antistatic function.

적용범위 APPLICATION

- 반도체, 디스플레이, 전자 부품 / 가전제품 화학 약품 등 정전기 발생 장소 사용
- 캐비닛 등 전장 박스.
- It is used in places where static electricity is generated, such as semiconductors, displays, electronic parts, home appliances, chemicals, etc.

모델설명 ORDERING CODE

YKCT - WEU 100 RF/SF/SFB/SS/SSB NBR

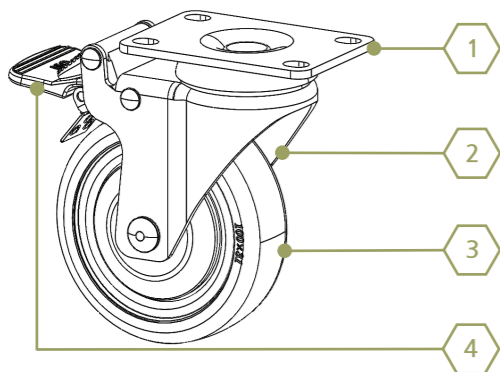
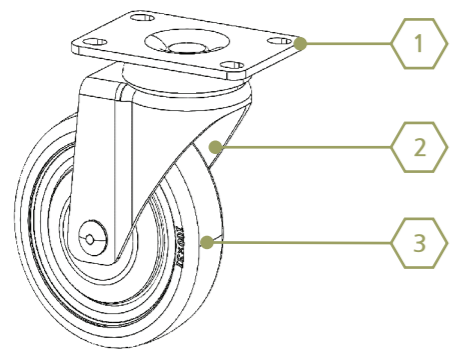
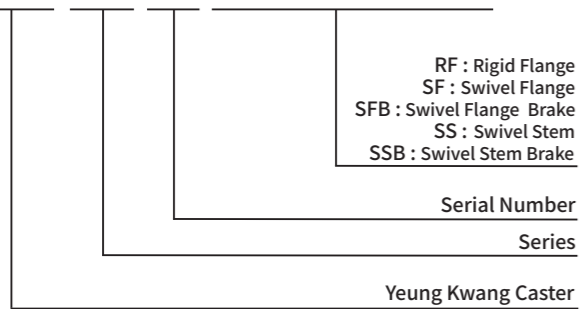

재질 MATERIAL & TREATMENT INFORMATION

No.	재질	표면처리
1	Caster seat	SPC Zn Galvanized
2	Body	SPC Zn Galvanized
3	Wheel	NBR(WEU) Black
4	Brake	ABS Black Coated
5	Bolt	S45C Zn Galvanized

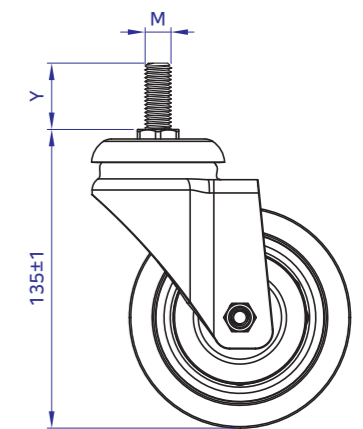
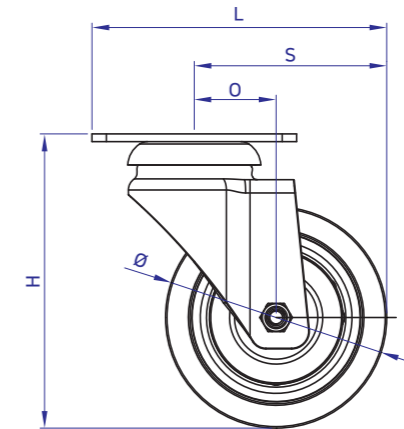
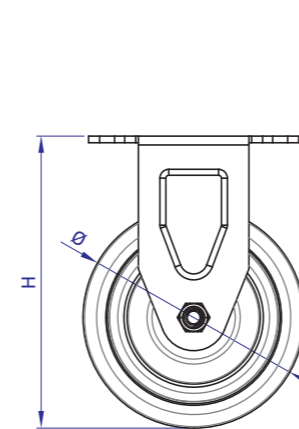
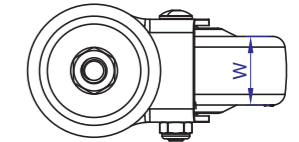
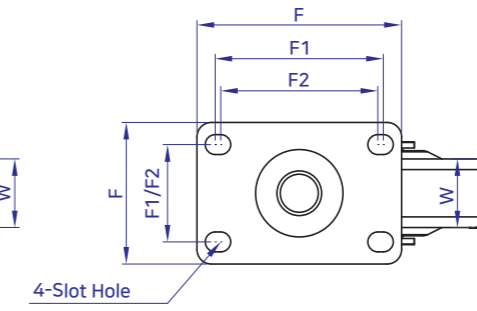
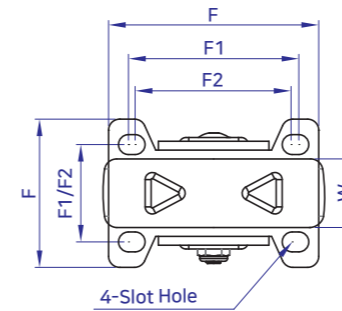
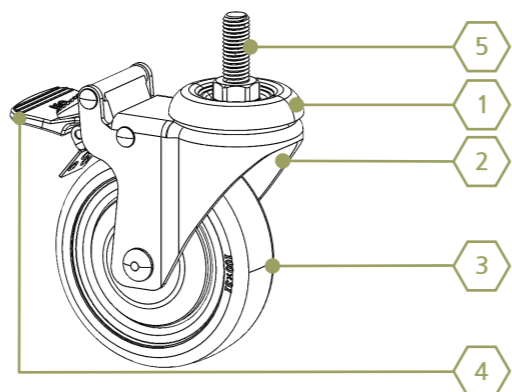

규격 DIMENSION

Code	자중 (Net weight) kg	Kg		ø	W	F	F1	F2	Hole	H	L	S	O	M	Y
		1EA	4EA												
YKCT-WEU100RF	0.49	100	300	ø100	31	95x67	77x44	70.5x44	ø9x12L	132	100	-	-	-	-
YKCT-WEU100SF	0.74	100	300			92.5x64	76x44	73.5x44	ø9x11.5L	133	133.3	87	37	-	-
YKCT-WEU100SFB	0.78	100	300			-	-	-	-	135	153.2	87	37	-	-
YKCT-WEU100SS	0.7	100	300			-	-	-	-	135	116.8	87	37	M12	30
YKCT-WEU100SSB	0.79	100	300			-	-	-	-	135	136.8	87	37	M12	30

* NBR - TYPE

기능성 이동
YKCT-MPH SERIES

제품특징 FEATURES

- 선회력이 우수하여 공전간 / 공장간 물류용으로 사용
- Excellent turning skills, using for logistics between process and factories.

적용범위 APPLICATION

- 공정간 / 공장간 이송용 대차
- 고하중용 장비
- 각종 중하중용 운반구
- Transportation truck between processes and factories
- High load equipment
- Various heavy load carriers.

모델설명 ORDERING CODE

YKCT - MPH 100 RF/SF/SFB

RF: Rigid Flange
SF: Swivel Flange
SFB: Swivel Flange Brake

Serial Number

Series

Yeung Kwang Caster

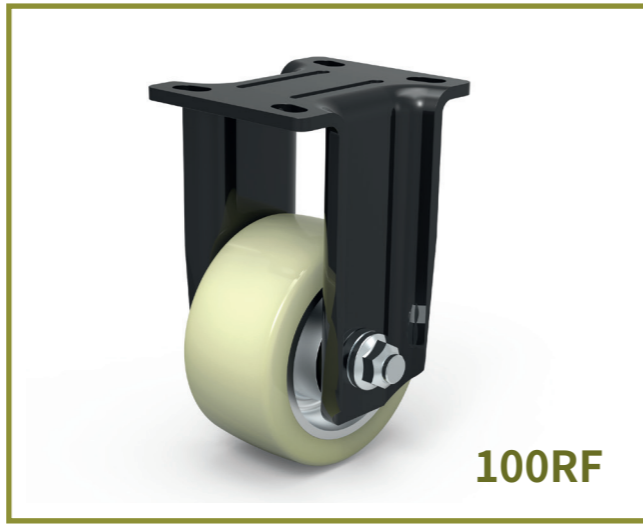
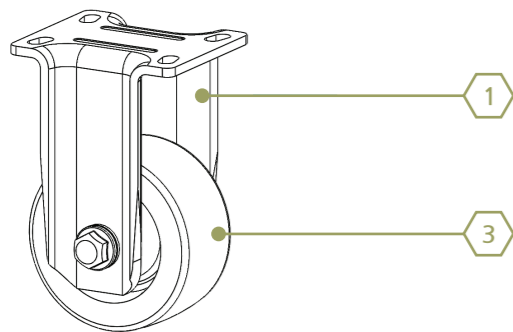
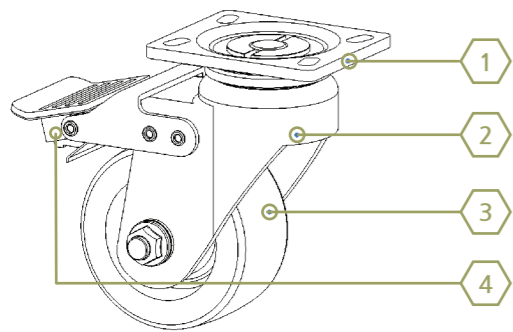

재질 MATERIAL & TREATMENT INFORMATION

No.	재질	표면처리
1	Caster seat	SPC Black Coated
2	FRAME	SPC Black Coated
3	Wheel	Poly Urethane+AL -
4	Brake	ABS -

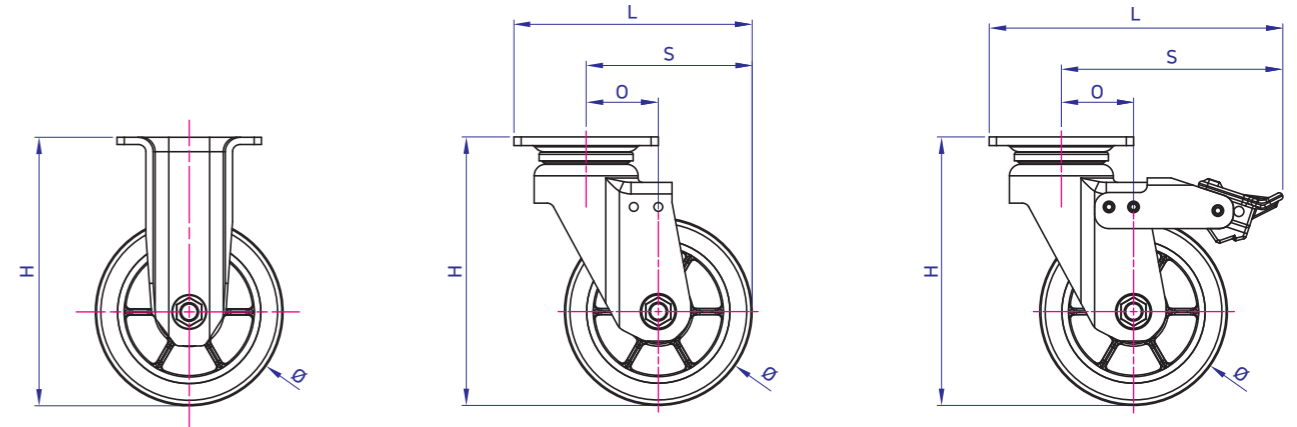
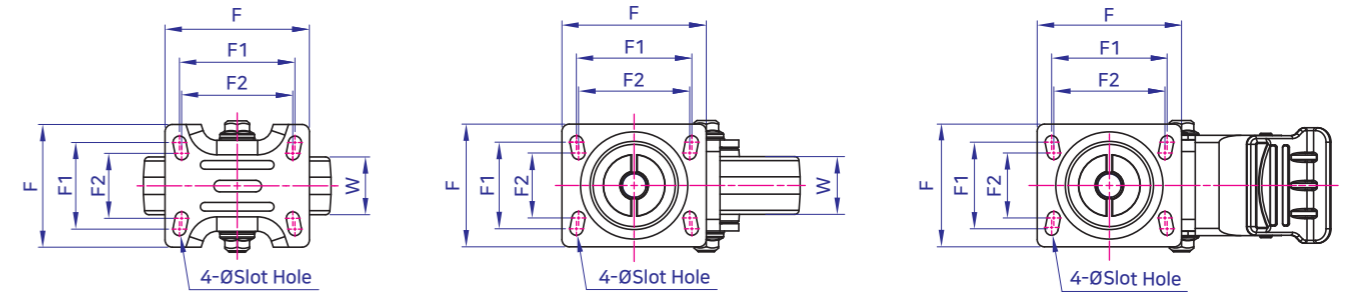
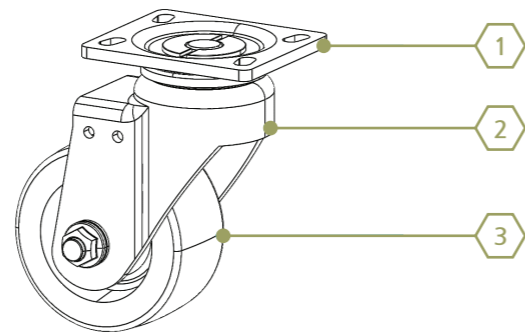

RF

SF

SFB

규격 DIMENSION

Code	자중 (Net weight) kg	Kg		Ø	W	F	F1	F2	Hole	H	L	S	O
		1EA	4EA										
YKCT-MPH100RFU	2.5										100	-	-
YKCT-MPH100SFU	2.5	300	900	Ø100	40	100×85	80×60	77×45	Ø9	157	150	100	50
YKCT-MPH100SFBU	2.85										186	153.4	50
YKCT-MPH130RFU	2.6										130	-	-
YKCT-MPH130SFU	2.6	320	960	Ø130	40	100×85	80×60	77×45	Ø9	186	165	115	50
YKCT-MPH130SFBU	3										203	153.4	50
YKCT-MPH150RFU	2.8										150	-	-
YKCT-MPH150SFU	2.8	350	1050	Ø150	40	100×85	80×60	77×45	Ø9	206	175	125	50
YKCT-MPH150SFBU	3.2										203	153.4	50

경하중용
YKCT-SL SERIES

제품특징 FEATURES

- 이중 Ball Race Way 구조로 회전력이 우수
- Deluxe Mirage Wheel 부착으로 바닥에 자국이 남지 않으며 수명이 길고 소음이 없다.
- Excellent rotational force due to double ball race way structure
- The Deluxe Mirage Wheel attachment leaves no marks on the floor, has a long lifespan, and makes no noise.

적용범위 APPLICATION

- 병원의 고급 기자재 및 병원 침대용
- 컴퓨터 주변기기 및 최첨단 기계장비
- 연구소 및 대학 실험용 기자재
- For high-end hospital equipment and hospital beds
- Computer peripherals and cutting-edge mechanical equipment
- Equipment for laboratory and university experiments

모델설명 ORDERING CODE

YKCT - SL 40 RF/SF/SS/SFB/SSB

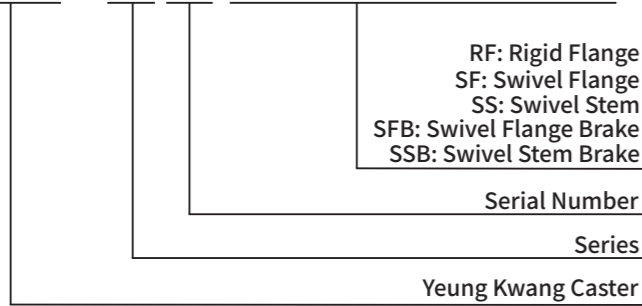

재질 MATERIAL & TREATMENT INFORMATION

No.	재질	표면처리
1	Caster seat	SPC Zn Galvanized
2	Body	SPC Zn Galvanized
3	Wheel	Poly Urethane + PC Transparent
4	Bolt	S10C Zn Galvanized
5	Brake	TPA Light Gray

* SUS제품 대응가능

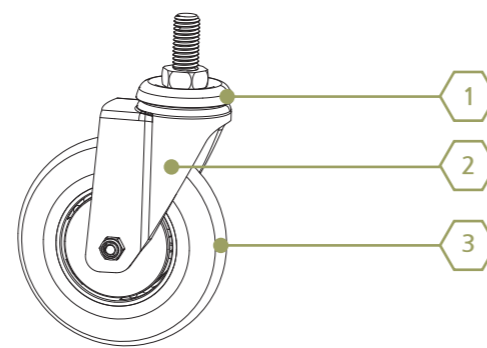
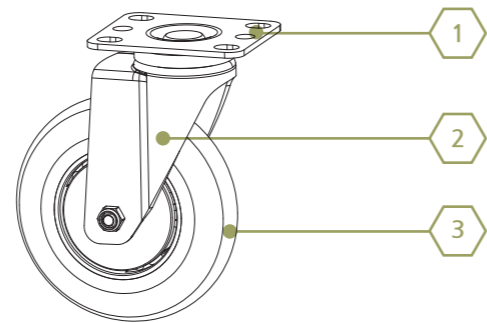
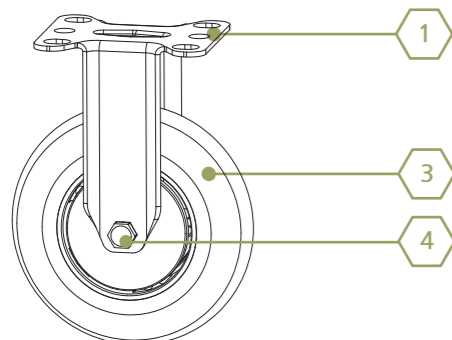

YKSL 40~50 SERIES



YKSL 64~76 SERIES



YKSL 100 SERIES



YKSL 125 SERIES

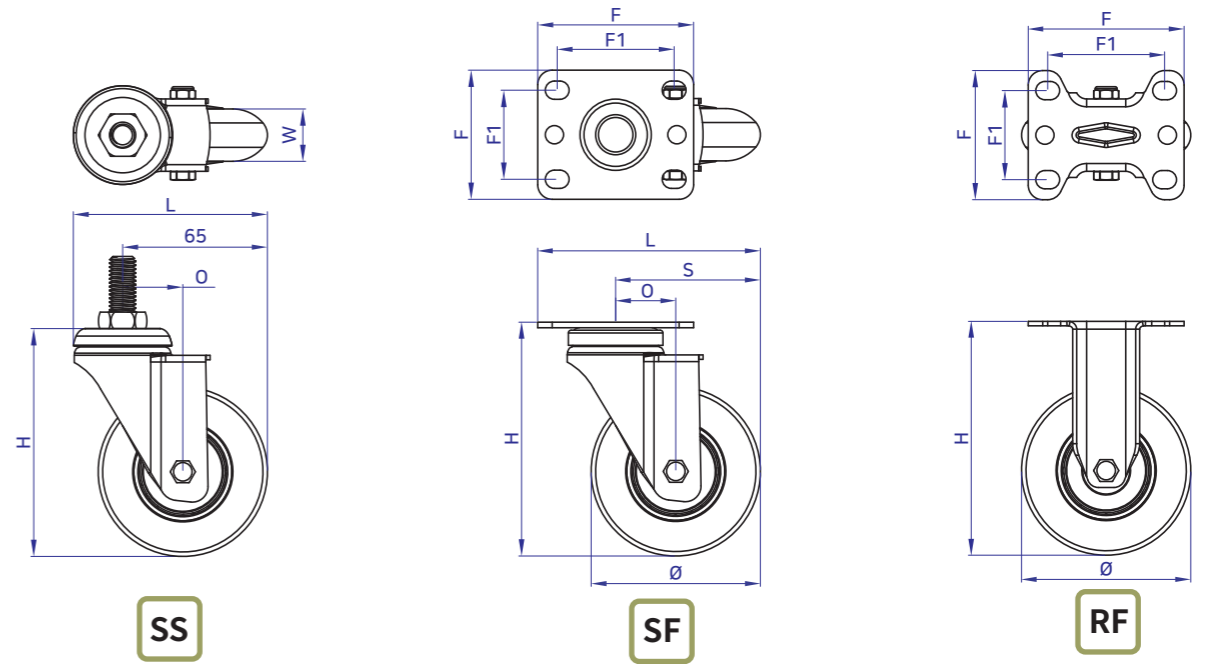

규격 DIMENSION

Code	자중 (Net weight) kg	Kg	a		HOLE			H	L			M	Y	
			Ø	W	F	F1	Hole		H	L	S			O
YKCT-SL40SF	0.1	20	60	Ø40	18	45x38	34x27	Ø5.2	53.5	62.5	40	20	-	-
YKCT-SL40SFB	0.11									83.5	61	20	-	-
YKCT-SL40RF	0.08									45	22.5	-	-	-
YKCT-SL40SS	0.09									56	40	20	M8	15
YKCT-SL40SSB	0.1	25	75	Ø50	18	45x38	34x27	Ø5.2	64.5	67.5	45	20	-	-
YKCT-SL50SF	0.11									86.5	64	20	-	-
YKCT-SL50RF	0.08									50	25	-	-	-
YKCT-SL50SS	0.1									60.5	45	20	M8	15
YKCT-SL50SSB	0.11	30	90	Ø63.5	23	70x58	53x40	Ø8x11 (slot hole)	90.5	80	64	20	-	-
YKCT-SL64SF	0.37									93	58.3	26.5	-	-
YKCT-SL64SFB	0.43									124.5	89.5	26.5	-	-
YKCT-SL64RF	0.22									70	35	-	-	-
YKCT-SL64SS	0.33	35	105	Ø76	23	70x58	53x40	Ø8x11 (slot hole)	105	80.5	58.3	26.5	M12	25
YKCT-SL64SSB	0.39									111.5	89.5	25.6	-	-
YKCT-SL76SF	0.41									100	65	27	-	-
YKCT-SL76SFB	0.46									124.5	89.5	27	-	-
YKCT-SL76RF	0.25	40	120	Ø98	23	70x58	53x40	Ø8x11 (slot hole)	127	76	38	-	-	-
YKCT-SL76SS	0.37									88.2	65	27	M12	25
YKCT-SL76SSB	0.43									111.5	89.5	27	-	-
YKCT-SL100SF	0.51									111	76	27	-	-
YKCT-SL100SFB	0.57	45	135	Ø123	23	70x58	53x40	Ø8x11 (slot hole)	155	132.8	97.8	27.5	-	-
YKCT-SL100RF	0.36									98	49	-	-	-
YKCT-SL100SS	0.48									98.2	76	27	M12	25
YKCT-SL100SSB	0.53									120	97.8	27	-	-
YKCT-SL125SF	0.61	45	135	Ø123	23	70x58	53x40	Ø8x11 (slot hole)	155	124	89	27.5	-	-
YKCT-SL125SFB	0.68									132.8	97.8	27.5	-	-
YKCT-SL125RF	0.48									123	61.5	-	-	-
YKCT-SL125SS	0.58									123	89	27.5	M12	25
YKCT-SL125SSB	0.65	131.8	97.8	27.5	-	-								

경하중용
YKCT-SM SERIES

제품특징 FEATURES

- 이중 Ball Race Way 구조로 회전력이 우수
- Deluxe Mirage Wheel 부착으로 바닥에 자국이 남지 않으며 수명이 길고 소음이 없다.
- Excellent rotational force due to double ball race way structure
- The Deluxe Mirage Wheel attachment leaves no marks on the floor, has a long lifespan, and makes no noise.

적용범위 APPLICATION

- 병원의 고급 기자재 및 병원 침대용
- 컴퓨터 주변기기 및 최첨단 기계장비
- 연구소 및 대학 실험용 기자재
- For high-end hospital equipment and hospital beds
- Computer peripherals and cutting-edge mechanical equipment
- Equipment for laboratory and university experiments

모델설명 ORDERING CODE

YKCT - SM 75 RF/SF/SS/SFB/SSB

RF: Rigid Flange
SF: Swivel Flange
SS: Swivel Stem
SFB: Swivel Flange Brake
SSB: Swivel Stem Brake

Serial Number

Series

Yeung Kwang Caster

재질 MATERIAL & TREATMENT INFORMATION

No.	재질	표면처리
① Caster seat	SPC	Zn Galvanized
② Body	SPC	Zn Galvanized
③ Wheel	Poly Urethane + PC	Transparent
④ Bolt	S10C	Zn Galvanized
⑤ Brake	TPA	Light Gray

- * SUS제품 대응가능
- * 정전기방지 제품 대응가능

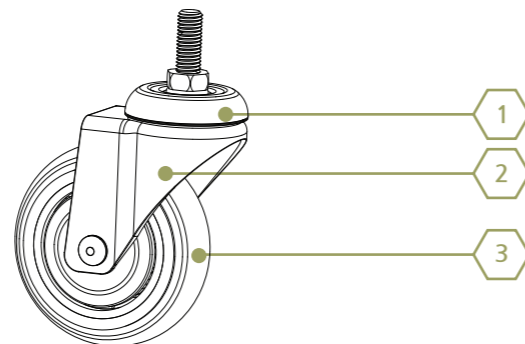
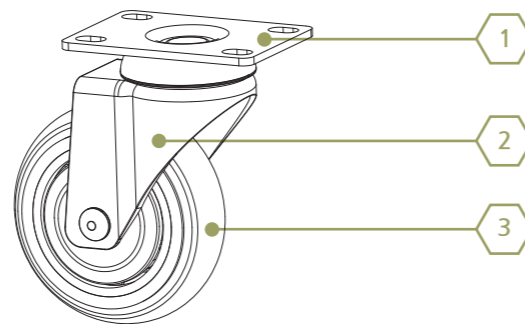
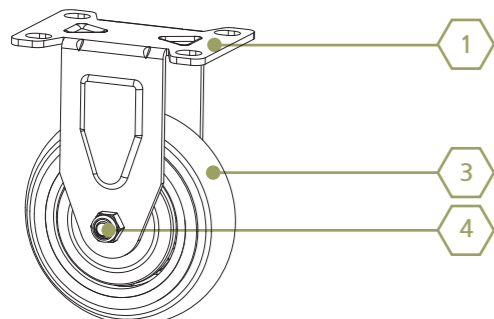

YKSM75 SERIES



YKSM100 SERIES



YKSM125 SERIES



YKSM150 SERIES

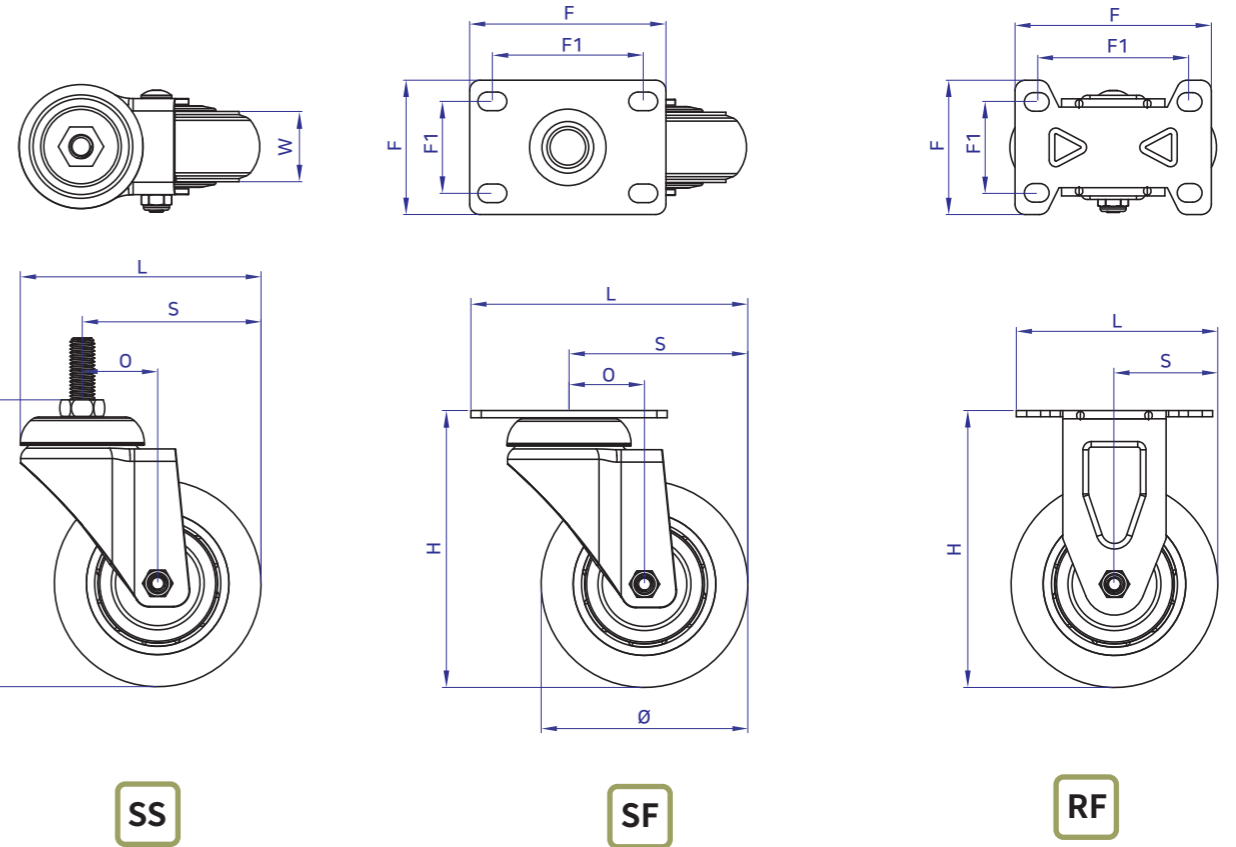

규격 DIMENSION

Code	자중 (Net weight) kg	Kg		Ø	W	HOLE			H	L	S	O	M	Y		
		1EA	4EA			F	F1	Hole								
YKCT-SM75SF	0.69	100	300	Ø75	34	95x65	73x44.5	Ø9x14 (slot hole)	108	125	77.5	40	-	-		
YKCT-SM75SFB	0.77									155	107.4	40				
YKCT-SM75RF	0.48									95	47.5	-				
YKCT-SM75SS	0.6									107.5	77.5	40			M12	30
YKCT-SM75SSB	0.69									137.4	107.4	40				
YKCT-SM100SF	0.82	110	330	Ø100	34	95x65	73x44.5	Ø9x14 (slot hole)	134	134	86.5	36.5	-	-		
YKCT-SM100SFB	0.9									154.4	107	36.5				
YKCT-SM100RF	0.6									100	50	-				
YKCT-SM100SS	0.72									116.5	86.5	36.5			M12	30
YKCT-SM100SSB	0.8									137	107.4	36.5				
YKCT-SM125SF	0.9	120	360	Ø125	34	95x65	73x44.5	Ø9x14 (slot hole)	158	148	100.5	38	-	-		
YKCT-SM125FB	0.99									154.4	107	38				
YKCT-SM125RF	0.69									125	62.5	-				
YKCT-SM125SS	0.83									130.5	100.5	38			M16	30
YKCT-SM125SSB	0.92									137	107.4	38				
YKCT-SM150SF	1.1	130	390	Ø150	34	95x65	73x44.5	Ø9x14 (slot hole)	186	159.2	111.7	36.7	-	-		
YKCT-SM150SFB	1.3									159.2	111.7	36.7				
YKCT-SM150RF	0.85									150	75	-				
YKCT-SM150SS	0.95									150	111.7	36.7			M16	30
YKCT-SM150SSB	1.1									150	111.7	36.7				

중하중용
YKCT-SH SERIES

제품특징 FEATURES

- 규격화된 Ball Bearing 사용으로 마찰력 감소와 회전력 우수
- 경량화된 우레탄 바퀴로 소음 및 충격 흡수에 강함
- Reduced friction and excellent rotational force by using standardized ball bearings
- Lightweight urethane wheels are strong at absorbing noise and shock

적용범위 APPLICATION

- 다양한 산업용 운반구 사용
- Use of various industrial transport equipment

모델설명 ORDERING CODE

YKCT - SH 100 RF/SF/SFB

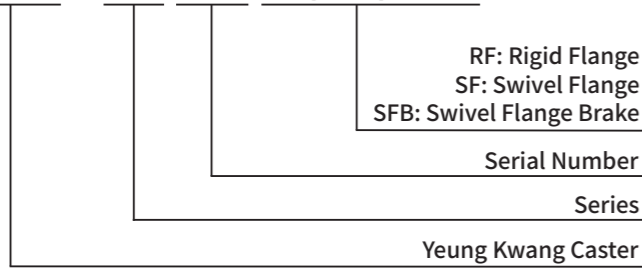

YKSH100 SERIES



YKSH125 SERIES



YKSH150 SERIES

재질 MATERIAL & TREATMENT INFORMATION

No.	재질	표면처리
① Caster seat	SPC	Zn Galvanized
② Body	SPC	Zn Galvanized
③ Wheel	Poly Urethane + PC	Green(TUD)
④ Bolt	S10C	Zn Galvanized
⑤ Brake	TPA	Light Gray

※ 바퀴옵션
MUD : Poly Urethane + AL 다이캐스팅 코어
MUDE : Antistatic Poly Urethane + AL 다이캐스팅 코어
※ SUS제품 대응가능

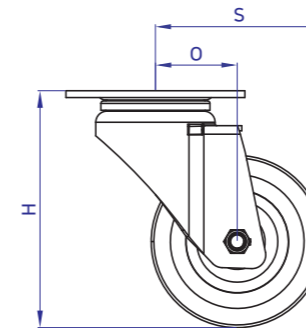
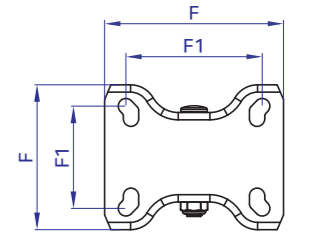
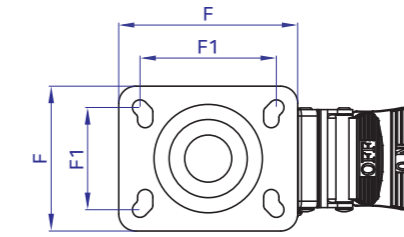
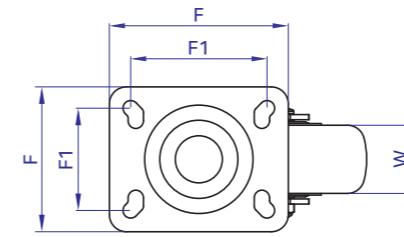
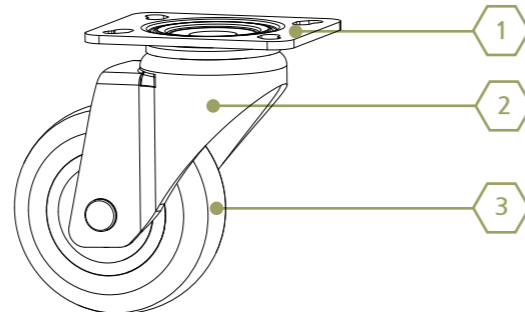
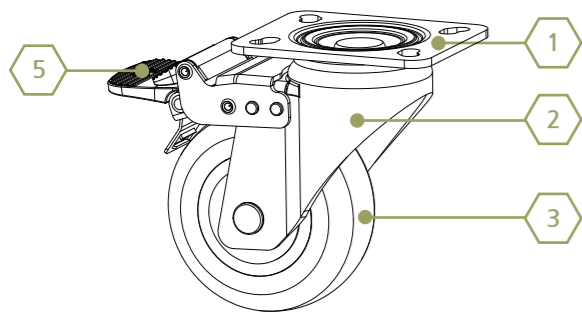
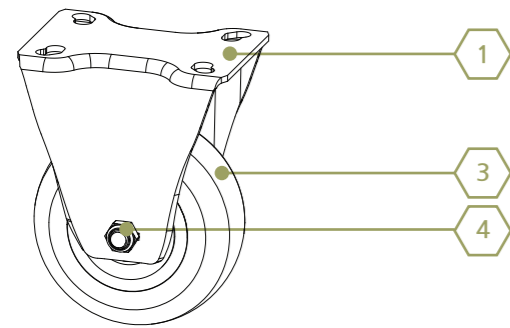

SS

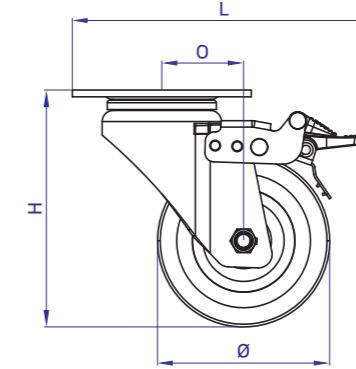

SF

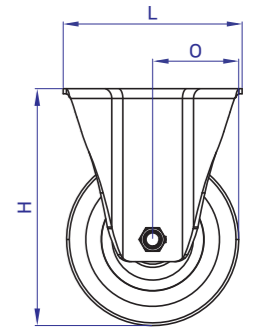

RF

규격 DIMENSION

Code	자중 (Net weight) kg	Kg		HOLE		HOLE		Hole	H	L	S	O
		1EA	4EA	∅	W	F	F1					
YKCT-SH100SF	1.14	240	600	∅100	40	105x85	80x60 74x45	∅9x12 (slot hole)	139	151	98.5	48
YKCT-SH100SFB	1.3									178.5	126	
YKCT-SH100RF	0.8	270	690	∅125	40	105x85	80x60 74x45	∅9x12 (slot hole)	167.5	105	52.5	-
YKCT-SH125SF	1.27									158	105.5	42.5
YKCT-SH125SFB	1.44	0.95	-	-	-	-	-	-	-	178.5	126	
YKCT-SH125RF	0.95									125	62.5	
YKCT-SH150SF	1.6	3000	750	∅150	40	105x85	80x60 74x45	∅9x12 (slot hole)	191	164.5	112	32.5
YKCT-SH150SFB	1.43									178.5	126	
YKCT-SH150RF	1.1	-	-	-	-	-	-	-	-	150	75	-

중하중용
YKCT-G80 SERIES

제품특징 FEATURES

- 이중 Ball race way 구조로 회전력 우수.
- 고하중용, 낮은높이의 안전성 구조.
- 아연도금.
- Excellent rotational power with double ball raceway structure.
- High load, low height safety construction.
- galvanizing.

적용범위 APPLICATION

- 병원용 고급 기자재, 전산용기기.
- 컴퓨터 주변기기 및 첨단 기계장비.
- 연구소 및 방송기자재, 운반도비
- Advanced hospital equipment, computer equipment.
- Computer peripherals and advanced mechanical equipment.
- Laboratories and broadcasting equipment, transportation costs

모델설명 ORDERING CODE

YKCT - G 8030 / 8040

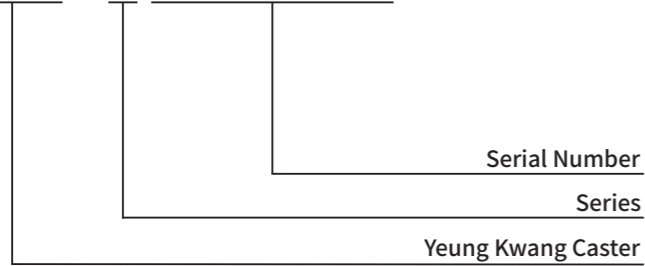

8030



8040

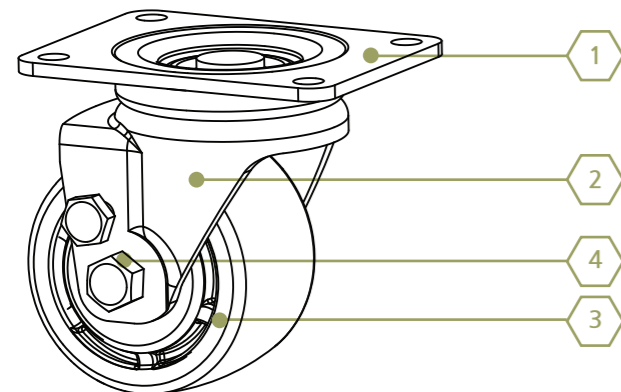

재질 MATERIAL & TREATMENT INFORMATION

No.	재질	표면처리
1	Caster seat	SPHC Zn Galvanized
2	Body	SPHC Zn Galvanized
3	Wheel	HDP Black
4	Bolt	S10C Zn Galvanized

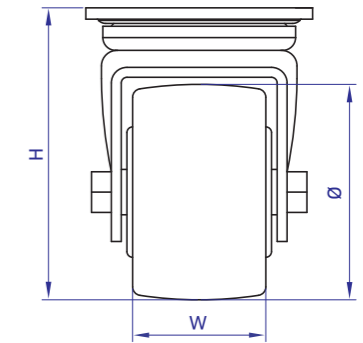
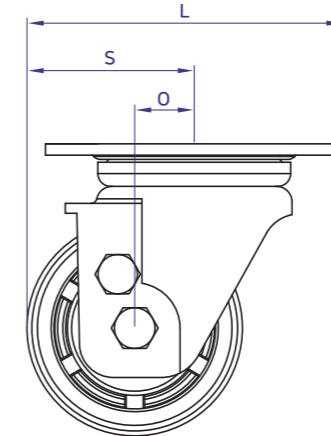
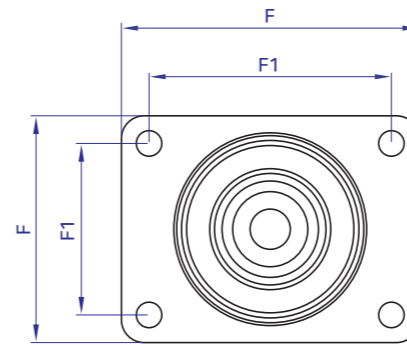

규격 DIMENSION

Code	자중 (Net weight) kg	Kg		Ø	W	HOLE			H	L	S	O
		1EA	4EA			F	F1	Hole				
YKCT-G8030	-	250	750	Ø76	47	105x80	85.5x60.5	Ø9	103	111.5	59	21
YKCT-8040	-	300	900	Ø102	47	105x80	85.5x60.5	Ø9	130	130.5	78	27

중하중용
YKCT-CK SERIES

제품특징 FEATURES

- 이중 Ball race way 구조로 회전력 우수.
- 고하중용, 낮은높이의 안전성 구조.
- 아연도금.
- Excellent rotational power with double ball raceway structure.
- High load, low height safety construction.
- galvanizing.

적용범위 APPLICATION

- 병원용 고급 기자재, 전산용기기.
- 컴퓨터 주변기기 및 첨단 기계장비.
- 연구소 및 방송기자재, 운반도비
- Advanced hospital equipment, computer equipment.
- Computer peripherals and advanced mechanical equipment.
- Laboratories and broadcasting equipment, transportation costs

모델설명 ORDERING CODE

YKCT - CK 65 SF

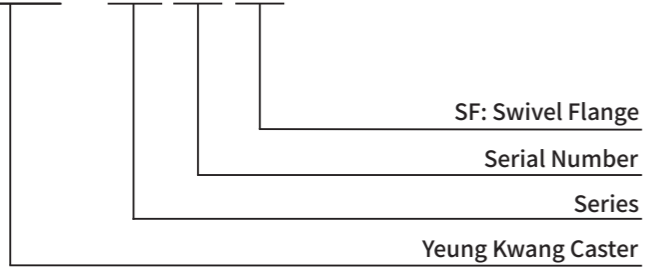

SF: Swivel Flange
Serial Number
Series
Yeung Kwang Caster



재질 MATERIAL & TREATMENT INFORMATION

No.	재질	표면처리
1 Caster seat	SPHC	Zn Galvanized
2 Body	SPHC	Zn Galvanized
3 Wheel	H : 강화플라스틱 (65SF / 75SF / 100SF) M : M/C Nylon (100SF)	Black
4 Bolt	S10C	Zn Galvanized

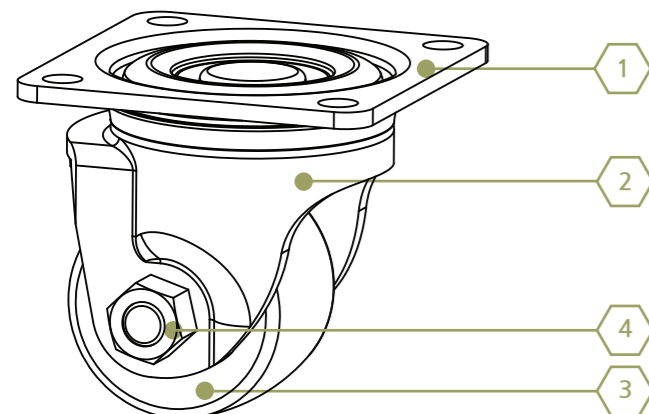

65SF

75SF

100SF

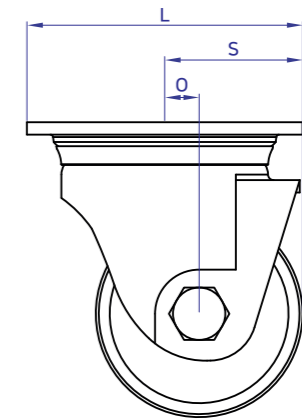
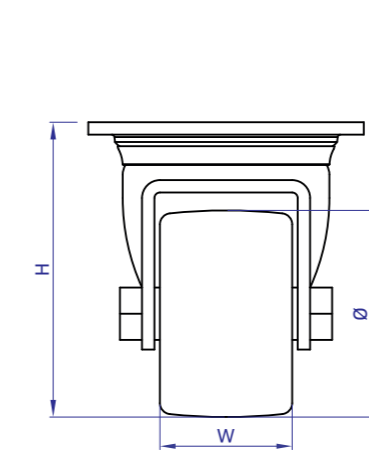
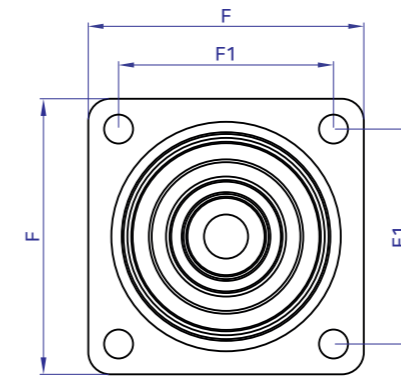

규격 DIMENSION

Code	자중 (Net weight) kg	Kg		Ø	W	F	F1	Hole	H	L	S	O
		1EA	4EA									
YKCT-CKZJ65SFH	-	500	1500	Ø65	48	100x100	78x78	Ø10.5	97	100	46.5	14
YKCT-CK75SF	-	600	1800	Ø75	48	100x100	78x78	Ø10.5	107	100	51.5	14
YKCT-CK100SF	-	900	2700	Ø100	48	150x110	121x59	Ø13	140	150	70	20

고하중용
YKCT-PH-80~100

제품특징 FEATURES

- 고하중에서도 안정적인 주행가능
- Run smoothly under hight duty

적용범위 APPLICATION

- 고하중용 장비, 클린룸장비
- 고하중용 대차, 각종 기계장비
- High duty equipment, Clean room equipment
- High duty carriage, various mechanical equipment

모델설명 ORDERING CODE

YKCT - PH80 RF/SF/SFB M/U

M: Mc Nylon
U: Urethane(A)
RF: Rigid Flange
SF: Swivel Flange
SFB: Swivel Flange Brake

Series

Yeung Kwang Caster



80SFM~100SFM



80SFU~100SFU

재질 MATERIAL & TREATMENT INFORMATION

No.	재질	표면처리
①	Caster seat	S45C Black Coated
②	Body	S45C Black Coated
③	Wheel	Poly Urethane+AL / Mc Nylon
④	Brake	TPE

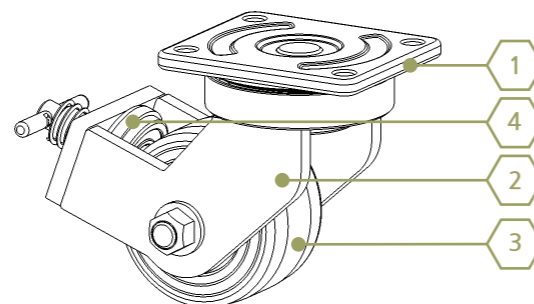
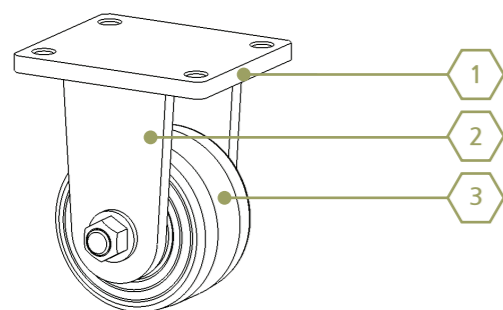
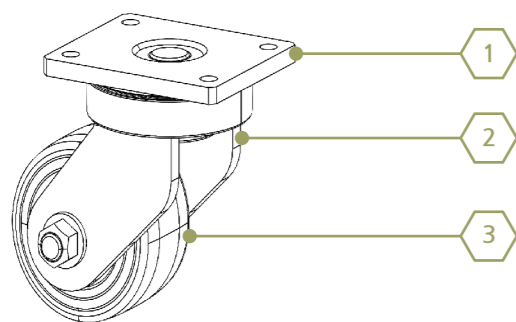

80SF-M

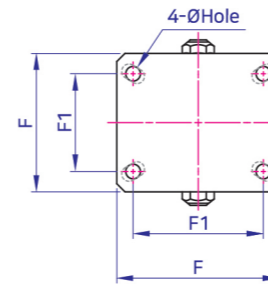

80SFB-M

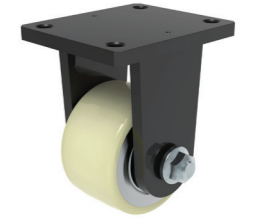
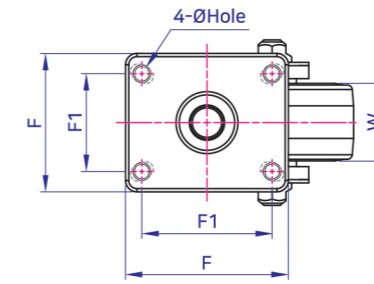

80RF-U

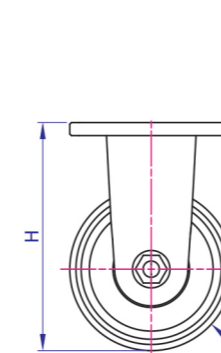
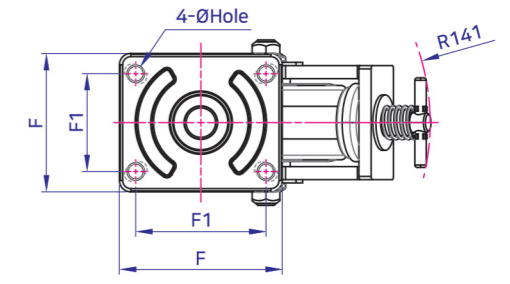

RF

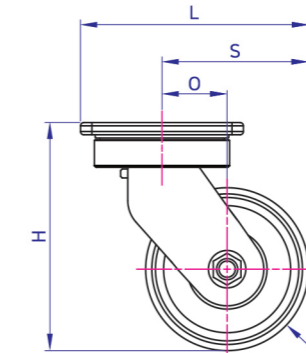

SF

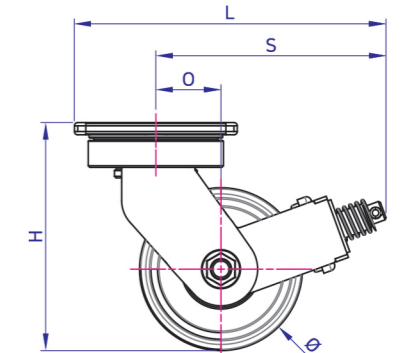

SFB

규격 DIMENSION

Code	자중 (Net weight) kg	Kg		Technical Drawing 1				Technical Drawing 2				
		1EA	4EA	Ø	W	F	F1	Hole	H	L	S	O
YKCT-PH80RFU	1.9			Ø80	48	100x85	80x60	Ø9	120	100	-	-
YKCT-PH80SFU	2.6	500	1500							130	80	40
YKCT-PH80SFB	3.6									182	132	40
YKCT-PH80RFM	1.8									100	-	-
YKCT-PH80SFM	2.5	800	2400						130	80	40	
YKCT-PH80SFBM	3.5								182	132	40	
YKCT-PH100RFU	2.2			Ø100	48	100x85	80x60	Ø9	140	100	-	-
YKCT-PH100SFU	2.5	600	1800							140	90	40
YKCT-PH100SFB	3.9									192	141	40
YKCT-PH100RFM	2.1									100	-	-
YKCT-PH100SFM	2.7	900	2700						140	90	40	
YKCT-PH100SFBM	3.7								192	141	40	

고하중용
YKCT-PH-125~200

제품특징 FEATURES

- 고하중에서도 안정적인 주행가능
- Run smoothly under high duty

적용범위 APPLICATION

- 고하중용 장비, 클린룸장비
- 고하중용 대차, 각종 기계장비
- High duty equipment, Clean room equipment
- High duty carriage, various mechanical equipment

모델설명 ORDERING CODE

YKCT - PH125 RF/SF/SFB M/U

M: Mc Nylon
U: Urethane(A)
RF: Rigid Flange
SF: Swivel Flange
SFB: Swivel Flange Brake

Series

Yeung Kwang Caster

재질 MATERIAL & TREATMENT INFORMATION

No.	재질	표면처리
1 Caster seat	S45C	Black Coated
2 Body	S45C	Black Coated
3 Wheel	Poly Urethane+AL / Mc Nylon	-
4 Brake	TPE	-

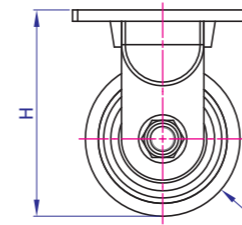
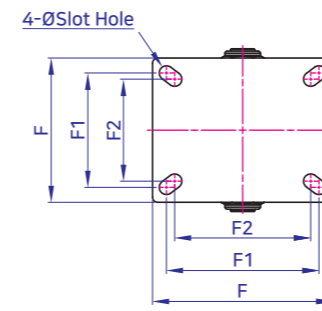
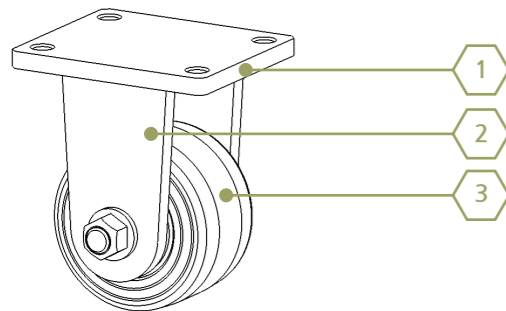
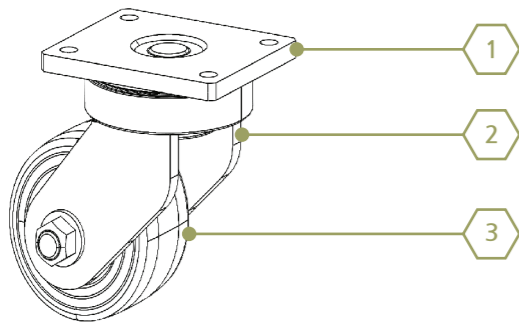

RF-M(U)

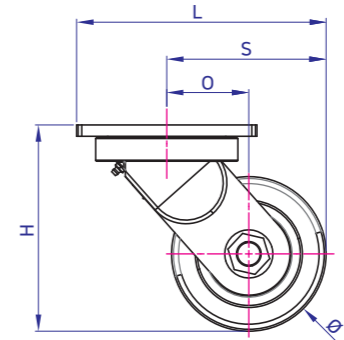
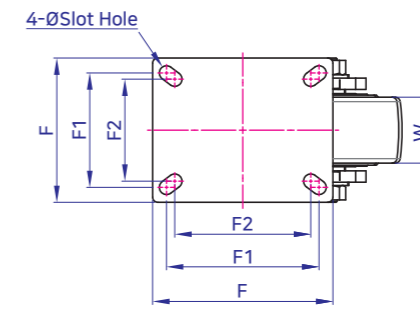

SF-M(U)

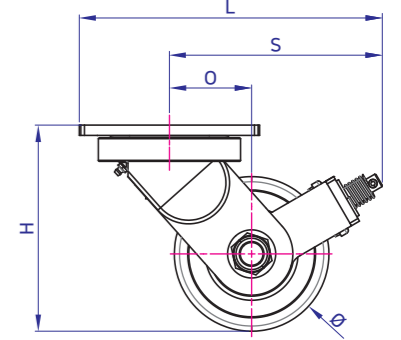
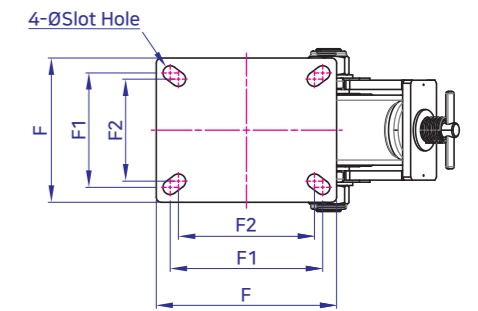

SFB-M(U)

규격 DIMENSION

Code	자중 (Net weight) kg	Kg		Hole		Hole		Hole	H	L	S	O
		1EA	4EA	Ø	W	F	F1					
YKCT-PH125RFU	6									175	-	-
YKCT-PH125SFU	9.5	1100	3300							227.5	140	77.5
YKCT-PH125SFBU	10.5			Ø125	70	175x140	148x111	132x99	Ø14x24L (Slot Hole)	290	203	
YKCT-PH125RFM	5.5									175	-	-
YKCT-PH125SFM	9	1500	4500							227.5	140	77.5
YKCT-PH125SFBM	10									290	203	
YKCT-PH150RFU	7									175	-	-
YKCT-PH150SFU	8.7	1500	4500		68					210.5	155	48
YKCT-PH150SFBU	9.7			Ø150		175x140	148x111	132x99	Ø14x24L (Slot Hole)	267	207	
YKCT-PH150RFM	6.1									175	-	-
YKCT-PH150SFM	9.6	2200	6600		70					242.5	155	80
YKCT-PH150SFBM	10.6									294	207	
YKCT-PH200RFU	9.6									200	-	-
YKCT-PH200SFU	13.1	2000	6000		68					247.5	175	60
YKCT-PH200SFBU	14.1			Ø200		175x140	148x111	132x99	Ø14x24L (Slot Hole)	296	224	
YKCT-PH200RFM	7.5									200	-	-
YKCT-PH200SFM	11	2500	7500		70					262.5	175	75
YKCT-PH200SFBM	12									311	224	

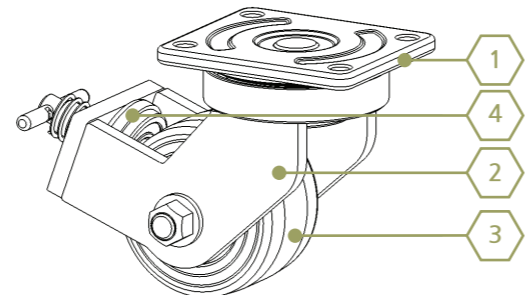

고하중용
YKCT-PH40 SERIES

제품특징 FEATURES

- 구름성과 회전성 우수, 저소음, 저마찰
- Excellent performance in rotation & rolling
- Low noise and friction

적용범위 APPLICATION

- 반도체 제조장비 전자부품 생산설비 현상기 실험장비
이화학기기, 의료기기, 각종운반차
- Semiconductor equipment, Electronic production facilities,
Developing machines, Laboratory equipment, Physico-chemistry
equipment, Medical devices, Various transport carriage.

모델설명 ORDERING CODE

YKCT - PH40 75 SF/RF M/U

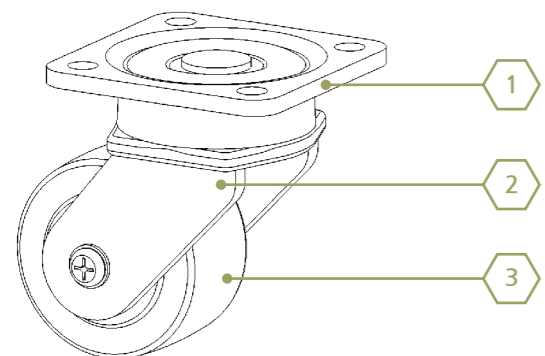
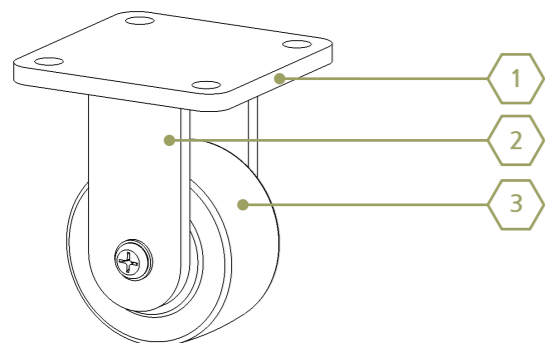
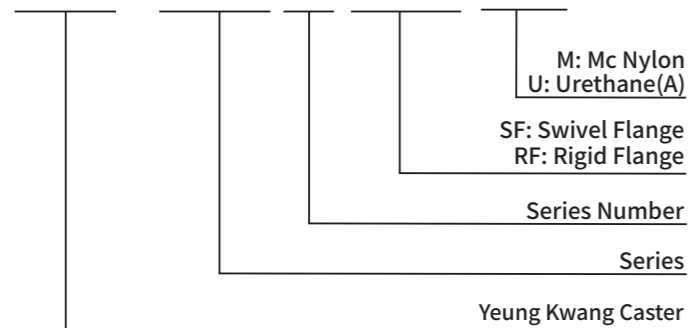

재질 MATERIAL & TREATMENT INFORMATION

No.	재질	표면처리
① Caster seat	SPC	Black Coated
② Body	S45C	Black Coated
③ Wheel	Poly Urethane+AL / Mc Nylon	-



100SF-M



100SF-U



75RF



75SF-U



125SF-U



150SF-M

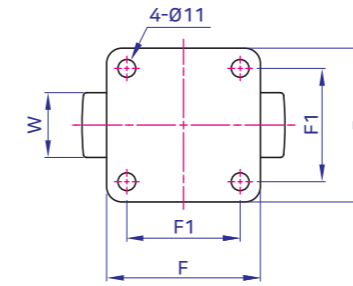

RF

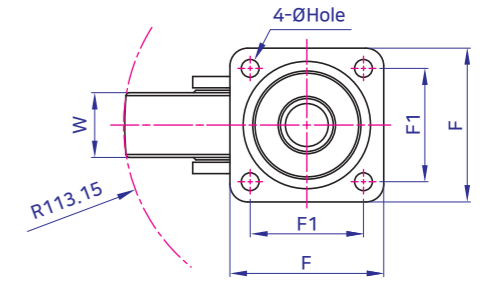
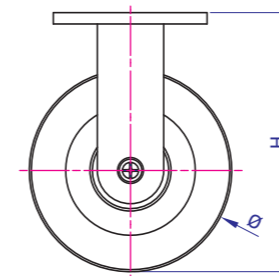

SF

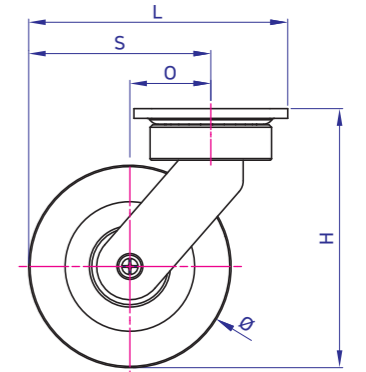

규격 DIMENSION

Code	자중 (Net weight)	Kg		Ø		HOLE		Hole	H	L	S	O						
	kg	1EA	4EA	Ø	W	F	F1											
YKCT-PH40-75RFU	1.3	400	1200	Ø75	40	95x95	70x70	Ø11.5	113	95	-	-						
YKCT-PH40-75SFU	1.8				48					119	72.5	34						
YKCT-PH40-75RFM	1.2	650	1950		40					95	-	-						
YKCT-PH40-75SFM	1.7				48					119	72.5	34						
YKCT-PH40-100RFU	1.4	450	1350	Ø100	40				95x95	70x70	Ø11.5	138	100	-	-			
YKCT-PH40-100SFU	2.1				48								137	90	39.5			
YKCT-PH40-100RFM	1.4	700	2100		40								100	-	-			
YKCT-PH40-100SFM	1.9				48								137	90	39.5			
YKCT-PH40-125RFU	1.7	500	1500	Ø130	40							95x95	70x70	Ø11.5	162.5	125	-	-
YKCT-PH40-125SFU	2.3				48											154.5	112.5	44.5
YKCT-PH40-125RFM	1.6	750	2250		40											125	-	-
YKCT-PH40-125SFM	2.2				48											154.5	112.5	44.5
YKCT-PH40-150RFU	2	550	1650	Ø150	40	95x95	70x70	Ø11.5							185	150	-	-
YKCT-PH40-150SFU	2.5				48											170.5	125	48
YKCT-PH40-150RFM	1.9	800	2400		40											150	-	-
YKCT-PH40-150SFM	2.4				48											170.5	125	48

고하중용
YKCT-PH40T SERIES

제품특징 FEATURES

- 높이가 낮고 소음과 마찰이 적어 고하중에 적합.
- 트윈 휠을 적용하여 회전성 우수.
- Being available for equipment with low-height, low noise & friction, heavy
- Load Twin wheel being excellent performance in circling

적용범위 APPLICATION

- 높이 제한이 있는 장비, 각종 기계 장비, 각종 운반차.
- Being suitable for equipment with height limit, various machinery and equipment.

모델설명 ORDERING CODE

YKCT - PH40T 75 SF/RF M/U

M: Mc Nylon
U: Urethane(A)
SF: Swivel Flange
RF: Rigid Flange

Series Number

Series

Yeung Kwang Caster



75~150RF-U



75~150SF-M

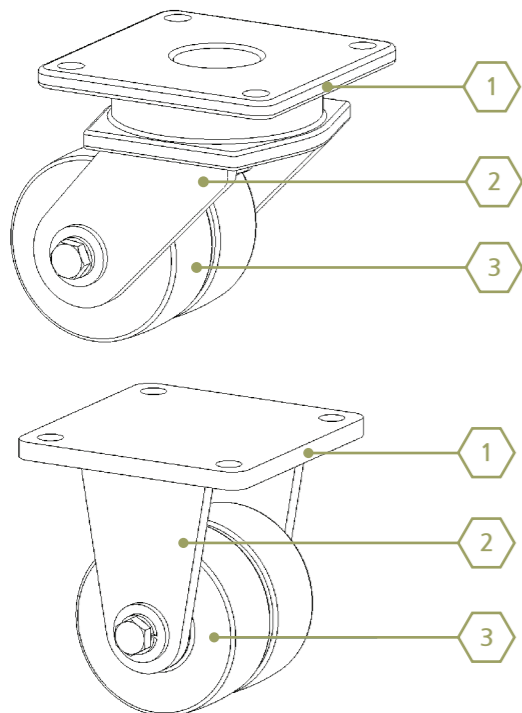

재질 MATERIAL & TREATMENT INFORMATION

No.	재질	표면처리
① Caster seat	S45C	Black Coated
② Body	S45C	Black Coated
③ Wheel	Poly Urethane+AL / Mc Nylon	-

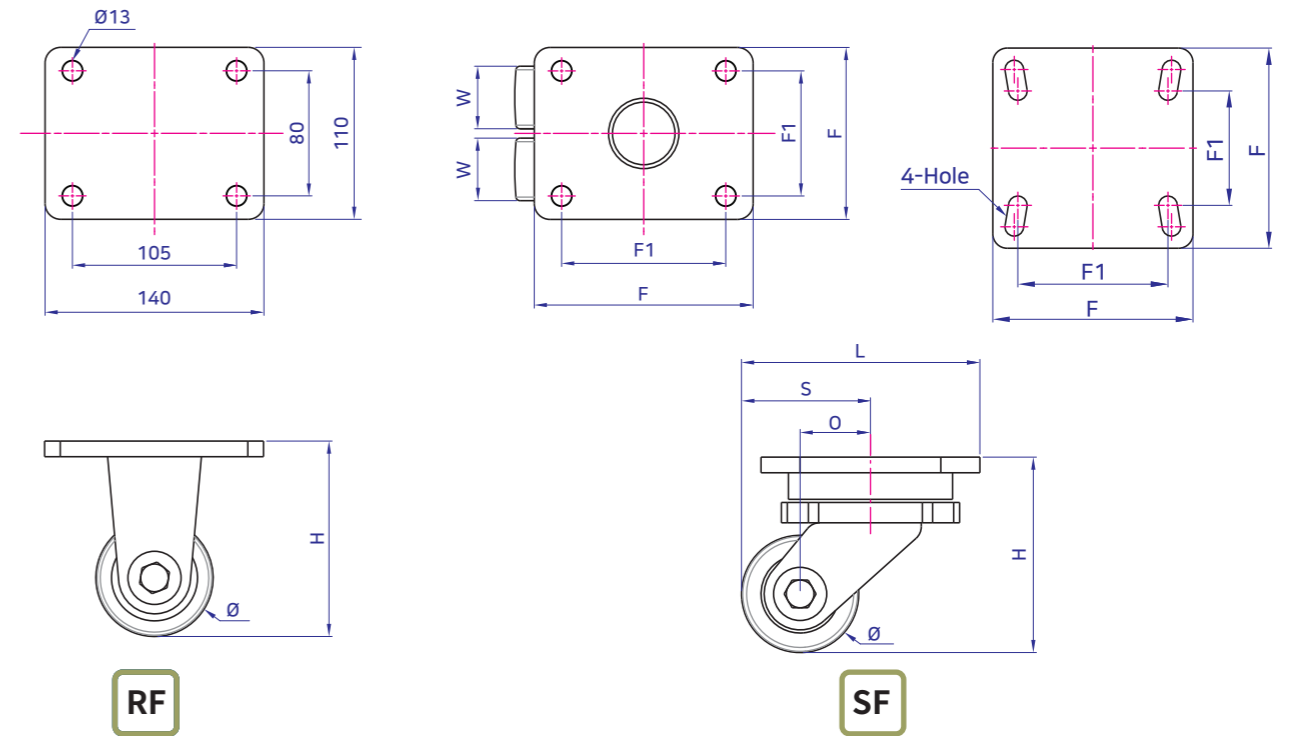

규격 DIMENSION

Code	자중 (Net weight) kg	Kg		Ø		F		Hole	H	S		
		1EA	4EA	W	F1	L	S			O		
YKCT-PH40T-75RFU	3.8	800	2400	Ø75	40x2	140x110	105x80	Ø13x30L	125	140	-	-
YKCT-PH40T-75SFU	6									153	82.5	45
YKCT-PH40T-75RFM	3.7	1700	5100							140	-	-
YKCT-PH40T-75SFM	5.9									153	82.5	45
YKCT-PH40T-100RFU	4.4	1000	3000	Ø100	40x2	140x140	110x110	Slot hole	150	140	-	-
YKCT-PH40T-100SFU	6.6									170	100	50
YKCT-PH40T-100RFM	4.1	1900	5700							140	-	-
YKCT-PH40T-100SFM	6.3									170	100	50
YKCT-PH40T-125RFU	4.9	1200	3600	Ø125	40x2	140x140	110x110	Slot hole	175	140	-	-
YKCT-PH40T-125SFU	6.9									188	117.5	55
YKCT-PH40T-125RFM	4.6	2100	6300							140	-	-
YKCT-PH40T-125SFM	6.8									188	117.5	55
YKCT-PH40T-150RFU	5	1400	4200	Ø150	40x2	140x140	110x110	Slot hole	200	150	-	-
YKCT-PH40T-150SFU	7.3									205	135	60
YKCT-PH40T-150RFM	4.7	2300	6900							150	-	-
YKCT-PH40T-150SFM	7									205	135	60

회전용
YKCT-GTAS4-AF

제품특징 FEATURES

- 이중 Ball race way 구조로 회전력 우수.
- 고하중용, 낮은높이의 안전성 구조.
- 아연도금.
- Excellent rotational power with double ball raceway structure.
- High load, low height safety construction.
- galvanizing.

적용범위 APPLICATION

- 병원용 고급 기자재, 전산용기기.
- 컴퓨터 주변기기 및 첨단 기계장비.
- 연구소 및 방송기자재, 운반도비
- Advanced hospital equipment, computer equipment.
- Computer peripherals and advanced mechanical equipment.
- Laboratories and broadcasting equipment, transportation costs

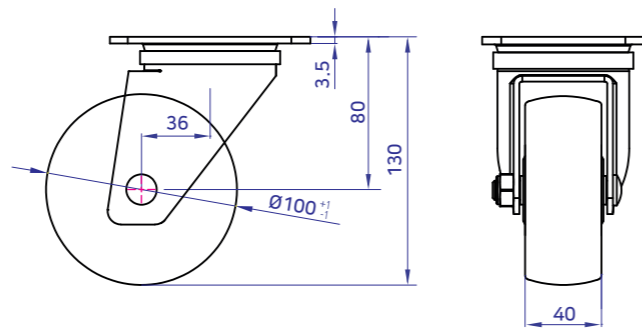
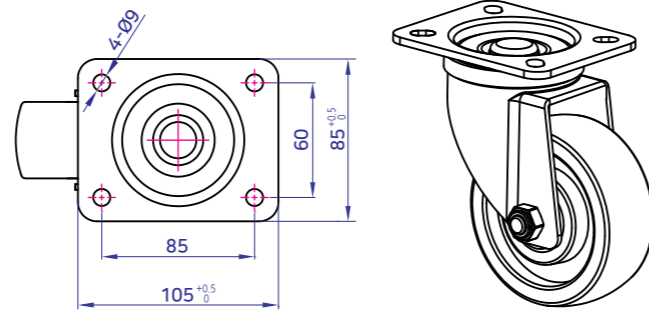
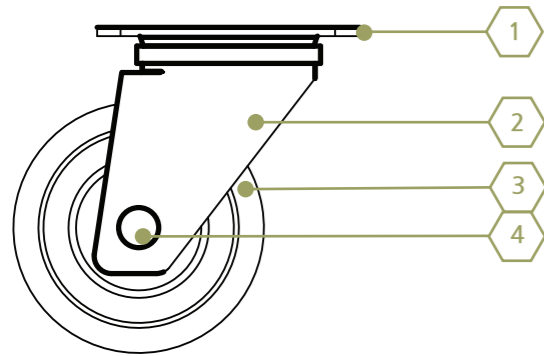

재질 MATERIAL & TREATMENT INFORMATION

No.	재질	표면처리
① Caster seat	SPC	Zn Galvanized
② Body	SPC	Zn Galvanized
③ Wheel	Poly Urethane + AL	RED
④ Bolt	S10C	Zn Galvanized

규격 DIMENSION

Code	자중 (Net weight) kg	Kg		Ø		HOLE			H	L	S	O
		1EA	4EA	Ø	W	F	F1	Hole				
YKCT-GTAS4-AF	-	400	1200	Ø99	40	105.5x85.5	85x60	Ø9	129	138	85.5	36

기타
YKCT-PHLS40

제품특징 FEATURES

- 수월한 이동성, 고정성, 높낮이 조절 및 360° 회전 일체형.
- 큰폭의 높낮이 조절이 가능.
- 상·하측 육각부로 장비장착시 조립 용이.
- 다양한 중하중시리즈 부착 가능.
- Easy mobility, fixation, height adjustment and 360° rotation all in one
- Large height adjustment possible..
- Easy assembly when installing equipment with upper and lower hexagonal parts.
- A variety of heavy load series can be attached.

적용범위 APPLICATION

- 반도체 제조장비, 전자부품 생산설비.
- 현상기, 실험장비, 이화학기기.
- Semiconductor manufacturing equipment, electronic component production equipment.
- Developer, experimental equipment, physical and chemical equipment.

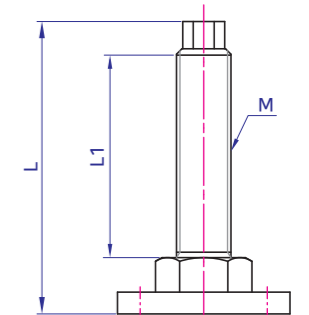
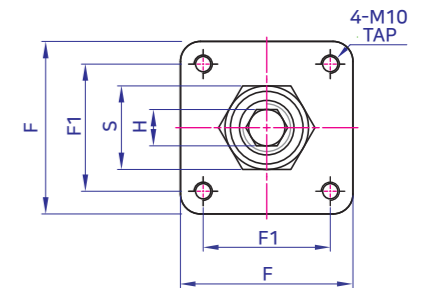
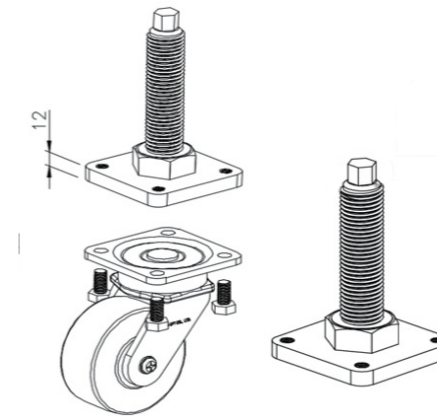

재질 MATERIAL & TREATMENT INFORMATION

No.	재질
① Bolt	S45C
② Plate	S45C
③ Wheel	Poly Urethane + AL / Mc Nylon
④ Body	SPC

규격 DIMENSION

Code	Kg		HOLE			M		
	1EA	4EA	F	F1	TAP	L	L1	M
YKCT-PHLS40	PH40-100SFM		95x95	70x70	M10	161	115	M30x3.5P M32x4P

MODEL	① BOLT		② PLATE	
	Material	Treatments	Material	Treatments
PHLS 32	S45C	니켈도금	SS400	니켈도금

* option : 주문생산 가능

높낮이 조절용 YKCT-A 40~100

제품특징 FEATURES

- 손쉬운 이동과 고정 높낮이 조절, 방진 및 360도 회전 기능 일체화.
- 휠 커버 사용으로 오염이 적음.
- Easy moving, fixing, adjustable height, anti-vibration and 360°rotation all-in-one.
- Less contamination due to wheel cover use.

적용범위 APPLICATION

- 알루미늄 프로파일로 제작된 프레임, 자동화장비, 반도체 / 디스플레이 제조장비, 컨베이어등.
- Aluminium frames with profile, Automation equipment, Semiconductor / Display manufacturing, Conveyors, etc.

모델설명 ORDERING CODE

YKCT - A 40 F/S

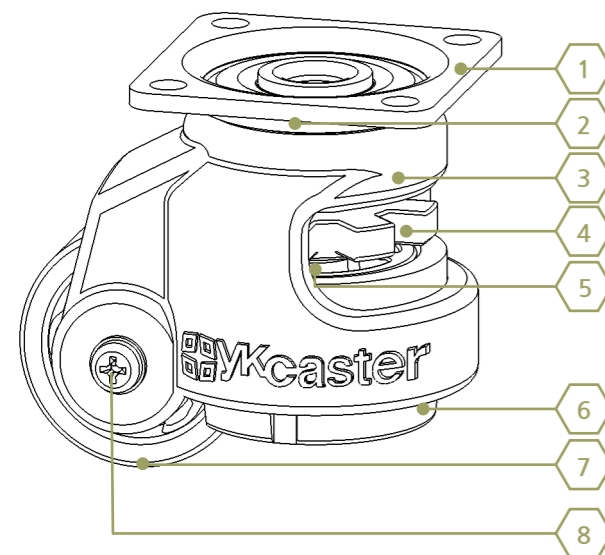
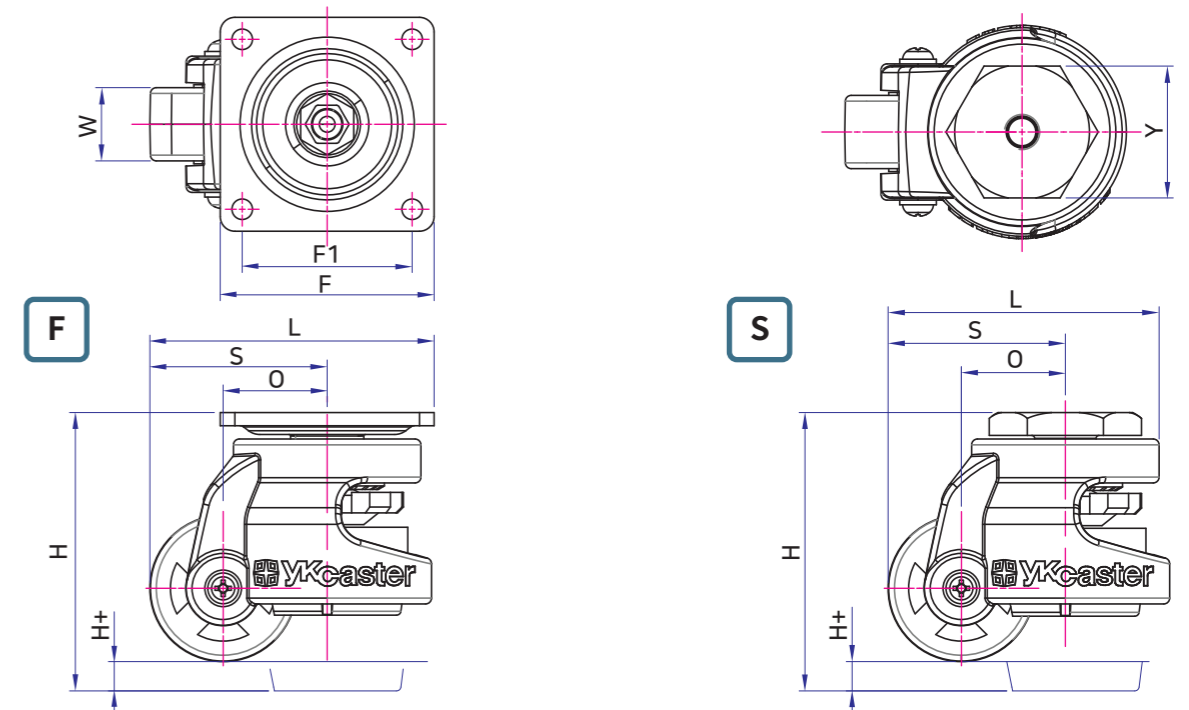
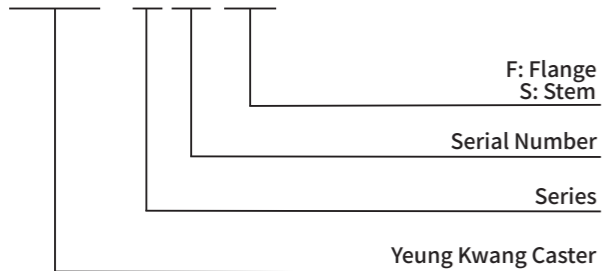

재질 MATERIAL & TREATMENT INFORMATION

No.	재질	표면처리
1	SPC & S45C	무전해니켈
2	STB2	Ni-Cr
3	ALDC12	Ivory / Powder Coated
4	PA6	무전해니켈
5	Swrch10A	무전해니켈
6	NBR	Black
7	PA6	Black
8	S10C	무전해니켈

* Option: Wheel: Antistatic Poly Urethane

규격 DIMENSION

Code	자중 (Net weight) kg	Kg		W	F	F1	Hole	Tap (Order)	X	Y	H+H	L	S	O
		1EA	4EA											
YKCT-A40F	0.36	50	100	19	55x55	42x42	Ø6.5	-	-	-	71+10	79.5	51	30
YKCT-A40S	0.37	-	-	-	-	-	-	M8 (M12)	46	40	-	-	-	-
YKCT-A60F	0.67	250	500	25	73x73	58x58	Ø7 (Ø8.5)	-	-	-	82+10	97	60.5	35.5
YKCT-A60S	0.62	-	-	-	-	-	-	M12 (M16)	52	45	-	-	-	-
YKCT-A80F	1.19	500	1000	29	90x90	70x70	Ø9	-	-	-	103+10	121.6	76.6	45
YKCT-A80S	1.11	-	-	-	-	-	-	M12 (M16)	70	65	-	-	-	-
YKCT-A100F	1.65	750	1500	30	95x95	70x70	Ø11	-	-	-	120+12	141	90	53
YKCT-A100S	1.55	-	-	-	-	-	-	M16	70	65	-	-	-	-

높낮이 조절용 YKCT-A 120~150

제품특징 FEATURES

- 손쉬운 이동과 고정 높낮이 조절, 방진 및 360도 회전 기능 일체화.
- 휠 커버 사용으로 오염이 적음.
- Easy moving, fixing, adjustable height, anti-vibration and 360°rotation all-in-one.
- Less contamination due to wheel cover use.

적용범위 APPLICATION

- 알루미늄 프로파일로 제작된 프레임, 자동화장비, 반도체 / 디스플레이 제조장비, 컨베이어등.
- Aluminium frames with profile, Automation equipment, Semiconductor / Display manufacturing, Conveyors, etc.

모델설명 ORDERING CODE

YKCT - A 120 F/S

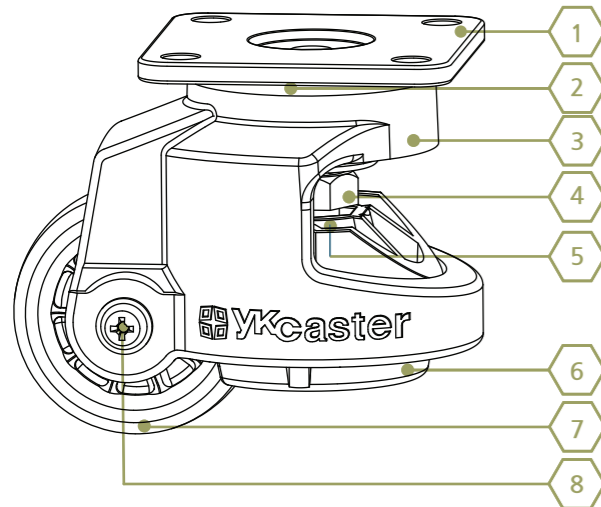
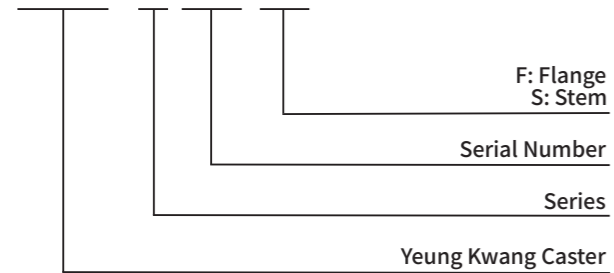

재질 MATERIAL & TREATMENT INFORMATION

No.	재질	표면처리		
1	Caster seat	SPC & S45C	무전해 니켈도금	
2	Ball	STB2	Ni-Cr	
3	Body	ALDC12	Hammertone	
4	Handle	S45C	무전해 니켈도금	
5	Rod	Swrch10A	무전해 니켈도금	
6	Pad	120	PA6	Black
		150	ALDC12	Black
7	Wheel	120	PA6	Black
		150	Mc Nylon	BLUE
8	Pin	S10C	무전해 니켈도금	

* Option: Wheel: Antistatic Poly Urethane
YKA-150F : SUS Bearing Type



120F



150FM



120S



120S



150FM

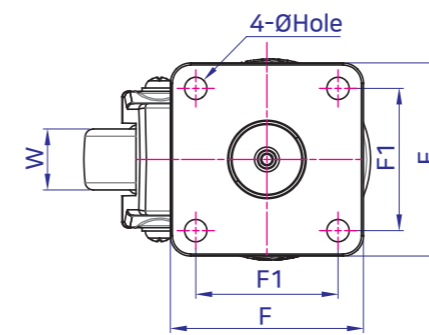

120F

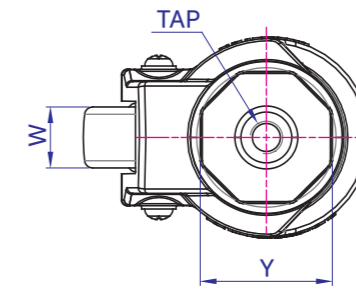

120S

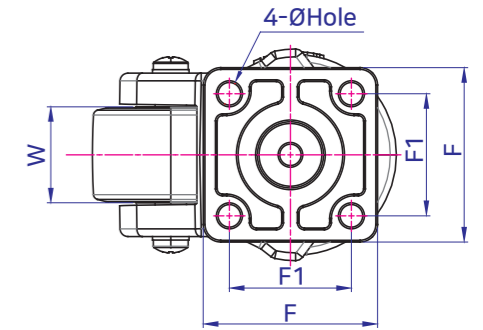

150F-M

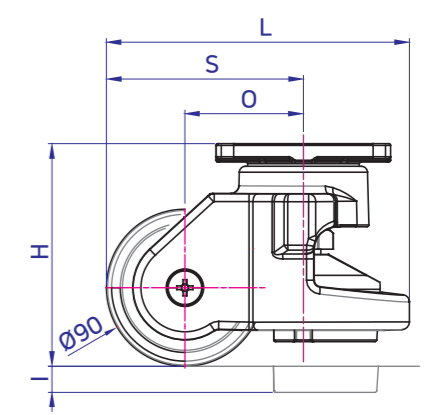
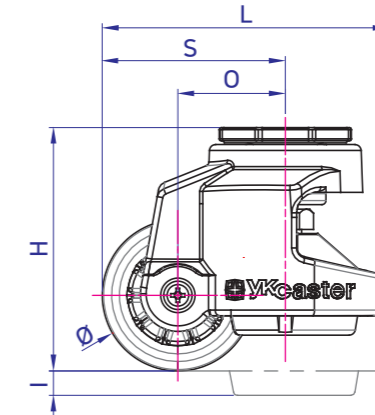
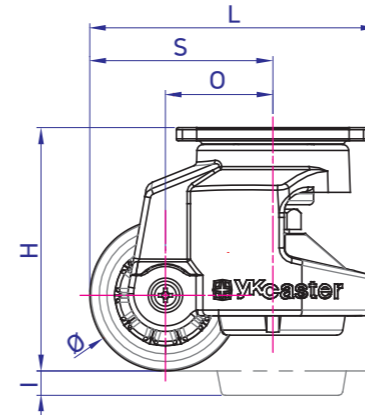

규격 DIMENSION

Code	자중 (Net weight)	Kg	Ø	W	HOLE			Tap (Order)	X	Y	H+H	L	S	O	
					F	F1	Hole								
YKCT-A120F	1.54	1.000	2.000	Ø75	30	95x95	70x70	Ø11	-	-	-	120+12	141	90	53
YKCT-A120S	1.55	-	-	-	-	-	-	M16	70	65	-	-	-	-	
YKCT-A150FM	3.34	1.500	3.000	Ø90	55	100x100	70x70	Ø13	-	-	-	132+15	174	113	68

컴팩트 이동형 YKCT-LGD 60. 75 SERIES

제품특징 FEATURES

- 중하중용 저상 캐스터로 손쉬운 이동과 360도 회전 기능 일체화
- Low-phase caster for heavy load integrates easy movement and 360 degree rotation.

적용범위 APPLICATION

- 알루미늄 프로파일 프레임, 반도체 장비, 의료 장비, 중하중 장비 및 운반 대차
- Aluminum profile frames, semiconductor equipment, medical equipment, heavy load equipment and transportation trucks.

모델설명 ORDERING CODE

YKCT - LGD 60 F/FB

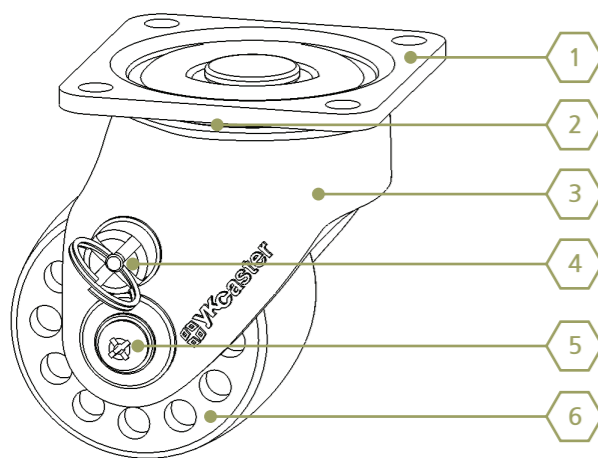
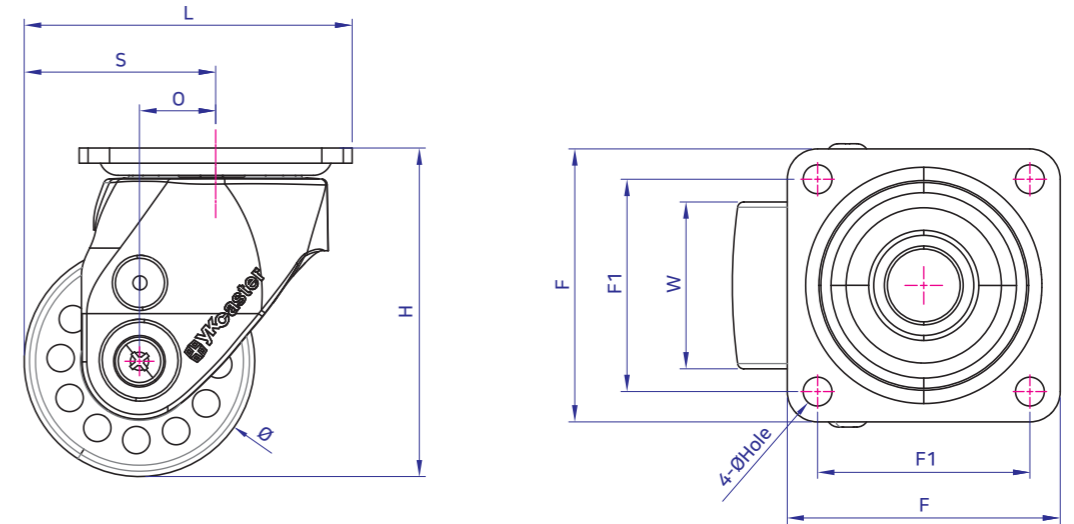
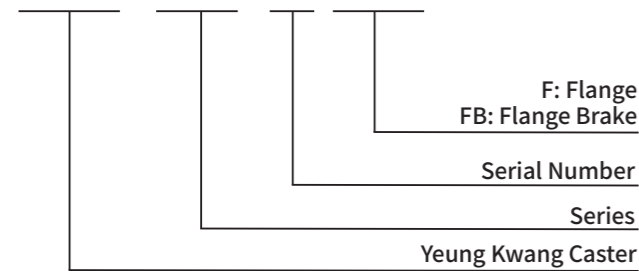

재질 MATERIAL & TREATMENT INFORMATION

No.	재질	표면처리	
1	Caster seat	SPC/SM45C	무전해 니켈도금
2	Ball	STB2	Ni-Cr
3	Body	ALDC12	Ivory / Power Coated
4	Brake(B)	S45C	무전해 니켈도금
5	Pin	S10C/SM45C	무전해 니켈도금
6	Wheel	EPP	Black

※ Option: Wheel: Antistatic Poly Urethane / Mc Nylon

규격 DIMENSION

Code	자중 (Net weight)	Kg		W		F		Hole	H	L	S	O
	kg	1EA	4EA	Ø	W	F	F1					
YKCT-LGD60F	0.78	550	1700	Ø60	55	90x90	70x70	Ø9.5	90	100	55	25
YKCT-LGD60FB2	0.92	550	1700	Ø60	55	90x90	70x70	Ø9.5	90	100	55	25
YKCT-LGD60FU	1	550	1700	Ø60	55	90x90	70x70	Ø9.5	90	100	55	25
YKCT-LGD75F	1.06	700	2100	Ø75	55	90x90	70x70	Ø9.5	108	108	63	25
YKCT-LGD75FB	1.2	700	2100	Ø75	55	90x90	70x70	Ø9.5	108	108	63	25
YKCT-LGD75FU	1.28	700	2100	Ø75	55	90x90	70x70	Ø9.5	108	108	63	25
YKCT-LGD75F-1	1.08	700	2100	Ø75	26x4	95x95	70x70	Ø11	106	106	61.5	25
YKCT-LGDT60F	0.92	550	1700	Ø50	26x2	90x90	70x70	Ø9.5	85	100	55	25
YKCT-LGDT60S	0.92	550	1700	Ø50	26x2	-	-	-	85	95	55	25
YKCT-LGDT75F	1.06	700	2100	Ø72	26x2	90x90	70x70	Ø9.5	106	108	63	25
YKCT-LGDT75S	1.06	700	2100	Ø72	26x2	-	-	-	106	101	63	25

컴팩트 이동형 (저상형) YKCT-JS SERIES

제품특징 FEATURES

- 무소음, 무유격, 회전력 극대화
- 장시간 하중에도 휠의 변형이 없으며 휠 커버 사용으로 오염이 적음.
- Noise-free, no gaps, maximum rotational power.
- No deformation of the wheel even with a long-term load, and less contaminated because of the wheel cover.

적용범위 APPLICATION

- 고하중 장비.
- 각종 고하중용 운반구.
- High load equipment.
- Various high load carriers.

모델설명 ORDERING CODE

YKCT - JS 60 RF/SF/SS

RF: Rigid Flange
SF: Swivel Flange
SS: Swivel Stem

Serial Number

Series

Yeung Kwang Caster

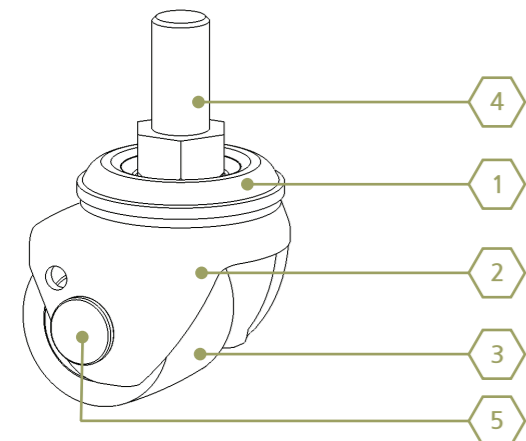
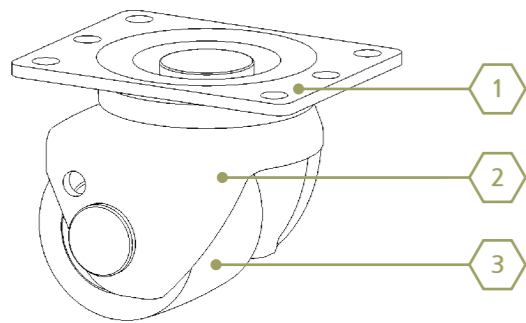

재질 MATERIAL & TREATMENT INFORMATION

No.	재질	표면처리
① Caster seat	SPC	무전해 니켈도금
② FRAME	SPC	무전해 니켈도금
③ Wheel	EPP	Black
④ Bolt	S45C	무전해 니켈도금
⑤ Pin	S45C	무전해 니켈도금

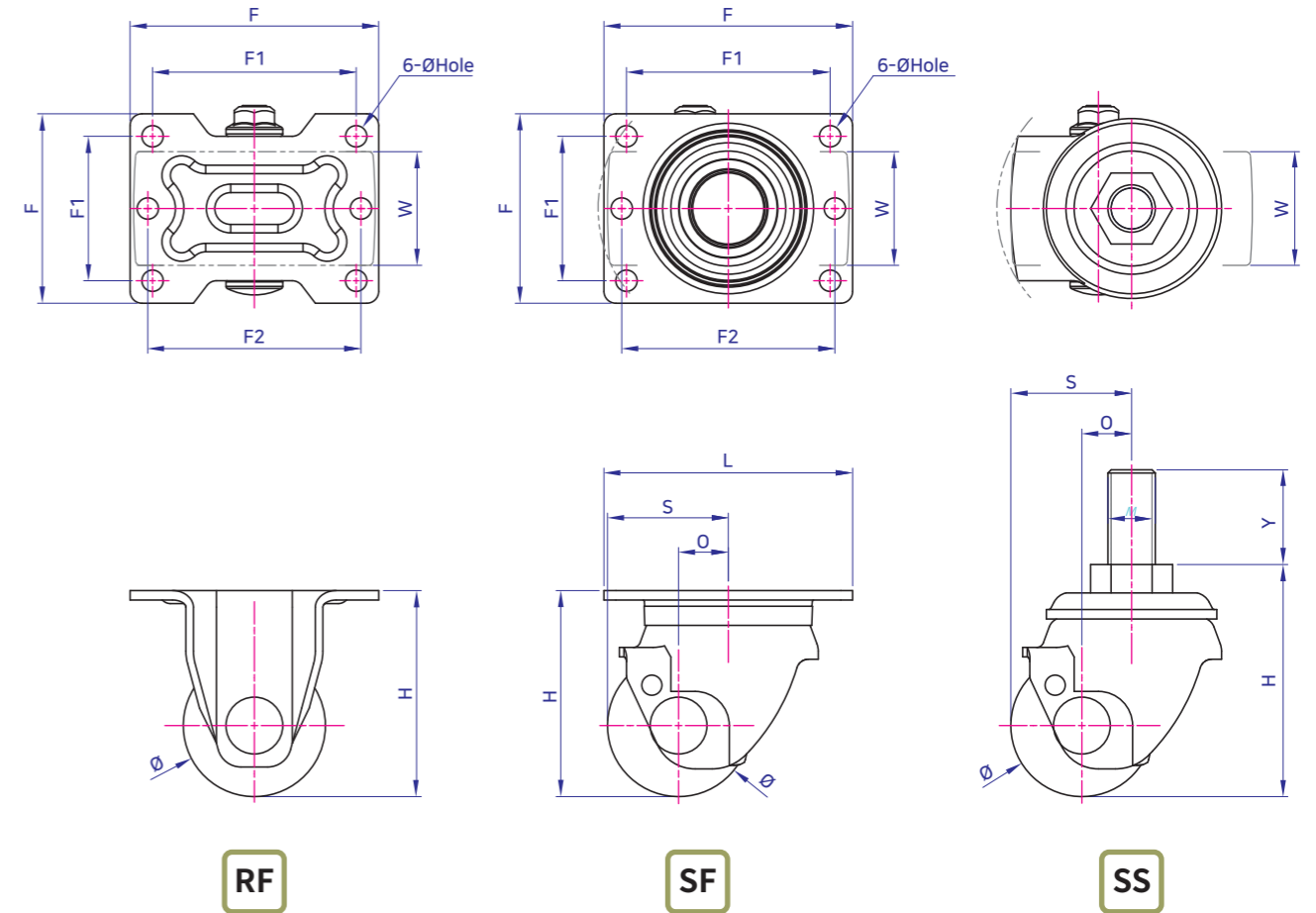

규격 DIMENSION

Code	자중 (Net weight) Kg	1EA	4EA	Ø	W	RF/SF				SS					
						F	F1	F2	Hole	H	L	S	O	M	Y
YKCT-JS60RFN	0.66	500	1500	Ø60	48	105×80	86×61	90	Ø9	87	105	-	-	-	-
YKCT-JS60SFN	1.1	500	1500			-	-	-	-	98	89	51	21	M20	40
YKCT-JS60SSN	1.2	500	1500	Ø70	48	105×80	86×61	90	Ø9	97	105	-	-	-	-
YKCT-JS70RFN	0.7	600	1800			-	-	-	-	108.5	56	21	-	-	-
YKCT-JS70SSN	1.3	600	1800			-	-	-	-	108	94	56	21	M20	40

기능성 이동 YKCT-MPH SERIES

제품특징 FEATURES

- 선회력이 우수하여 공전간 / 공장간 물류용으로 사용
- Excellent turning skills, using for logistics between process and factories.

적용범위 APPLICATION

- 공정간 / 공장간 이송용 대차
- 고하중용 장비
- 각종 중하중용 운반구
- Transportation truck between processes and factories
- High load equipment
- Various heavy load carriers.

모델설명 ORDERING CODE

YKCT - MPH 100 RF/SF/SFB

RF: Rigid Flange
SF: Swivel Flange
SFB: Swivel Flange Brake

Serial Number

Series

Yeung Kwang Caster

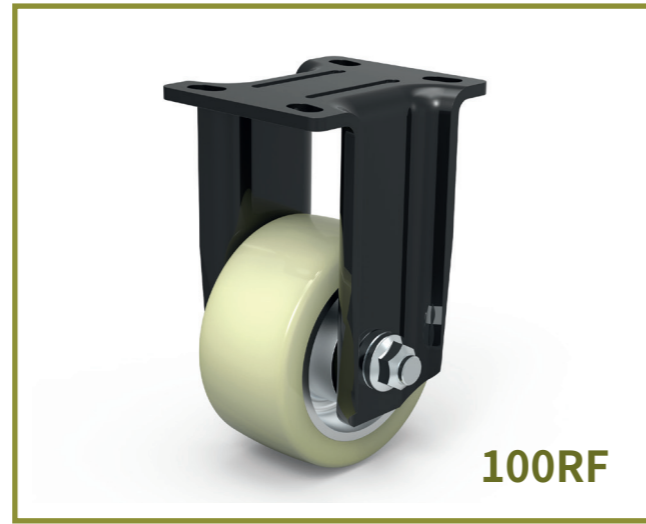

재질 MATERIAL & TREATMENT INFORMATION

No.	재질	표면처리
① Caster seat	SPC	Black Coated
② FRAME	SPC	Black Coated
③ Wheel	Poly Urethane+AL	무전해 니켈도금
④ Brake	ABS	무전해 니켈도금
⑤ Pin	45C	무전해 니켈도금

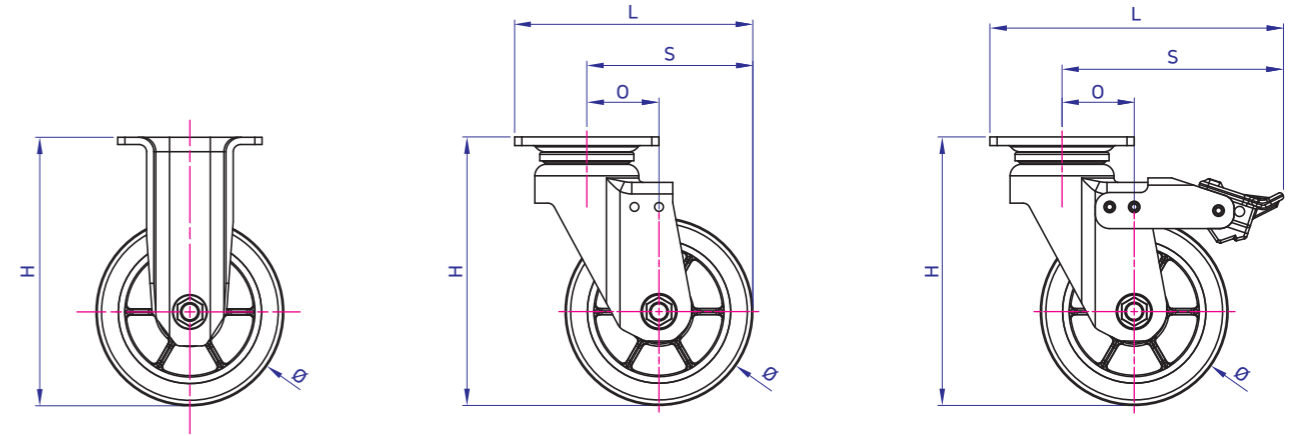
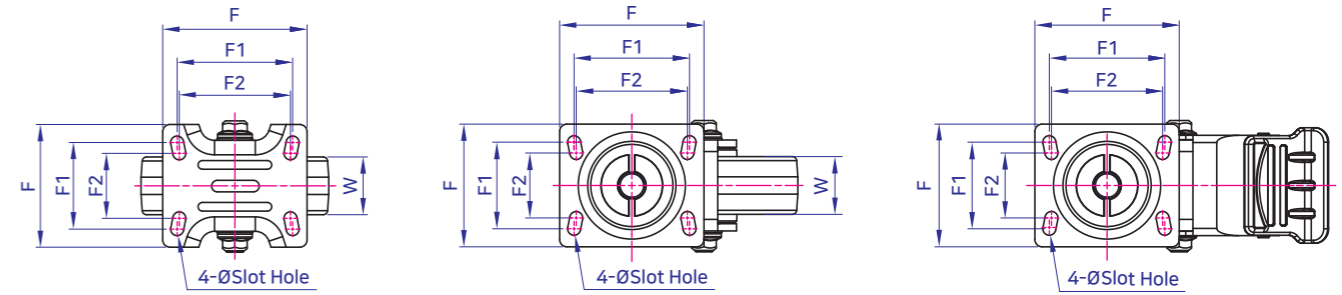
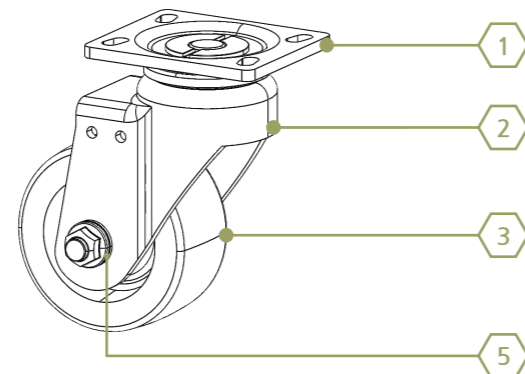
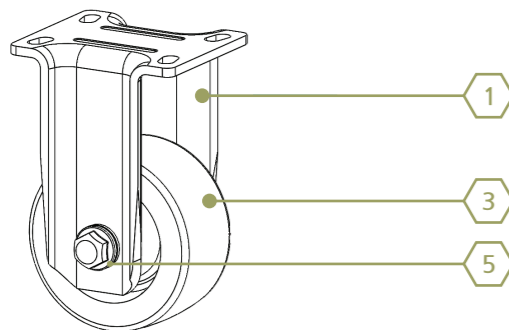
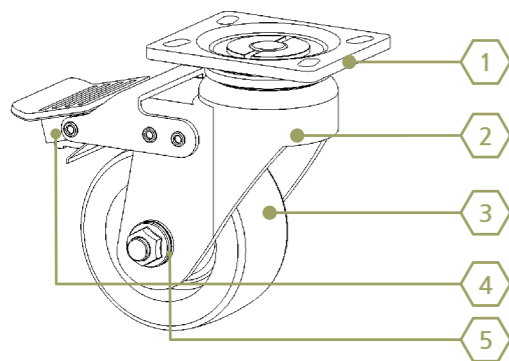

RF

SF

SFB

규격 DIMENSION

Code	자중 (Net weight) kg	Kg		a	w	Top View				H	Side View		
		1EA	4EA			Ø	W	F	F1		F2	Hole	L
YKCT-MPH100RFU	2.5										100	-	-
YKCT-MPH100SFU	2.5	300	900	Ø100	40	100×85	80×60	77×45	Ø9	157	150	100	50
YKCT-MPH100SFBU	2.85										186	153.4	50
YKCT-MPH130RFU	2.6										130	-	-
YKCT-MPH130SFU	2.6	320	960	Ø130	40	100×85	80×60	77×45	Ø9	186	165	115	50
YKCT-MPH130SFBU	3										203	153.4	50
YKCT-MPH150RFU	2.8										150	-	-
YKCT-MPH150SFU	2.8	350	1050	Ø150	40	100×85	80×60	77×45	Ø9	206	175	125	50
YKCT-MPH150SFBU	3.2										203	153.4	50

고하중용
YKCT-PH-80~100

제품특징 FEATURES

- 고하중에서도 안정적인 주행가능
- Run smoothly under hight duty

적용범위 APPLICATION

- 고하중용 장비, 클린룸장비
- 고하중용 대차, 각종 기계장비
- High duty equipment, Clean room equipment
- High duty carriage, various mechanical equipment

모델설명 ORDERING CODE

YKCT - PH80 RF/SF/SFB M/U

M: Mc Nylon
U: Urethane(A)
RF: Rigid Flange
SF: Swivel Flange
SFB: Swivel Flange Brake

Series

Yeung Kwang Caster



80SFM~100SFM



80SFU~100SFU

재질 MATERIAL & TREATMENT INFORMATION

No.	재질	표면처리
1	Caster seat	S45C Black Coated
2	Body	S45C Black Coated
3	Wheel	Poly Urethane+AL / Mc Nylon 무전해 니켈도금
4	Brake	TPE 무전해 니켈도금
5	Pin	45C 무전해 니켈도금

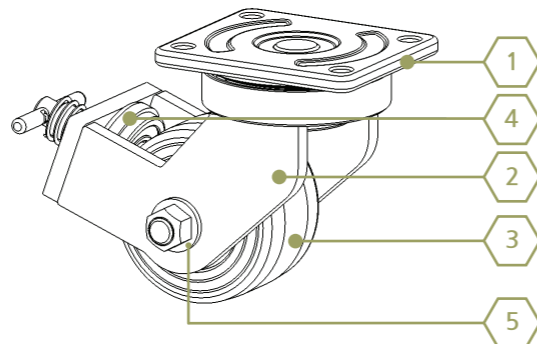
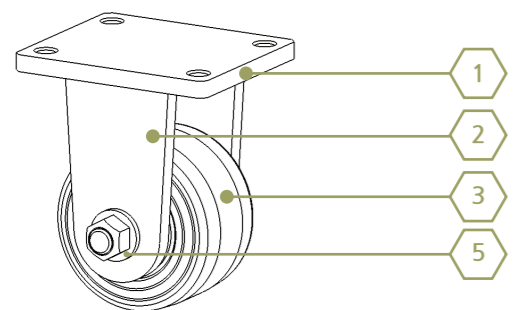
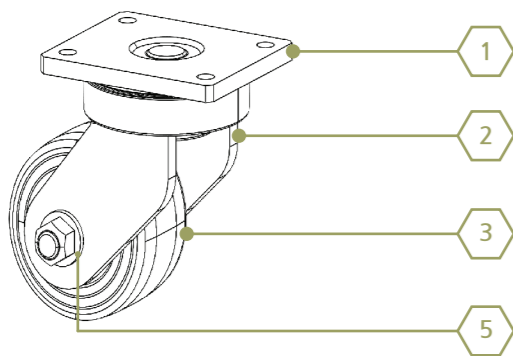

80SF-M

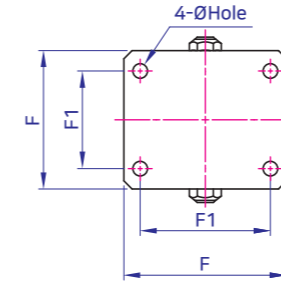

RF



80SFB-M

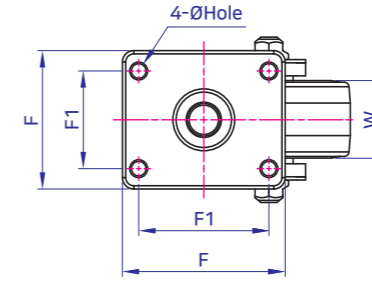

SF

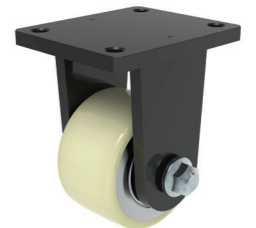

80RF-U

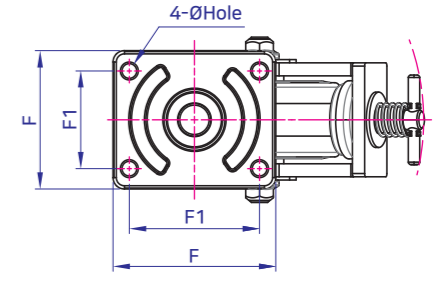

SFB

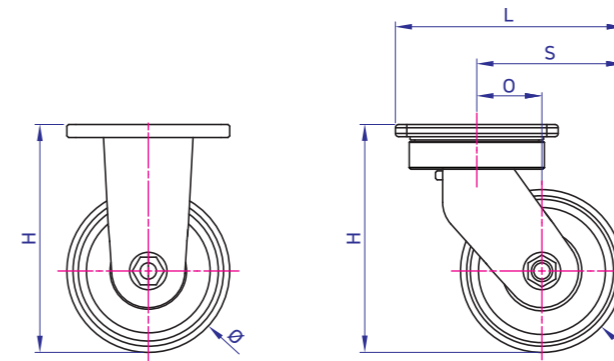

RF

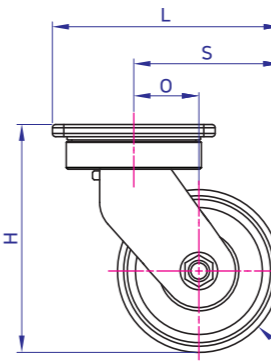

SF

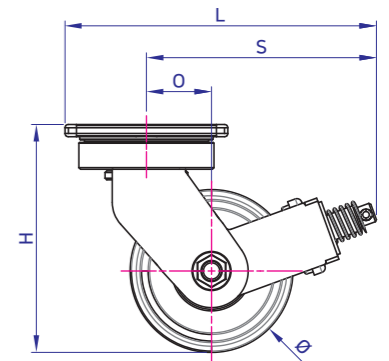

SFB

규격 DIMENSION

Code	자중 (Net weight) kg	Kg		Ø		F1		Hole	H	L	S	O
		1EA	4EA	W	F	F1						
YKCT-PH80RFU	1.9									100	-	-
YKCT-PH80SFU	2.6	500	1500							130	80	40
YKCT-PH80SFB	3.6									182	132	40
YKCT-PH80RFM	1.8			Ø80	48	100x85	80x60	Ø9	120	100	-	-
YKCT-PH80SFM	2.5	800	2400							130	80	40
YKCT-PH80SFBM	3.5									182	132	40
YKCT-PH100RFU	2.2									100	-	-
YKCT-PH100SFU	2.5	600	1800							140	90	40
YKCT-PH100SFB	3.9									192	141	40
YKCT-PH100RFM	2.1			Ø100	48	100x85	80x60	Ø9	140	100	-	-
YKCT-PH100SFM	2.7	900	2700							140	90	40
YKCT-PH100SFBM	3.7									192	141	40

고하중용
YKCT-PH-125~200

제품특징 FEATURES

- 고하중에서도 안정적인 주행가능
- Run smoothly under high duty

적용범위 APPLICATION

- 고하중용 장비, 클린룸장비
- 고하중용 대차, 각종 기계장비
- High duty equipment, Clean room equipment
- High duty carriage, various mechanical equipment

모델설명 ORDERING CODE

YKCT - PH125 RF/SF/SFB M/U

M: Mc Nylon
U: Urethane(A)
RF: Rigid Flange
SF: Swivel Flange
SFB: Swivel Flange Brake

Series
Yeung Kwang Caster



125SF- M



200SF-U

재질 MATERIAL & TREATMENT INFORMATION

No.	재질	표면처리
1	Caster seat	S45C Black Coated
2	Body	S45C Black Coated
3	Wheel	Poly Urethane+AL / Mc Nylon 무전해 니켈도금
4	Brake	TPE 무전해 니켈도금
5	Pin	45C 무전해 니켈도금

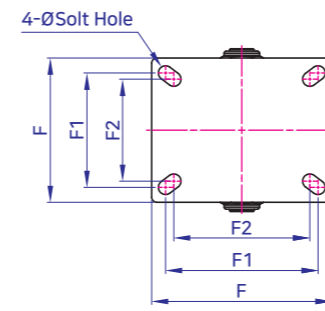
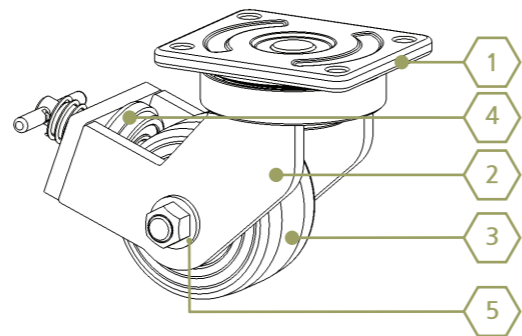
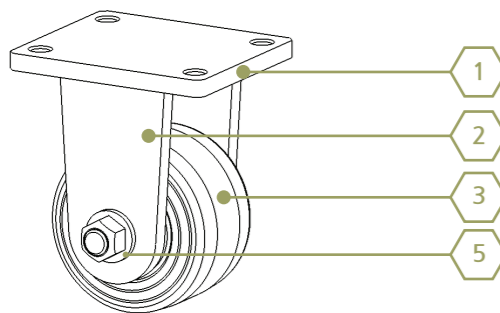
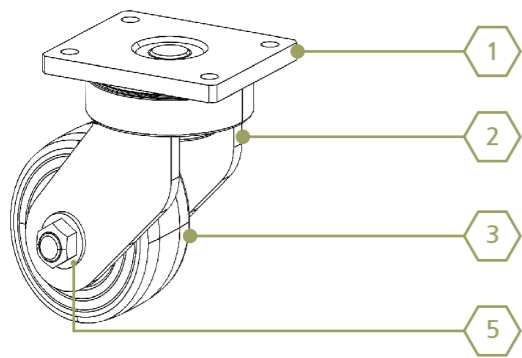

RF-M(U)

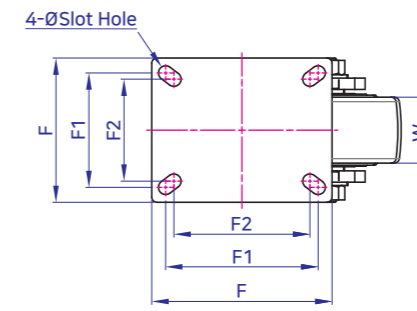

SF-M(U)

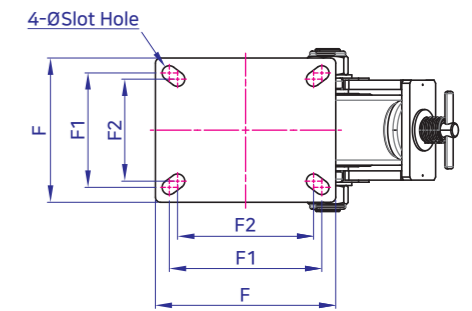

SFB-M(U)

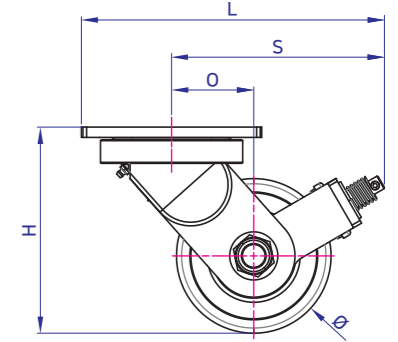
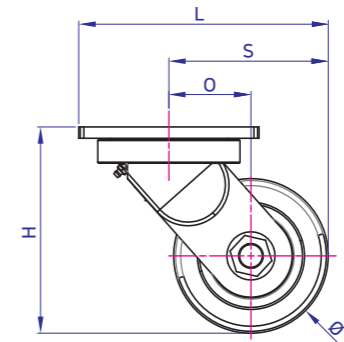
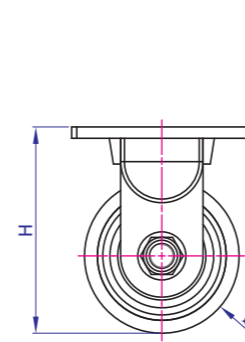

규격 DIMENSION

Code	자중 (Net weight) kg	Kg		Ø	W	F	F1	F2	Hole	H	L	S	O
		1EA	4EA										
YKCT-PH125RFU	6			Ø125	70	175x140	148x111	132x99	Ø14x24	170	175	-	-
YKCT-PH125SFU	9.5	1100	3300								227.5	140	77.5
YKCT-PH125SFBU	10.5										290	203	
YKCT-PH125RFM	5.5										175	-	-
YKCT-PH125SFM	9	1500	4500	Ø150	68	175x140	148x111	132x99	Ø14x24	224	227.5	140	77.5
YKCT-PH125SFBM	10										290	203	
YKCT-PH150RFU	7										175	-	-
YKCT-PH150SFU	8.7	1500	4500								210.5	155	48
YKCT-PH150SFBU	9.7			267	207								
YKCT-PH150RFM	6.1			Ø200	70	175x140	148x111	132x99	Ø14x24	200	175	-	-
YKCT-PH150SFM	9.6	2200	6600								242.5	155	80
YKCT-PH150SFBM	10.6										294	207	
YKCT-PH200RFU	9.6										200	-	-
YKCT-PH200SFU	13.1	2000	6000	Ø200	68	175x140	148x111	132x99	Ø14x24	275	247.5	175	60
YKCT-PH200SFBU	14.1										296	224	
YKCT-PH200RFM	7.5										200	-	-
YKCT-PH200SFM	11	2500	7500								262.5	175	75
YKCT-PH200SFBM	12			311	224								